



MONTGOMERY COUNTY EXECUTIVE ORDER

Offices of the County Executive • 101 Monroe Street • Rockville, Maryland 20850

Subject Fire Lane Establishment Order Clarksburg Elementary School	Executive Order No. 192-22	Subject Suffix
Originating Department Montgomery County Department of Permitting Services	Department Number MCDPS 20-22	Effective Date 6/30/2022

Fire Lane Establishment Order

Pursuant to Section 22 - 33, Montgomery County Code, 1971, as amended, you are hereby notified that a Fire Lane has been established as described in this order. You are hereby ordered to post fire lane signs and paint curbs/pavement (painting optional) as identified below. When signs and paint work (painting optional) have been completed, this order will authorize the enforcement of this Fire Lane by appropriate police and fire officials. Compliance with this order must be achieved within 30 days of receipt.

LOCATION: 13530 Redgrave Pl.

All areas where indicated by signs and paint.

- SIGNS - - (See attached diagram for location of sign placement)



\$250 FINE

FIRE LANE

Signs must be posted so that it is not possible to park a vehicle without being in sight of a sign. Signs may be no further apart than 100 feet

(Red letters on white background)

- PAINT - - (See attached diagram if painting).

Paint must be traffic yellow with lines of sufficient width to be readily identifiable/readable by motor vehicle operators.

Richard E Merck

Fire Marshal, Montgomery County Department of Permitting Services



MONTGOMERY COUNTY FIRE AND RESCUE SERVICE

Date: 6/21/2022

Fire Lane Establishment Order

Pursuant to Section 22-33, Montgomery County Code, 1971, as amended, you are hereby notified that a Fire Lane has been established as described in this order. You are hereby ordered to post fire lane signs and paint curbs/pavement as identified below. When signs or paint work has been completed, this order will authorize the enforcement of this Fire Lane by appropriate police or fire officials. Compliance with this order must be achieved within 30 days of receipt when any of the following conditions are met:

- One or more structures addressed from the subject road are occupied;
- The road or accessway is available for use and at least one building permit for an address on the subject road has been issued; or
- The road or accessway is necessary fire department access.

LOCATION: Clarksburg Elementary School
13530 Redgrave Place, Clarksburg, MD 20871

Delineate all areas where indicated by signs and/or paint.

SIGNS -- (See attached diagram for location of sign placement)



(Red letters on white background)

Signs must be posted so that it is not possible to park a vehicle without being in sight of a sign. Signs may be no further apart than 100 feet.

PAINT -- (See attached diagram when painting is required)

Paint must be traffic yellow with lines of sufficient width to be readily identifiable/readable by motor vehicle operators.

LS1189

Signature of Order Writer/I.D. #

June 30, 2022

Cc: Fire Code Enforcement Section
Attachment: Fire Lane Diagram

FIRE LANE ESTABLISHMENT FORM

BUILDING OR SUBDIVISION NAME: Clarksburg Elementary School

FIRE LANE LOCATION/ADDRESS: 13530 Redgrave Place, Clarksburg, MD 20871

See attached drawing for designated fire lanes:

I have received the drawing and instructions for installing the designated fire lanes on property not owned by state or local government.

NAME AND TITLE OF PROPERTY REPRESENTATIVE

NAME: Gary Mosesman TITLE: Director of Division of Design & Construction

SIGNATURE: 

PHONE: (240) 314-1000 DATE: 6/21/22

ADDRESS (where processed order will be mailed):
Montgomery County Public Schools - Division of Construction
c/o Michael R. Sanchez, P.E.
45 West Gude Drive, Suite 4300, Rockville, Maryland 20850

The designated fire lanes are the minimum necessary for fire/rescue access and are in accordance with Section 22-33 of the Fire Safety Code.

NAME: Marie LaBaw SIGNATURE: 

STA.#: DPS I.D.#: LS1189 DATE: June 30, 2022

Comments: _____

Fire Lane Installed Per Order

NAME: _____ DATE: _____

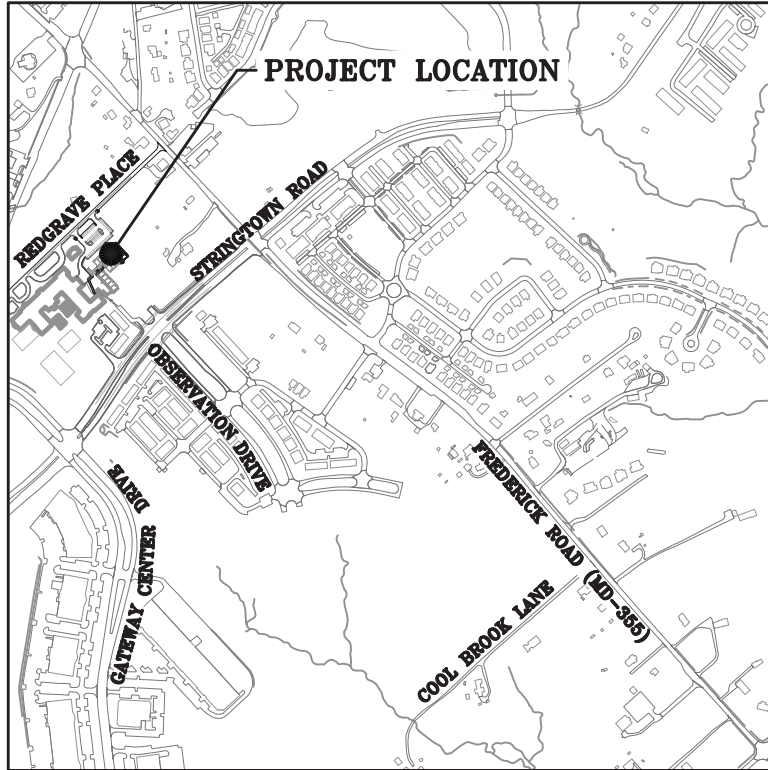

VICINITY MAP
SCALE: 1" = 1000'

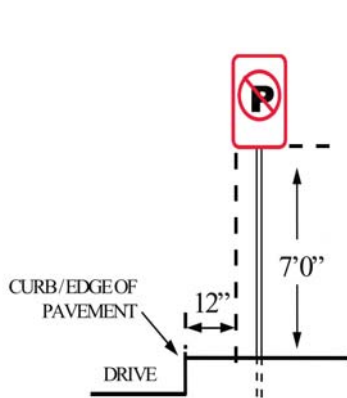

SIGN PLACEMENT DIAGRAM



FIRE LANE SIGNS

GENERAL NOTES:

1. SIGNS TO BE CONSISTENT WITH THE MONTGOMERY COUNTY FIRE AND RESCUE (MCFR) GUIDELINES
2. FIRE LANE SIGNS TO BE 12" WIDE BY 18" HIGH

CLARK | AZAR & ASSOCIATES
 20440 Century Blvd, Suite 220
 Germantown, MD. 20874
 T(301) 528-2010
 www.clarkazar.com
 A Woman Owned Small Business

CLASSROOM PORTABLES
CLARKSBURG ELEMENTARY SCHOOL
 13530 REDGRAVE PLACE
 CLARKSBURG, MD 20871
 FIRE LANE ORDER DETAILS

JOB NO.: 200.105

SCALE: 1" = 1000'

DATE: JUNE 2022

SHEET NUMBER:

1 OF 3

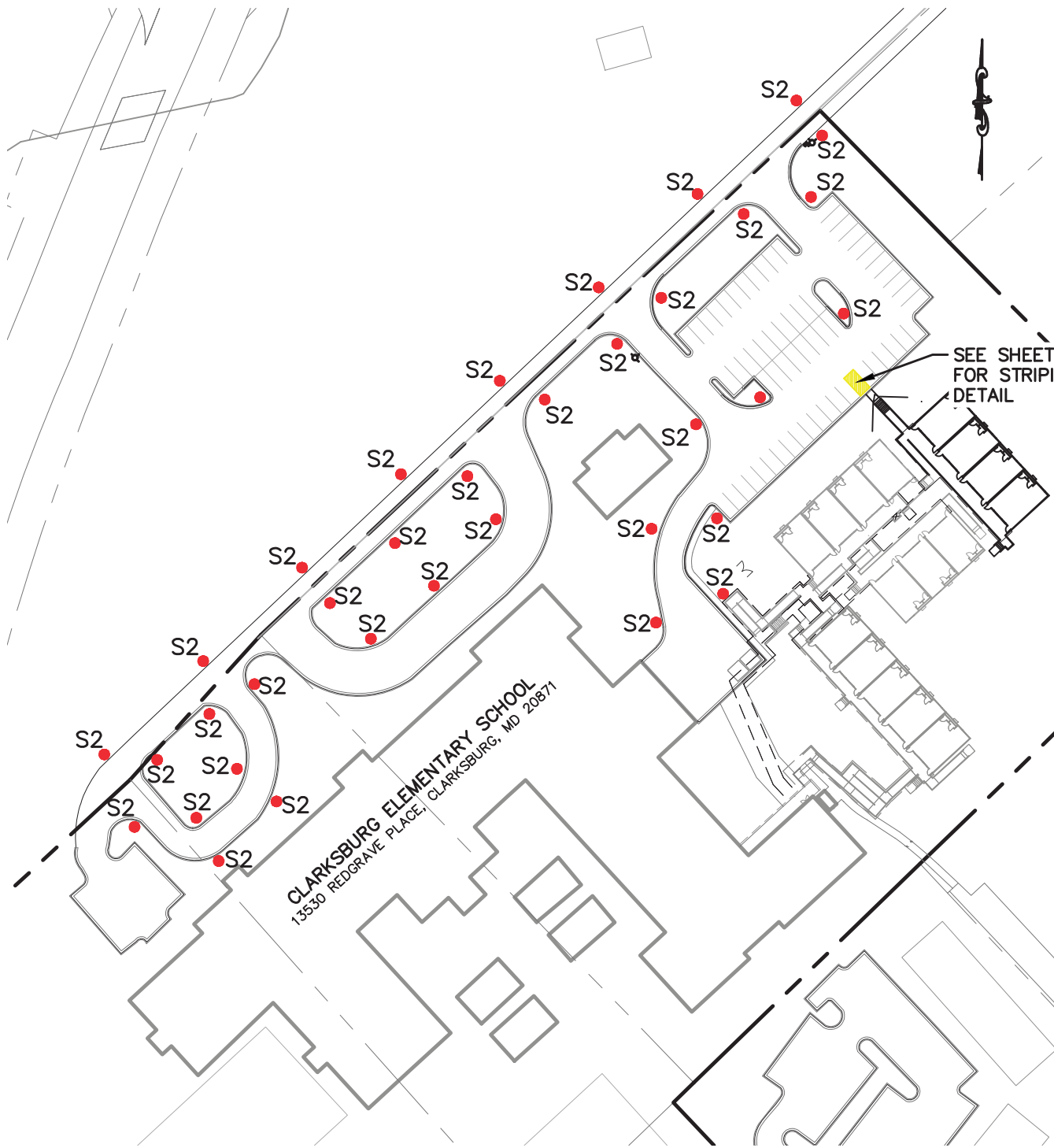

CLARKSBURG ELEMENTARY SCHOOL
 13530 REDGRAVE PLACE, CLARKSBURG, MD 20871

SEE SHEET 3
 FOR STRIPING
 DETAIL

LEGEND
 ● FIRE LANE SIGN (TYP.)



CLARK | AZAR & ASSOCIATES
 20440 Century Blvd, Suite 220
 Germantown, MD. 20874
 T(301) 528-2010
 www.clarkazar.com
 A Woman Owned Small Business

CLASSROOM PORTABLES
 CLARKSBURG ELEMENTARY SCHOOL
 13530 REDGRAVE PLACE
 CLARKSBURG, MD 20871
 FIRE LANE ORDER DETAILS

JOB NO.: 200.105
 SCALE: 1" = 100'

DATE: JUNE 2022

SHEET NUMBER:
 2 OF 3

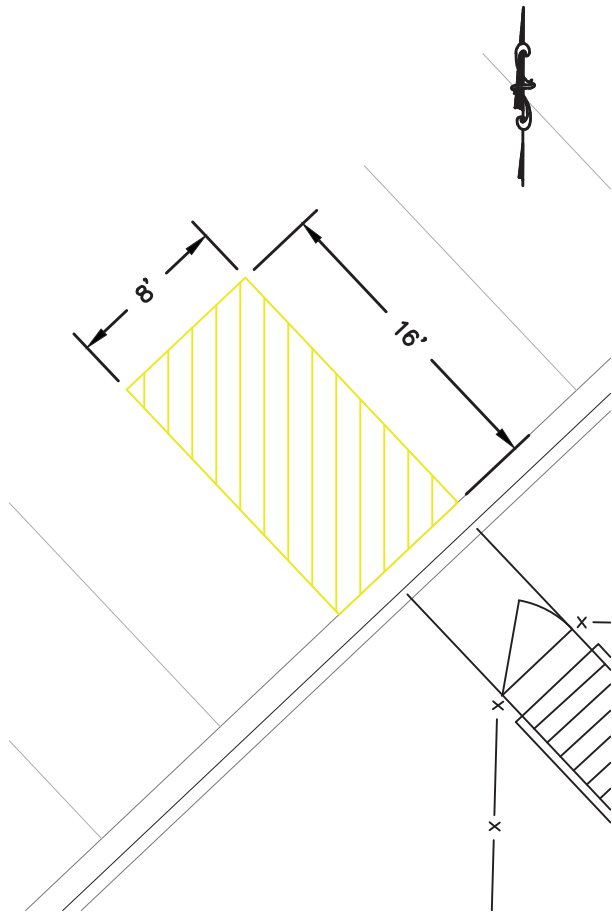

FIRE LANE STRIPING PLAN
SCALE: 1"=10'

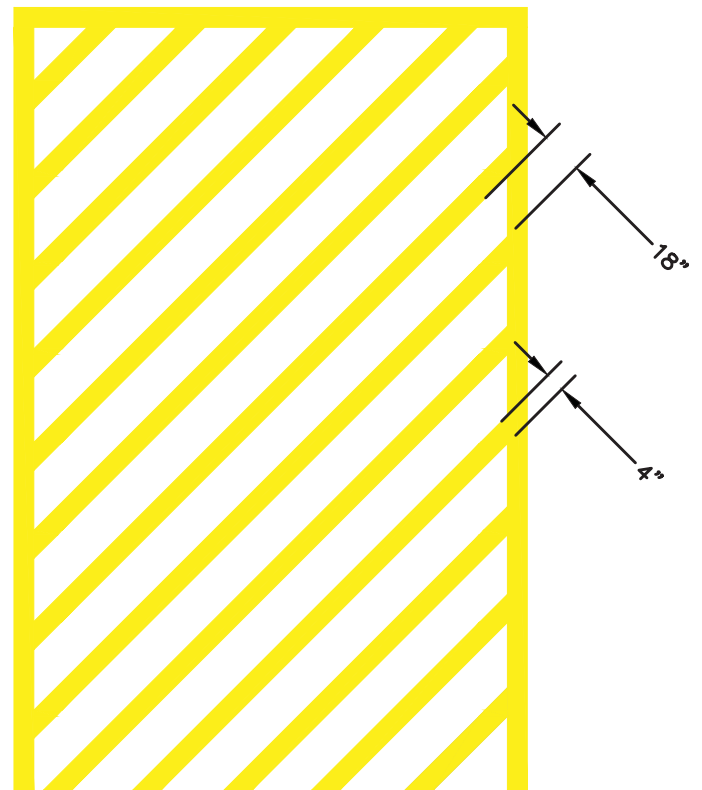

YELLOW, 4" WIDTH, 18" SPACING, 45 DEGREE ANGLE

FIRE LANE STRIPING DETAIL
N.T.S.