



# MONTGOMERY COUNTY EXECUTIVE ORDER

Offices of the County Executive • 101 Monroe Street • Rockville, Maryland 20850

Subject Fire Lane Establishment Order for The Home Depot	Executive Order No. 199-13	Subject Suffix
Originating Department Montgomery County Fire and Rescue Service	Department Number MCFRS 31-13	Effective Date 11/13/2013

### Fire Lane Establishment Order

Pursuant to Section 22 - 33, Montgomery County Code, 1971, as amended, you are hereby notified that a Fire Lane has been established as described in this order. You are hereby ordered to post fire lane signs and paint curbs/pavement (painting optional) as identified below. When signs and paint work (painting optional) have been completed, this order will authorize the enforcement of this Fire Lane by appropriate police and fire officials. Compliance with this order must be achieved within 30 days of receipt.

LOCATION: Centra Care Middlebrook  
19825 Frederick Rd.

All areas where indicated by signs and paint.

- SIGNS - - (See attached diagram for location of sign placement)



\$250 FINE

FIRE LANE

Signs must be posted so that it is not possible to park a vehicle without being in sight of a sign. Signs may be no further apart than 100 feet

(Red letters on white background)





- PAINT - - (See attached diagram if painting).

Paint must be traffic yellow with lines of sufficient width to be readily identifiable/readable by motor vehicle operators.

Fire Chief, Montgomery County Fire and Rescue Service

The original of this drawing document was prepared by Soltesz, Inc. (SOLTESZ). If this document was not obtained directly from SOLTESZ and/or it was transmitted electronically, SOLTESZ cannot guarantee that unauthorized changes and / or alterations were not made by others. If verification of the information contained hereon is needed, contact should be made directly with SOLTESZ. SOLTESZ makes no warranties, express or implied, concerning the accuracy of any information that has been transmitted by electronic means.

**LEGEND**

-  FIRE ACCESS LANE
-  PROPOSED FIRE HYDRANT
-  PROPOSED FIRE LANE SIGNS
-  FIRE LANE STRIPING



FIRE LANE - NO PARKING SIGNS



FREDERICK ROAD

MIDDLEBROOK ROAD

PROPOSED  
URGENT CARE  
FACILITY  
(5,300 SF)



**SOLTESZ**  
2 Research Place, Suite 100  
Rockville, MD 20850  
P.301.948.2750 F.301.948.9067  
www.solteszco.com

FIRE LANE SIGNAGE PLAN  
**CENTRA CARE MIDDLEBROOK**  
19825 FREDERICK ROAD, GERMANTOWN, MD  
MONTGOMERY COUNTY, MARYLAND

JOB NO. 1968-0000

SCALE: 1" = 50'

DATE OCT 2013

Q:\1967000\ENGINEER\PAVSTORM\Fire Access\Fire Lane\Fire LaneOrder\_1.shx Scale=50.0000 ft. in. User=Scott PL.Tar=PDF\_Grey\_150.plt.cplg Penrib=TEXT\_SUB.tbl 11/6/2013 9:41:26 AM

The original of this drawing document was prepared by Soltesz, Inc. (SOLTESZ). If this document was not obtained directly from SOLTESZ and/or it was transmitted electronically, SOLTESZ cannot guarantee that unauthorized changes and / or alterations were not made by others. If verification of the information contained hereon is needed, contact should be made directly with SOLTESZ. SOLTESZ makes no warranties, express or implied, concerning the accuracy of any information that has been transmitted by electronic means.

**LEGEND**

-  FIRE ACCESS LANE
-  PROPOSED FIRE HYDRANT
-  PROPOSED FIRE LANE SIGNS
-  FIRE LANE STRIPING



FIRE LANE - NO PARKING SIGNS

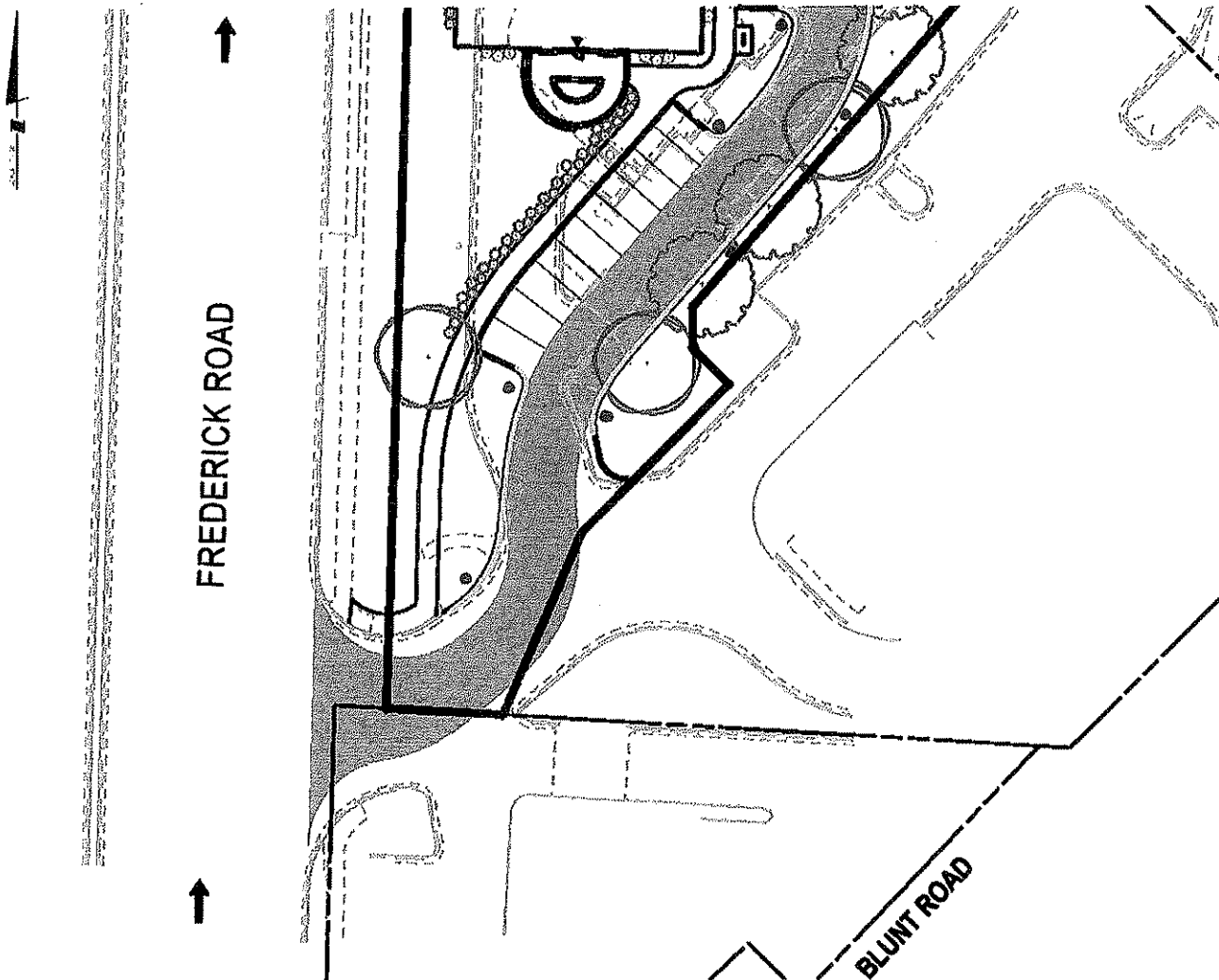

**SOLTESZ**  
 2 Research Place, Suite 100  
 Rockville, MD 20850  
 P.301.948.2750 F.301.948.9067  
 www.solteszco.com

FIRE LANE SIGNAGE PLAN  
**CENTRA CARE MIDDLEBROOK**  
 19825 FREDERICK ROAD, GERMANTOWN, MD  
 MONTGOMERY COUNTY, MARYLAND

JOB NO. 1968-0000

SCALE 1" = 50'

DATE OCT 2013

Q:\11997000\ENGINEER\PAVSTORM\Fire Access\Fire LaneOrder\_2.sht Scale=50.0000 ft./in. User=pScott PLTdv=PDF\_Grey\_150.pltcdg PenTable=TEXT\_SUB.tbl 11/6/2013 9:39:32 AM