



MONTGOMERY COUNTY EXECUTIVE ORDER

Offices of the County Executive • 101 Monroe Street • Rockville, Maryland 20850

Subject Fire Lane Establishment Order King Farm – Five Irvington Center	Executive Order No. 199 -22	Subject Suffix
Originating Department Montgomery County Department of Permitting Services	Department Number MCDPS 23-22	Effective Date 8/8/2022

Fire Lane Establishment Order

Pursuant to Section 22 - 33, Montgomery County Code, 1971, as amended, you are hereby notified that a Fire Lane has been established as described in this order. You are hereby ordered to post fire lane signs and paint curbs/pavement (painting optional) as identified below. When signs and paint work (painting optional) have been completed, this order will authorize the enforcement of this Fire Lane by appropriate police and fire officials. Compliance with this order must be achieved within 30 days of receipt.

LOCATION: 504 – 591 Shorthorn Way

All areas where indicated by signs and paint.

- SIGNS - - (See attached diagram for location of sign placement)



\$250 FINE

FIRE LANE

Signs must be posted so that it is not possible to park a vehicle without being in sight of a sign. Signs may be no further apart than 100 feet

(Red letters on white background)

- PAINT - - (See attached diagram if painting).

Paint must be traffic yellow with lines of sufficient width to be readily identifiable/readable by motor vehicle operators.

Richard E Merck

Fire Marshal, Montgomery County Department of Permitting Services



MONTGOMERY COUNTY FIRE AND RESCUE SERVICE

Date: 3-22-22

Fire Lane Establishment Order

Pursuant to Section 22-33, Montgomery County Code, 1971, as amended, you are hereby notified that a Fire Lane has been established as described in this order. You are hereby ordered to post fire lane signs and paint curbs/pavement as identified below. When signs or paint work has been completed, this order will authorize the enforcement of this Fire Lane by appropriate police or fire officials. Compliance with this order must be achieved within 30 days of receipt when any of the following conditions are met:

- One or more structures addressed from the subject road are occupied;
• The road or accessway is available for use and at least one building permit for an address on the subject road has been issued; or
• The road or accessway is necessary fire department access.

LOCATION: 504-591 SHORTHORN WAY (ALLEY A)

Delineate all areas where indicated by signs and/or paint.

SIGNS -- (See attached diagram for location of sign placement)



(Red letters on white background)

Signs must be posted so that it is not possible to park a vehicle without being in sight of a sign. Signs may be no further apart than 100 feet.

PAINT -- (See attached diagram when painting is required)

Paint must be traffic yellow with lines of sufficient width to be readily identifiable/readable by motor vehicle operators.

Handwritten signature and FM2

Signature of Order Writer/I.D. #

Cc: Fire Code Enforcement Section
Attachment: Fire Lane Diagram

FIRE LANE ESTABLISHMENT FORM

BUILDING OR SUBDIVISION NAME: KING FARM - FIVE IRVINGTON CENTER

FIRE LANE LOCATION/ADDRESS: 504-591 SHORTHORN WAY
(ALLEY A)

See attached drawing for designated fire lanes:

I have received the drawing and instructions for installing the designated fire lanes on property not owned by state or local government.

NAME AND TITLE OF PROPERTY REPRESENTATIVE

NAME: Barry Jackson TITLE: PRESIDENT, KFCA

SIGNATURE: [Signature]

PHONE: 301-987-0122 DATE: 4/4/2022

ADDRESS (where processed order will be mailed):

The designated fire lanes are the minimum necessary for fire/rescue access and are in accordance with Section 22-33 of the Fire Safety Code.

NAME: Walter Balma SIGNATURE: [Signature] FM 2

STA.#: _____ I.D.#: FM 2 DATE: 8/3/2022

Comments: _____

Fire Lane Installed Per Order

NAME: _____ DATE: _____

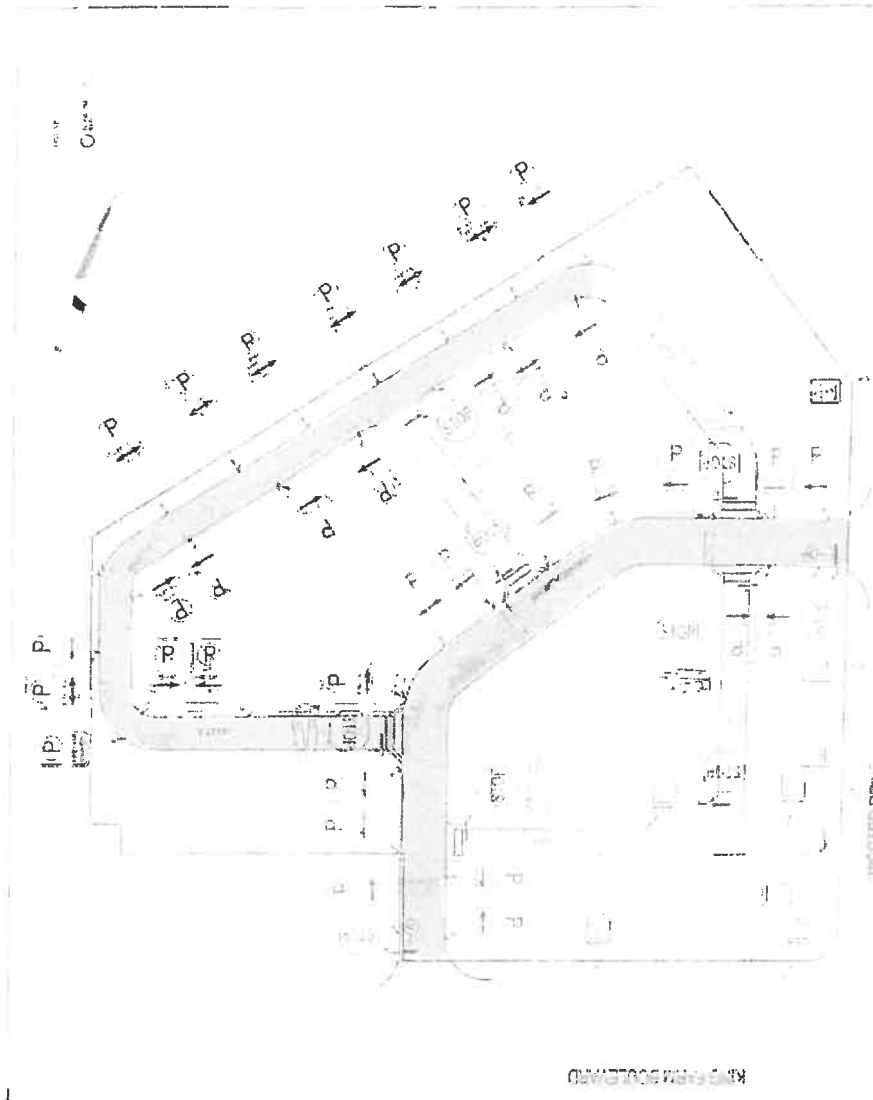

APPROVED FOR RECORD SUBMITTANCE
 CITY OF ROCKVILLE, MD
 DATE: 12/15/2017
 FILE NO: 2017-00000

APPROVED FOR RECORD SUBMITTANCE
 COUNTY OF ROCKVILLE, MARYLAND
 DATE: 12/15/2017
 FILE NO: 2017-00000

ROCKVILLE
 ROCKVILLE
 ROCKVILLE