



# MONTGOMERY COUNTY EXECUTIVE ORDER

Offices of the County Executive • 101 Monroe Street • Rockville, Maryland 20850

Subject Fire Lane Establishment Order for The Heights School	Executive Order No. 203-14	Subject Suffix
Originating Department Montgomery County Fire and Rescue Service	Department Number MCFRS 45-14	Effective Date 11/17/2014

### Fire Lane Establishment Order

Pursuant to Section 22 - 33, Montgomery County Code, 1971, as amended, you are hereby notified that a Fire Lane has been established as described in this order. You are hereby ordered to post fire lane signs and paint curbs/pavement (painting optional) as identified below. When signs and paint work (painting optional) have been completed, this order will authorize the enforcement of this Fire Lane by appropriate police and fire officials. Compliance with this order must be achieved within 30 days of receipt.

LOCATION: 10400 Seven Locks Rd.  
\_\_\_\_\_  
\_\_\_\_\_

All areas where indicated by signs and paint.

SIGNS - - (See attached diagram for location of sign placement)



\$250 FINE

FIRE LANE

Signs must be posted so that it is not possible to park a vehicle without being in sight of a sign. Signs may be no further apart than 100 feet

(Red letters on white background)

PAINT - - (See attached diagram if painting).

Paint must be traffic yellow with lines of sufficient width to be readily identifiable/readable by motor vehicle operators.

\_\_\_\_\_  
Fire Chief, Montgomery County Fire and Rescue Service

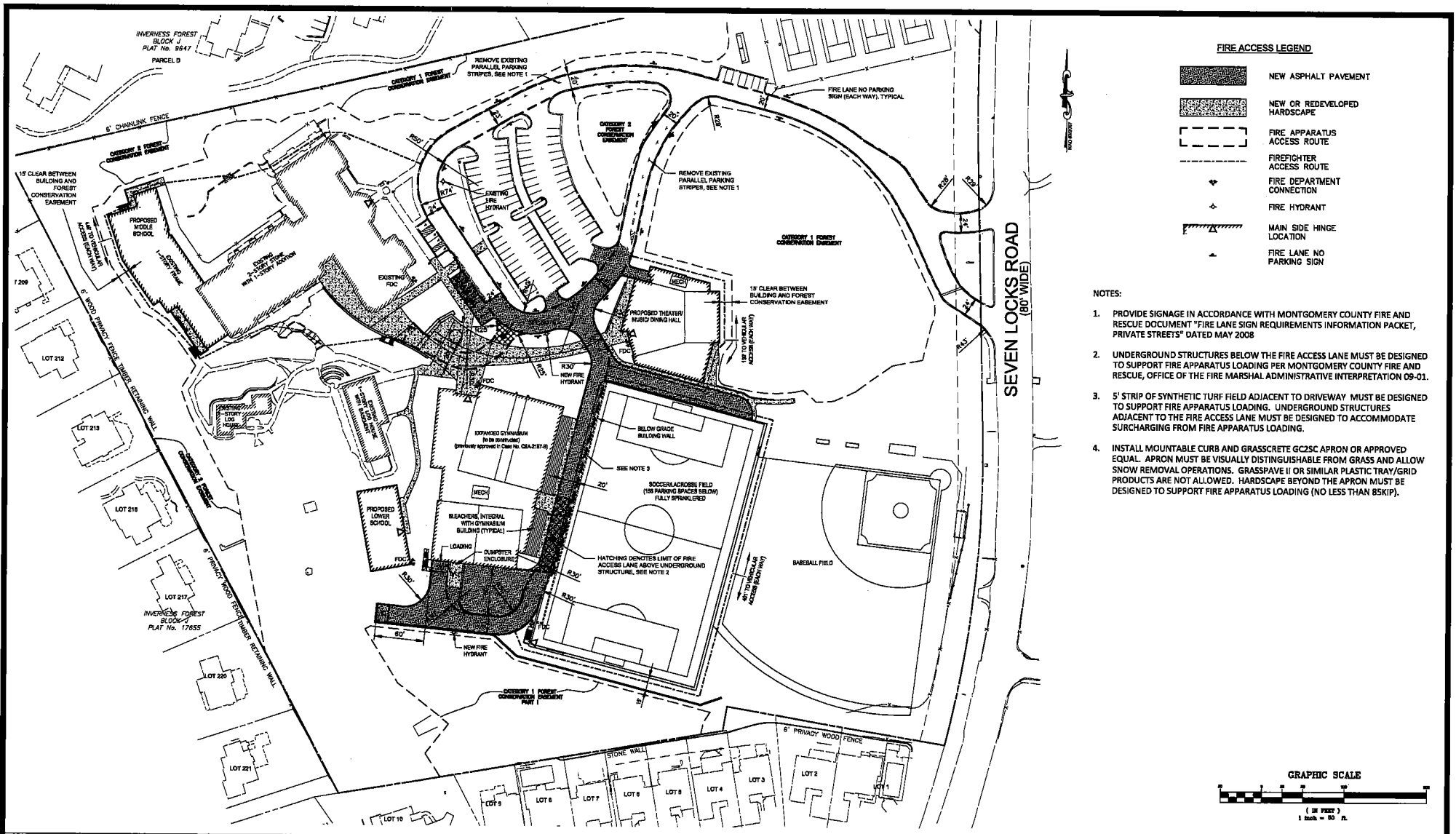

**FIRE ACCESS LEGEND**

	NEW ASPHALT PAVEMENT
	NEW OR REDEVELOPED HARDSCAPE
	FIRE APPARATUS ACCESS ROUTE
	FIRE FIGHTER ACCESS ROUTE
	FIRE DEPARTMENT CONNECTION
	FIRE HYDRANT
	MAIN SIDE HINGE LOCATION
	FIRE LANE NO PARKING SIGN

- NOTES:**
1. PROVIDE SIGNAGE IN ACCORDANCE WITH MONTGOMERY COUNTY FIRE AND RESCUE DOCUMENT "FIRE LANE SIGN REQUIREMENTS INFORMATION PACKET, PRIVATE STREETS" DATED MAY 2008
  2. UNDERGROUND STRUCTURES BELOW THE FIRE ACCESS LANE MUST BE DESIGNED TO SUPPORT FIRE APPARATUS LOADING PER MONTGOMERY COUNTY FIRE AND RESCUE, OFFICE OF THE FIRE MARSHAL ADMINISTRATIVE INTERPRETATION 09-01.
  3. 5' STRIP OF SYNTHETIC TURF FIELD ADJACENT TO DRIVEWAY MUST BE DESIGNED TO SUPPORT FIRE APPARATUS LOADING. UNDERGROUND STRUCTURES ADJACENT TO THE FIRE ACCESS LANE MUST BE DESIGNED TO ACCOMMODATE SURCHARGING FROM FIRE APPARATUS LOADING.
  4. INSTALL MOUNTABLE CURB AND GRASSCRETE GC23C APRON OR APPROVED EQUAL. APRON MUST BE VISUALLY DISTINGUISHABLE FROM GRASS AND ALLOW SNOW REMOVAL OPERATIONS. GRASSPAVE II OR SIMILAR PLASTIC TRAY/GRID PRODUCTS ARE NOT ALLOWED. HARDSCAPE BEYOND THE APRON MUST BE DESIGNED TO SUPPORT FIRE APPARATUS LOADING (NO LESS THAN 85KIP).

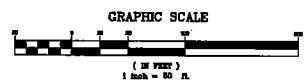

**FIRE ACCESS EXHIBIT**  
**THE HEIGHTS SCHOOL**  
**10400 SEVEN LOCKS ROAD, POTOMAC, MD**

**A.MORTON THOMAS AND ASSOCIATES, INC.**

**JULY 25, 2013**  
**SCALE: 1"=50'**

INVERNESS FOREST  
BLOCK J  
PLAT No. 9647  
PARCEL D

REMOVE EXISTING  
PARALLEL PARKING  
STRIPES, SEE NOTE 1

CATEGORY 1 FOREST  
CONSERVATION EASEMENT

6' CHAINLINK FENCE

15' CLEAR BETWEEN  
BUILDING AND  
FOREST  
CONSERVATION  
EASEMENT

PROPOSED  
MIDDLE  
SCHOOL

1-  
STORY FRAME

EXISTING STONE  
2-STORY  
WITH  
1-STORY ADDITION

EXISTING  
FDC

EXISTING  
FIRE  
HYDRANT

ACCESS TO VEHICULAR  
ACCESS (EACH WAY)

6' WOOD PRIVACY FENCE  
CATEGORY 1 FOREST  
CONSERVATION EASEMENT

LOT 212

LOT 213

LOT 216

LOT 217

INVERNESS FOREST  
BLOCK J  
PLAT No. 17655

LOT 220

LOT 221

EXISTING  
1-  
STORY LOG  
HOUSE

EXISTING  
HOUSE  
WITH  
1-  
STORY L.C. BASEMENT

PROPOSED  
LOWER  
SCHOOL

EXPANDED GYMNASIUM  
(to be constructed)  
(previously approved in Case No. CBA-2197-B)

MECH

BLEACHERS, INTEGRAL  
WITH GYMNASIUM  
BUILDING (TYPICAL)

LOADING

DUMPSTER  
ENCLOSURE

NEW FIRE  
HYDRANT

SEE NOTE 4

CATEGORY 1 FOREST  
CONSERVATION EASEMENT

LOT 9

LOT 8

LOT

REMOVE EXISTING PARALLEL PARKING STRIPES, SEE NOTE 1

FIRE LANE NO PARKING SIGN (EACH WAY), TYPICAL

EXISTING FIRE HYDRANT

CATEGORY 1 FOREST CONSERVATION EASEMENT

REMOVE EXISTING PARALLEL PARKING STRIPES, SEE NOTE 1

CATEGORY 1 FOREST CONSERVATION EASEMENT

EXISTING FIRE HYDRANT

15' CLEAR BETWEEN BUILDING AND FOREST CONSERVATION EASEMENT

PROPOSED THEATER/MUSIC/DINING HALL

190' TO VEHICULAR ACCESS (EACH WAY)

SEVEN LOCKS ROAD (80' WIDE)

- NO
- 1.
- 2.
- 3.
- 4.

SEE NOTE 4

FDC

R30' NEW FIRE HYDRANT

UNDEVELOPED GYMNASIUM (to be constructed) covered in Case No. CBA-2197-B)

SEE NOTE 3

SOCCER/LACROSSE FIELD (156 PARKING SPACES BELOW) FULLY SPRINKLERED

INTEGRAL GYMNASIUM (TYPICAL)

DUMPSTER ENCLOSURE

HATCHING DENOTES LIMIT OF FIRE ACCESS LANE ABOVE UNDERGROUND STRUCTURE, SEE NOTE 2

BASEBALL FIELD

40' TO VEHICULAR ACCESS (EACH WAY)

CATEGORY 1 FOREST CONSERVATION EASEMENT

6' PRIVACY WOOD FENCE

EXISTING FIRE HYDRANT

