



MONTGOMERY COUNTY EXECUTIVE ORDER

Offices of the County Executive • 101 Monroe Street • Rockville, Maryland 20850

Subject Fire Lane Establishment Order for King of the Nations Christian Fellowship	Executive Order No. 35-14	Subject Suffix
Originating Department Montgomery County Fire and Rescue Service	Department Number MCFRS 10-14	Effective Date 3/11/2014

Fire Lane Establishment Order

Pursuant to Section 22 - 33, Montgomery County Code, 1971, as amended, you are hereby notified that a Fire Lane has been established as described in this order. You are hereby ordered to post fire lane signs and paint curbs/pavement (painting optional) as identified below. When signs and paint work (painting optional) have been completed, this order will authorize the enforcement of this Fire Lane by appropriate police and fire officials. Compliance with this order must be achieved within 30 days of receipt.

LOCATION: 10400 Darnestown Rd.

All areas where indicated by signs and paint.

SIGNS - - (See attached diagram for location of sign placement)



\$250 FINE

FIRE LANE

Signs must be posted so that it is not possible to park a vehicle without being in sight of a sign. Signs may be no further apart than 100 feet

(Red letters on white background)

PAINT - - (See attached diagram if painting).

Paint must be traffic yellow with lines of sufficient width to be readily identifiable/readable by motor vehicle operators.

Fire Chief, Montgomery County Fire and Rescue Service

FIRE ACCESS LEGEND



FIRE APPARATUS
ACCESS ROUTE



FIREFIGHTER
ACCESS ROUTE



FIRE DEPARTMENT
CONNECTION



FIRE HYDRANT

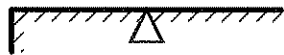

MAIN SIDE HINGE
LOCATION



FIRE LANE NO
PARKING SIGN

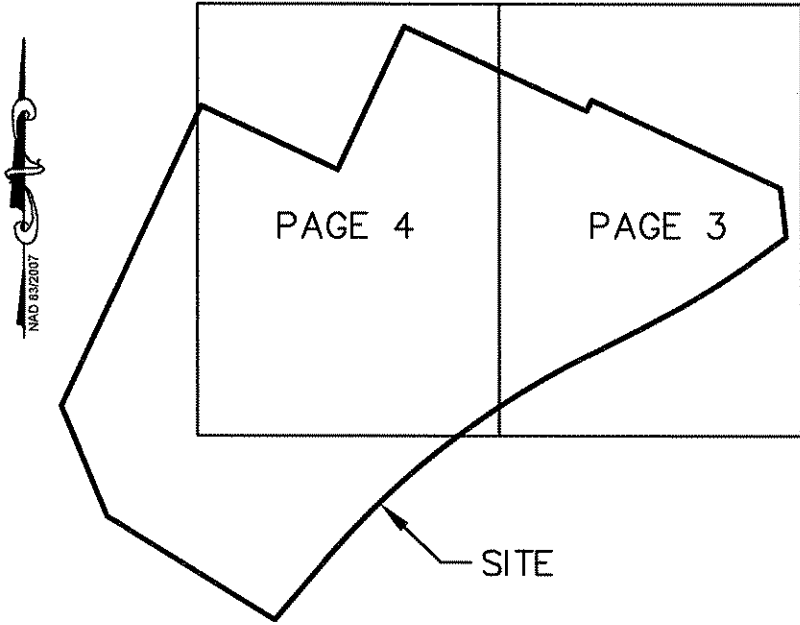

KEY

SCALE: 1" = 200'

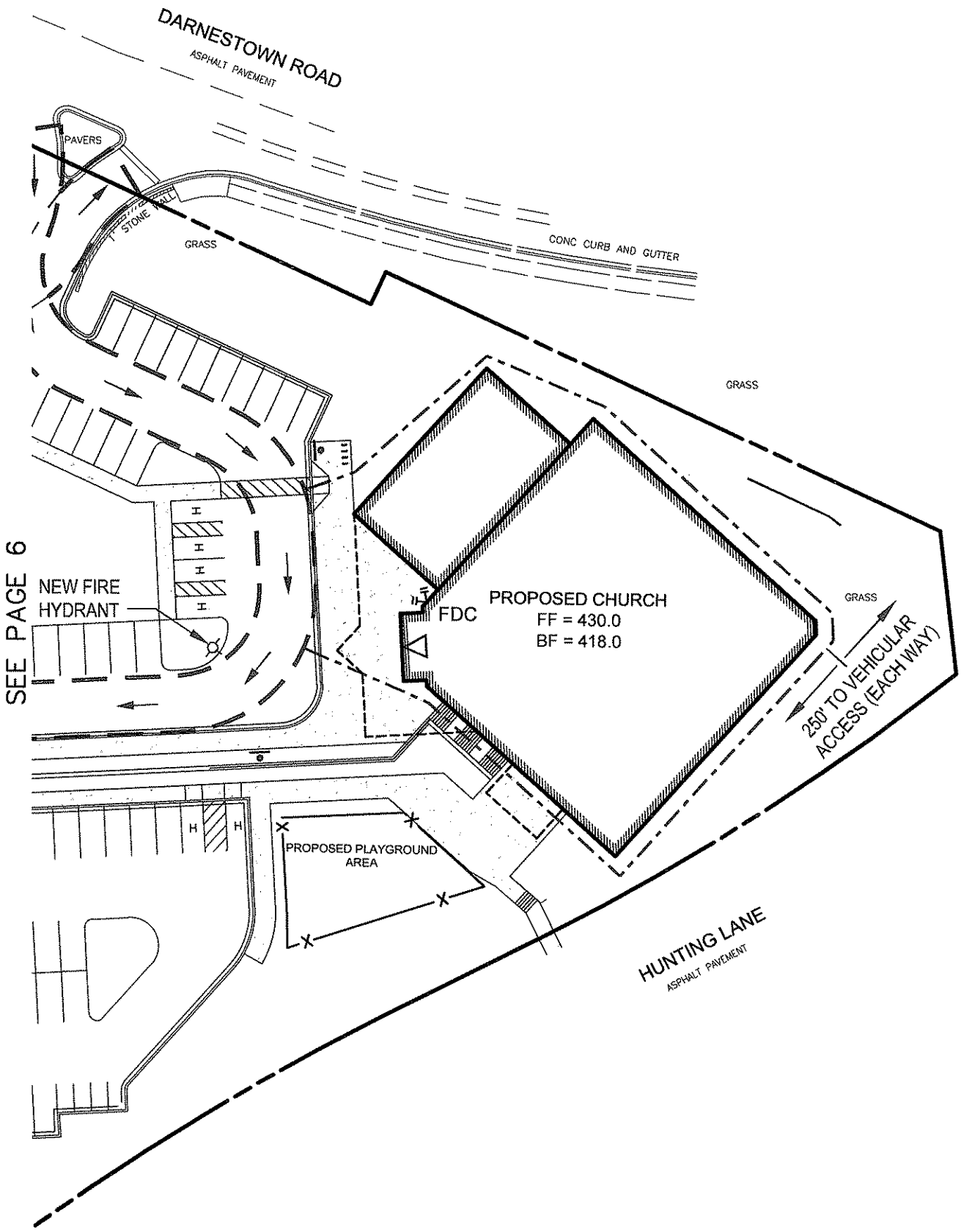

SCALE: 1" = 50'

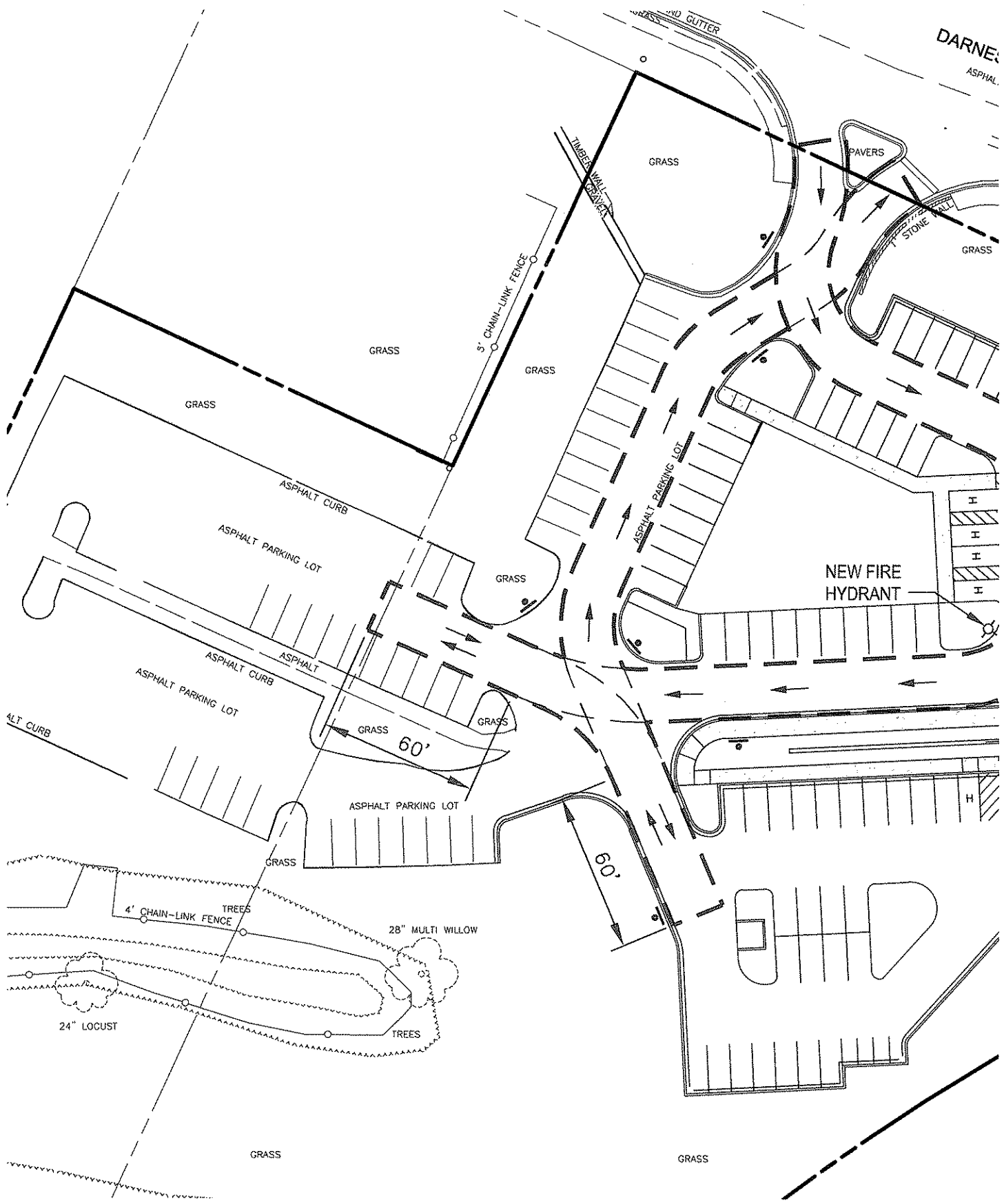

SEE PAGE 5

SCALE: 1" = 50'

NOTES:

1. FIRE APPARATUS ACCESS ROUTE IS 20' WIDE.
2. MINIMUM ROUTE INTERIOR RADIUS = 30', MINIMUM ROUTE OUTSIDE RADIUS = 50'.
3. PROVIDE SIGNAGE IN ACCORDANCE WITH MONTGOMERY COUNTY FIRE AND RESCUE DOCUMENT "FIRE LANE SIGN REQUIREMENTS INFORMATION PACKET, PRIVATE STREETS" DATED MAY 2008.
4. UNDERGROUND UTILITY STRUCTURES BELOW THE FIRE ACCESS LANE MUST BE DESIGNED TO SUPPORT FIRE APPARATUS LOADING PER MONTGOMERY COUNTY FIRE AND RESCUE, OFFICE OF THE FIRE MARSHAL ADMINISTRATIVE INTERPRETATION 09-01.