



MONTGOMERY COUNTY EXECUTIVE ORDER

Offices of the County Executive • 101 Monroe Street • Rockville, Maryland 20850

Subject Fire Lane Establishment Order for Stone Ridge School of the Sacred Heart	Executive Order No. 66-19	Subject Suffix
Originating Department Montgomery County Department of Permitting Services	Department Number MCDPS 6-19	Effective Date 3/25/2019

Fire Lane Establishment Order

Pursuant to Section 22 - 33, Montgomery County Code, 1971, as amended, you are hereby notified that a Fire Lane has been established as described in this order. You are hereby ordered to post fire lane signs and paint curbs/pavement (painting optional) as identified below. When signs and paint work (painting optional) have been completed, this order will authorize the enforcement of this Fire Lane by appropriate police and fire officials. Compliance with this order must be achieved within 30 days of receipt.

LOCATION: 9101 Rockville Pike

All areas where indicated by signs and paint.

SIGNS - - (See attached diagram for location of sign placement)



\$250 FINE

FIRE LANE

Signs must be posted so that it is not possible to park a vehicle without being in sight of a sign. Signs may be no further apart than 100 feet

(Red letters on white background)

PAINT - - (See attached diagram if painting).

Paint must be traffic yellow with lines of sufficient width to be readily identifiable/readable by motor vehicle operators.

Fire Marshal, Montgomery County Department of Permitting Services

The original of this drawing document was prepared by Soltesz, Inc. (SOLTESZ). If this document was not obtained directly from SOLTESZ and/or it was transmitted electronically, SOLTESZ cannot guarantee that unauthorized changes and /or alterations were not made by others. If verification of the information contained hereon is needed, contact should be made directly with SOLTESZ. SOLTESZ makes no warranties, express or implied, concerning the accuracy of any information that has been transmitted by electronic means.

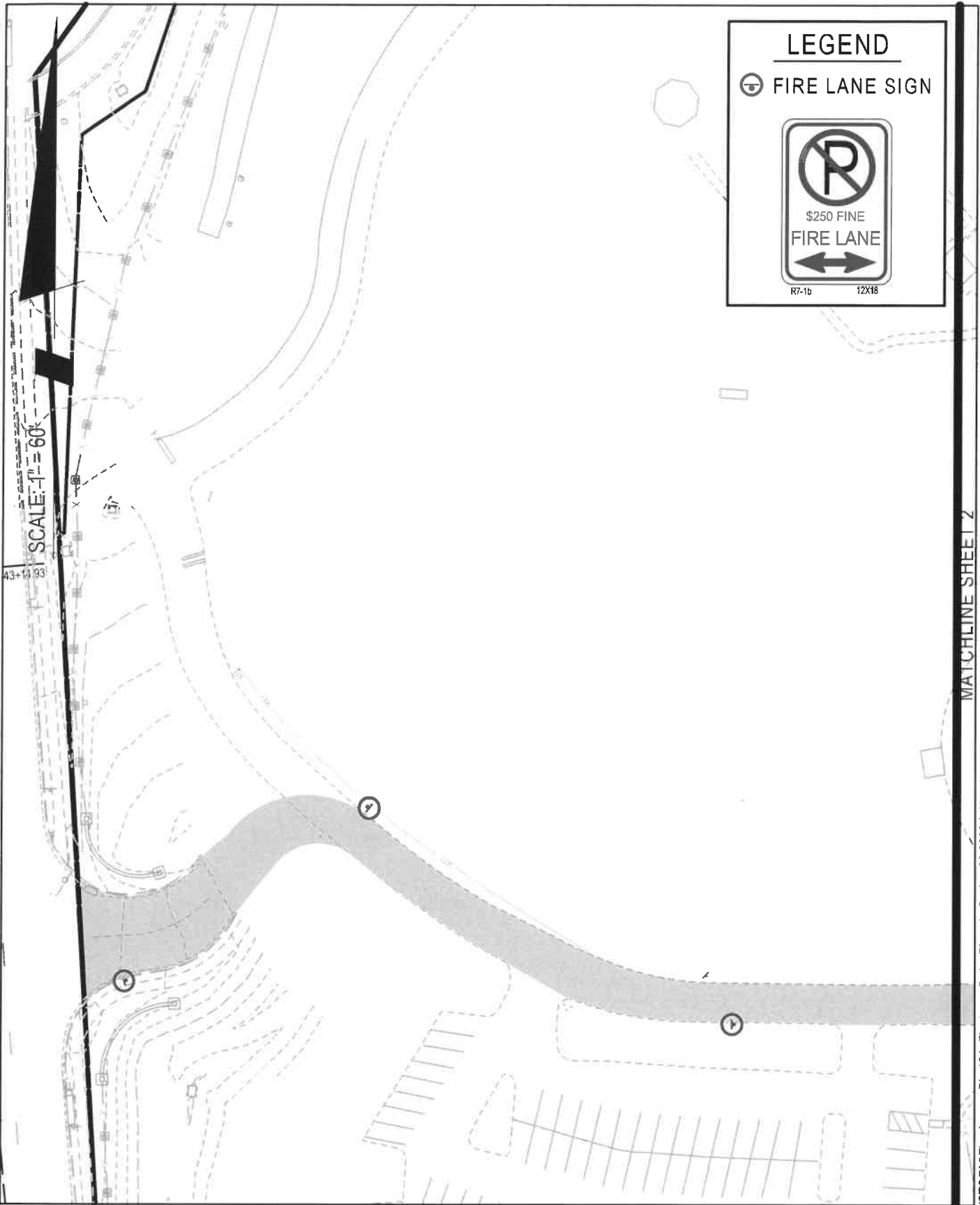

LEGEND

Ⓟ FIRE LANE SIGN

R7-1b 12X18



SOLTESZ, INC.
 2 Research Place, Suite 100
 Rockville, MD 20850
 P.301.948.2750 F.301.948.9067
 www.solteszco.com

FIRE LANE ORDER PLAN
STONE RIDGE SCHOOL OF THE SACRED HEART
 (NEW CENTER FOR STUDENT BUILDING, LOOP ROAD,
 PARKING LOT, AND CAMPUS WALK)
 7th ELECTION DISTRICT, MONTGOMERY COUNTY, MARYLAND

SHEET 1
 OF 4

JOB NO. 1853-04-01 SCALE 1" = 60' DATE MARCH 2019

MATCHLINE SHEET 2 P:\18530401\ENGINEER\PAVSTORM\Fire Access Plan\01_Fire Lane Order Plan.sht Scale= 60.0000 ft./in. User= DChiao PLT.drv= PDF_Grey_150.plt.ctg Pentbl= TEXT_SUB.tbl 3/20/2019 6:01:17 PM

The original of this drawing document was prepared by Soltesz, Inc. (SOLTESZ). If this document was not obtained directly from SOLTESZ and/or it was transmitted electronically, SOLTESZ cannot guarantee that unauthorized changes and /or alterations were not made by others. If verification of the information contained hereon is needed, contact should be made directly with SOLTESZ. SOLTESZ makes no warranties, express or implied, concerning the accuracy of any information that has been transmitted by electronic means.

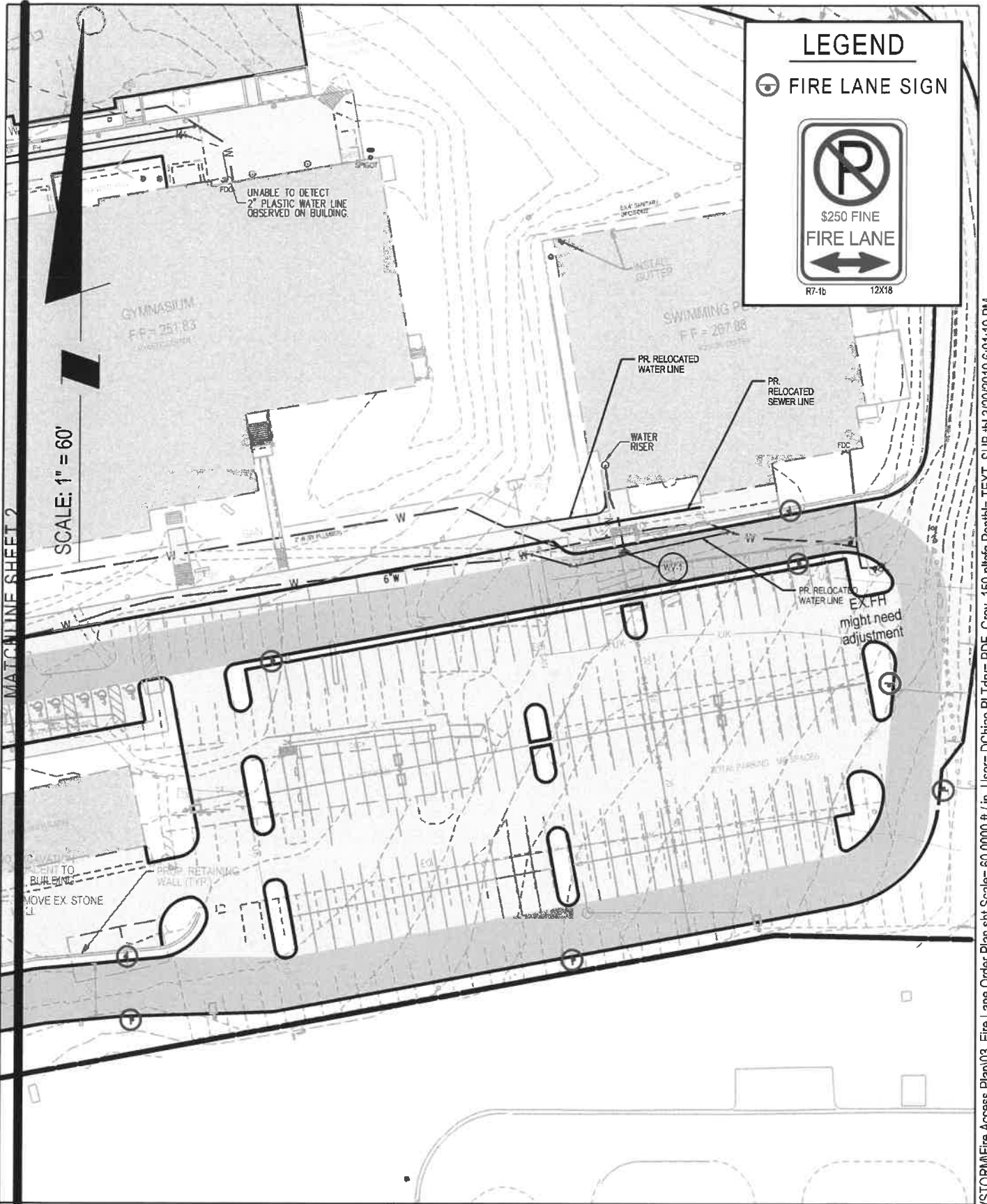

SOLTESZ, INC.
 2 Research Place, Suite 100
 Rockville, MD 20850
 P.301.948.2750 F.301.948.9067
 www.solteszco.com

FIRE LANE ORDER PLAN
STONE RIDGE SCHOOL OF THE SACRED HEART
 (NEW CENTER FOR STUDENT BUILDING, LOOP ROAD,
 PARKING LOT, AND CAMPUS WALK)
 7th ELECTION DISTRICT, MONTGOMERY COUNTY, MARYLAND

JOB NO. 1853-04-01
 SCALE 1" = 60'
 DATE MARCH 2019

SHEET 3
 OF 4

The original of this drawing document was prepared by Soltesz, Inc. (SOLTESZ). If this document was not obtained directly from SOLTESZ and/or it was transmitted electronically, SOLTESZ cannot guarantee that unauthorized changes and / or alterations were not made by others. If verification of the information contained hereon is needed, contact should be made directly with SOLTESZ. SOLTESZ makes no warranties, express or implied, concerning the accuracy of any information that has been transmitted by electronic means.

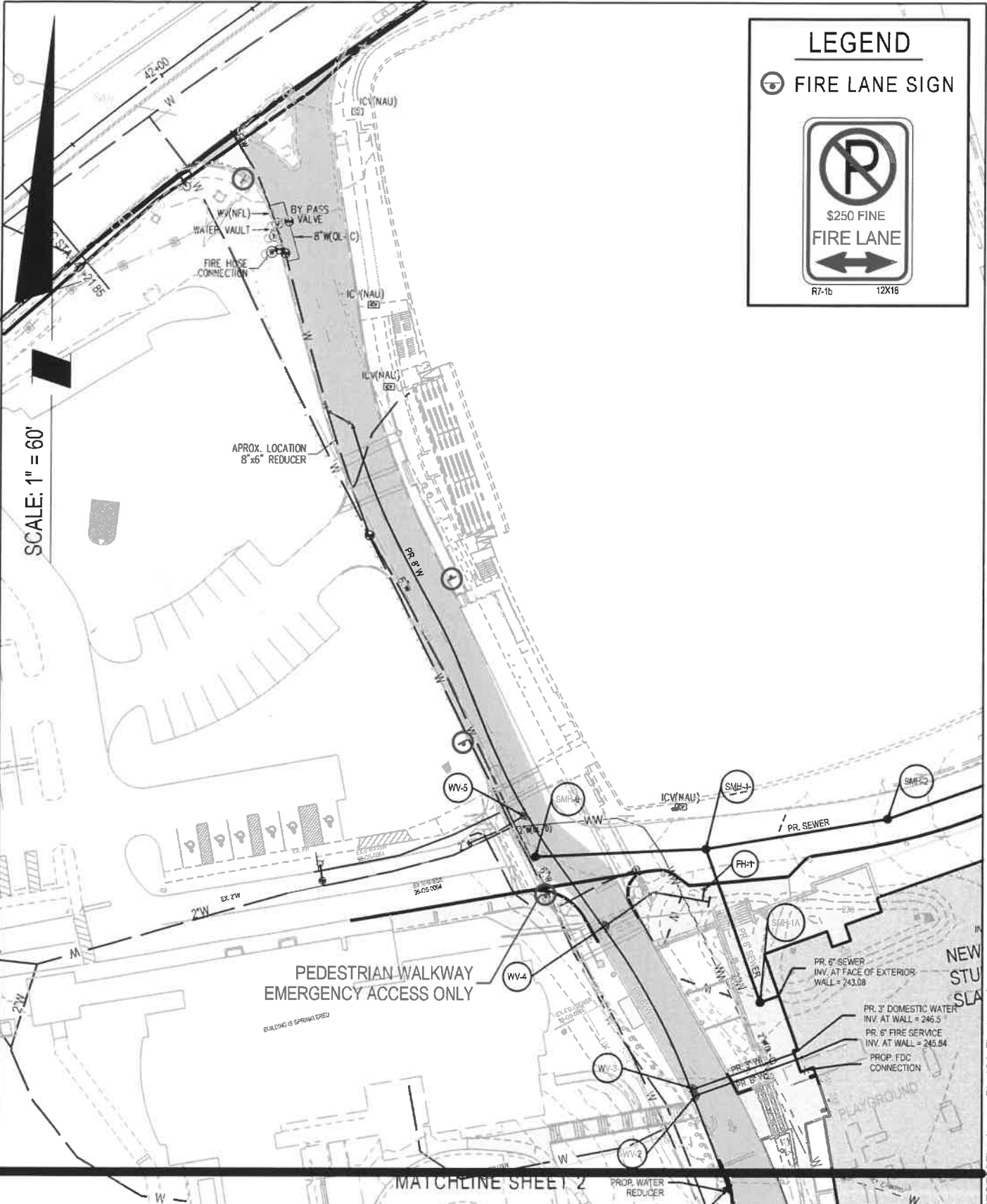

 **SOLTESZ, INC.**
 2 Research Place, Suite 100
 Rockville, MD 20850
 P.301.948.2750 F.301.948.9067
 www.solteszco.com

FIRE LANE ORDER PLAN
STONE RIDGE SCHOOL OF THE SACRED HEART
 (NEW CENTER FOR STUDENT BUILDING, LOOP ROAD,
 PARKING LOT, AND CAMPUS WALK)
 7th ELECTION DISTRICT, MONTGOMERY COUNTY, MARYLAND

SHEET 4
 OF 4

JOB NO. 1853-04-01 SCALE 1" = 60' DATE MARCH 2019

P:\18530401\ENGINEER\PAVSTOR\M\Fire Lane Order Plan.sht Scale=60.0000 ft./in. User=DChiao PL.Tdrv= PDF_Grey_150.plt.ctb Pentbl= TEXT SUB.tbl 3/20/2019 6:01:20 PM