



MONTGOMERY COUNTY EXECUTIVE ORDER

Offices of the County Executive • 101 Monroe Street • Rockville, Maryland 20850

Subject Fire Lane Establishment Order for Ashburton E.S.	Executive Order No. 72-14	Subject Suffix
Originating Department Montgomery County Fire and Rescue Service	Department Number MCFRS 16-14	Effective Date 4/22/2014

Fire Lane Establishment Order

Pursuant to Section 22 - 33, Montgomery County Code, 1971, as amended, you are hereby notified that a Fire Lane has been established as described in this order. You are hereby ordered to post fire lane signs and paint curbs/pavement (painting optional) as identified below. When signs and paint work (painting optional) have been completed, this order will authorize the enforcement of this Fire Lane by appropriate police and fire officials. Compliance with this order must be achieved within 30 days of receipt.

LOCATION: 6314 Lone Oak Dr.

All areas where indicated by signs and paint.

- SIGNS -- (See attached diagram for location of sign placement)



\$250 FINE

FIRE LANE

Signs must be posted so that it is not possible to park a vehicle without being in sight of a sign. Signs may be no further apart than 100 feet

(Red letters on white background)

- PAINT -- (See attached diagram if painting).

Paint must be traffic yellow with lines of sufficient width to be readily identifiable/readable by motor vehicle operators.

Fire Chief, Montgomery County Fire and Rescue Service

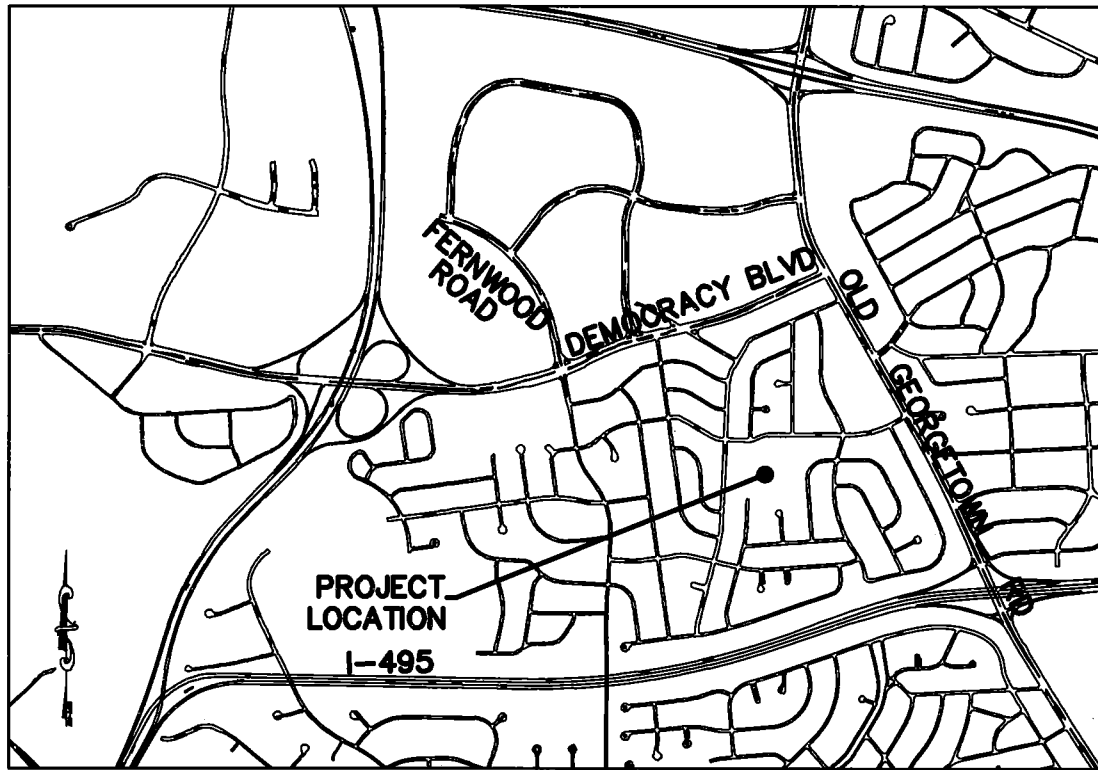

VICINITY MAP

NOT TO SCALE



FIRE LANE SIGNS

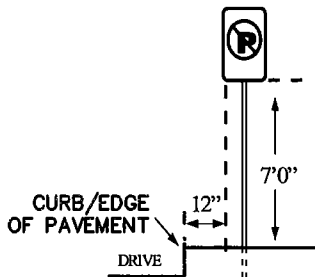

SIGN PLACEMENT DIAGRAM

GENERAL NOTES:

1. SIGNS TO BE CONSISTENT WITH THE MONTGOMERY COUNTY FIRE AND RESCUE (MCFR) GUIDELINES
2. FIRE LANE SIGNS TO BE 12" WIDE BY 18" HIGH



Engineering a Sustainable Future
 Nobis Engineering, Inc.
 20410 Century Blvd Suite 230
 Germantown, MD 20874
 T(301) 528-2010
 www.nobiseng.com
 Client - Focused, Employee - Owned

ASHBURTON ELEMENTARY SCHOOL
 6314 LONE OAK DRIVE

FIRE LANE ACCESS PLAN

JOB NO.: 86980.12

SCALE: 1"=1000'

DATE: MARCH 2014

SHEET NO:

1 OF 2

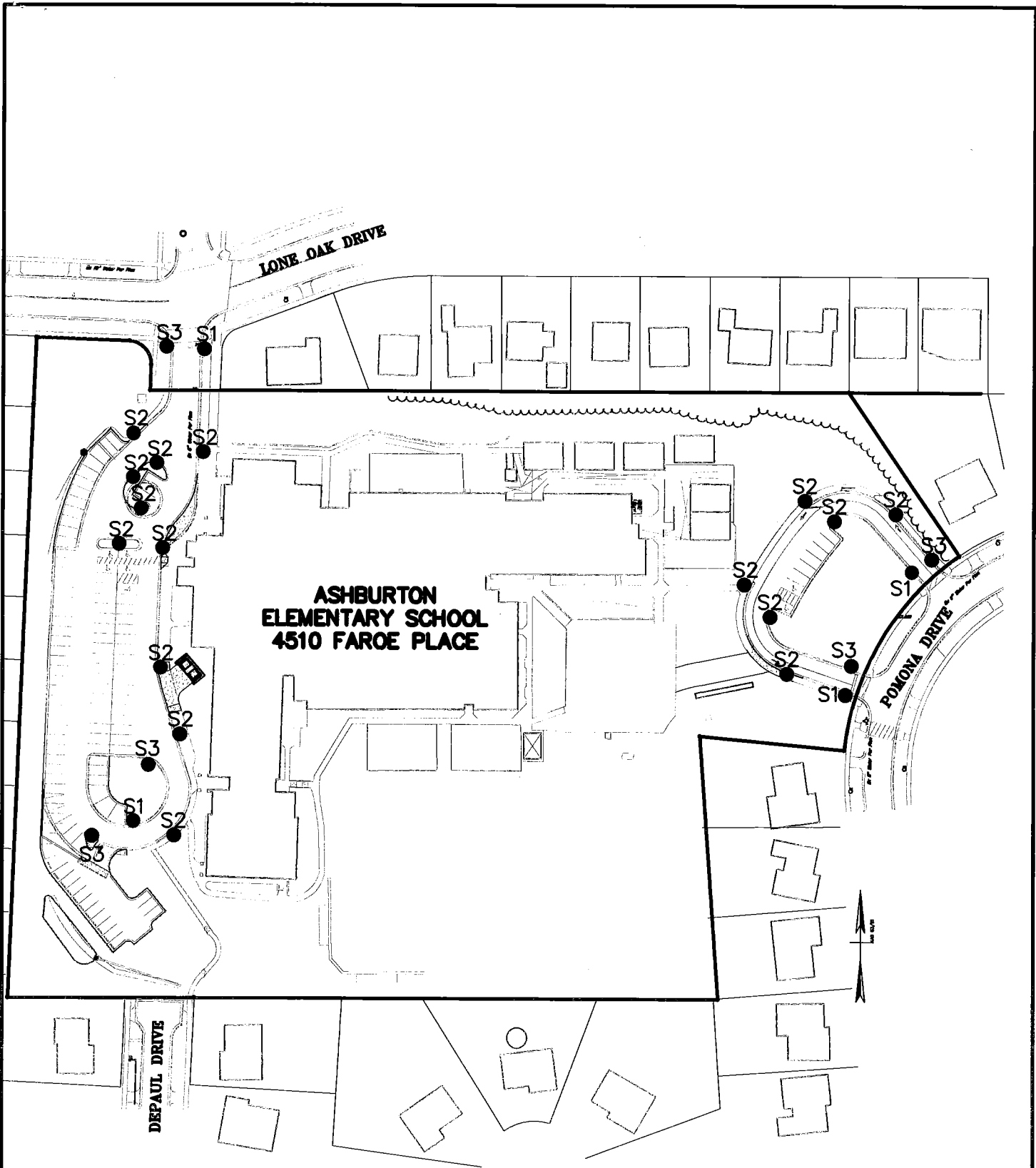

**ASHBURTON
ELEMENTARY SCHOOL
4510 FAROE PLACE**

LEGEND

- FIRE LANE SIGN (TYP)

FIRE LANE PLAN
N.T.S.



Engineering a Sustainable Future
 Nobis Engineering, Inc.
 20410 Century Blvd Suite 230
 Germantown, MD 20874
 T(301) 528-2010
 www.nobiseng.com
 Client - Focused, Employee - Owned

ASHBURTON ELEMENTARY SCHOOL
 6314 LONE OAK DRIVE

FIRE LANE ACCESS PLAN

JOB NO.: 86980.12	SHEET NO: 2 OF 2
SCALE: 1"=100'	DATE: MARCH 2014