



MONTGOMERY COUNTY EXECUTIVE ORDER

Offices of the County Executive • 101 Monroe Street • Rockville, Maryland 20850

Subject Fire Lane Establishment Order for Westland Middle School	Executive Order No. 106-14	Subject Suffix
Originating Department Montgomery County Fire and Rescue Service	Department Number MCFRS 27-14	Effective Date 6/11/2014

Fire Lane Establishment Order

Pursuant to Section 22 - 33, Montgomery County Code, 1971, as amended, you are hereby notified that a Fire Lane has been established as described in this order. You are hereby ordered to post fire lane signs and paint curbs/pavement (painting optional) as identified below. When signs and paint work (painting optional) have been completed, this order will authorize the enforcement of this Fire Lane by appropriate police and fire officials. Compliance with this order must be achieved within 30 days of receipt.

LOCATION: 5511 Massachusetts Ave.

All areas where indicated by signs and paint.

SIGNS - - (See attached diagram for location of sign placement)



\$250 FINE

FIRE LANE

Signs must be posted so that it is not possible to park a vehicle without being in sight of a sign. Signs may be no further apart than 100 feet

(Red letters on white background)

PAINT - - (See attached diagram if painting).

Paint must be traffic yellow with lines of sufficient width to be readily identifiable/readable by motor vehicle operators.

Fire Chief, Montgomery County Fire and Rescue Service

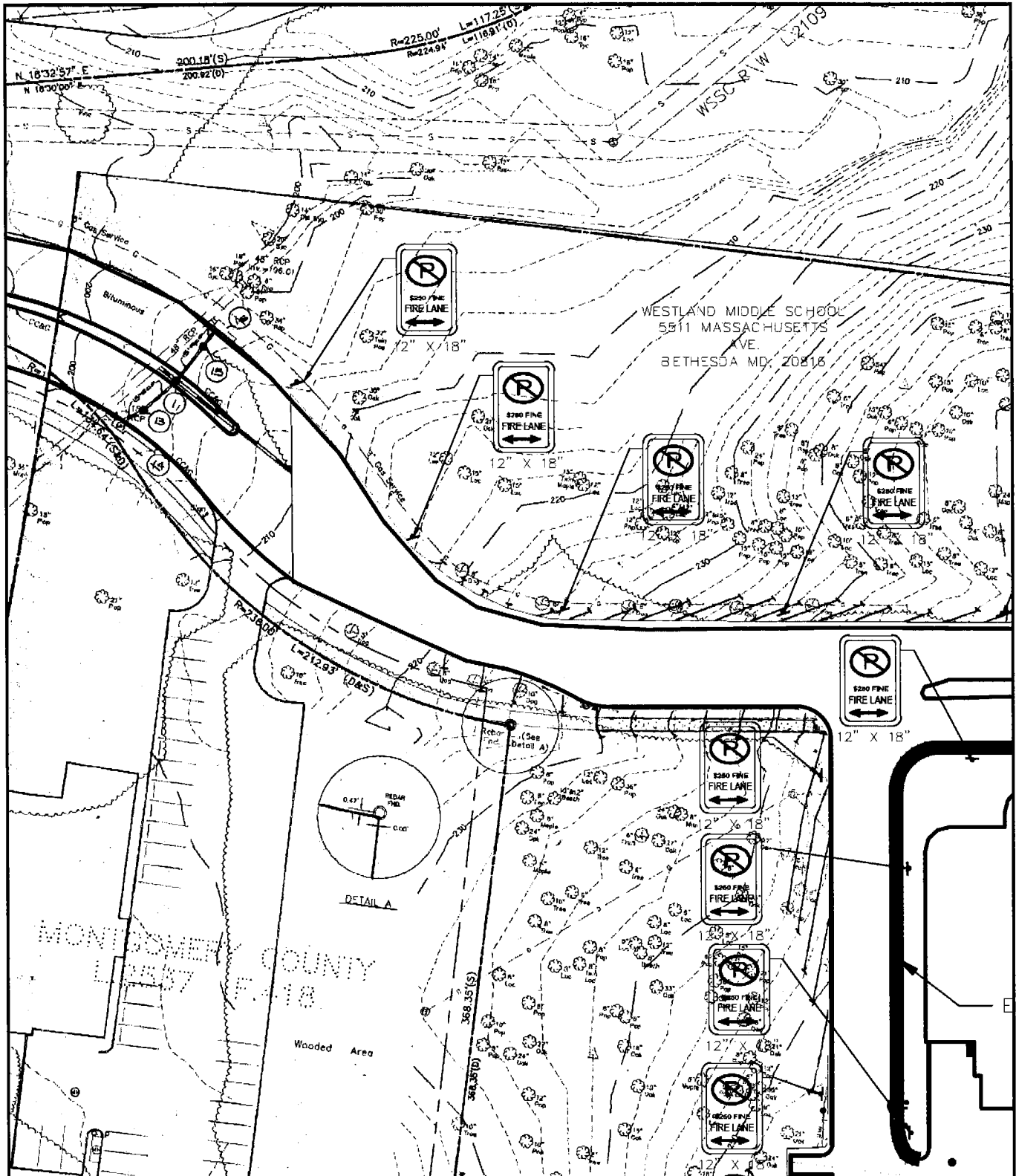

AMT
 A. MORTON THOMAS & ASSOCIATES, INC.
 CONSULTING ENGINEERS
 800 KING FARM BOULEVARD, 4TH FLOOR
 ROCKVILLE, MD 20850
 PH: 301-881-2545 FAX: 301-881-0814
 EMAIL: AMT1@AMTENGINEERING.COM

WESTLAND MIDDLE SCHOOL
 5911 MASSACHUSETTS AVE. BETHESDA, MD 20818

FIRE LANE ORDER 1 OF 3

Scale: 1" = 60' Date: 5/28/2014
 Ref Sheet: C-FAP
 Project No: 114-195
 Drawn by: JAC
 Checked by: WJP

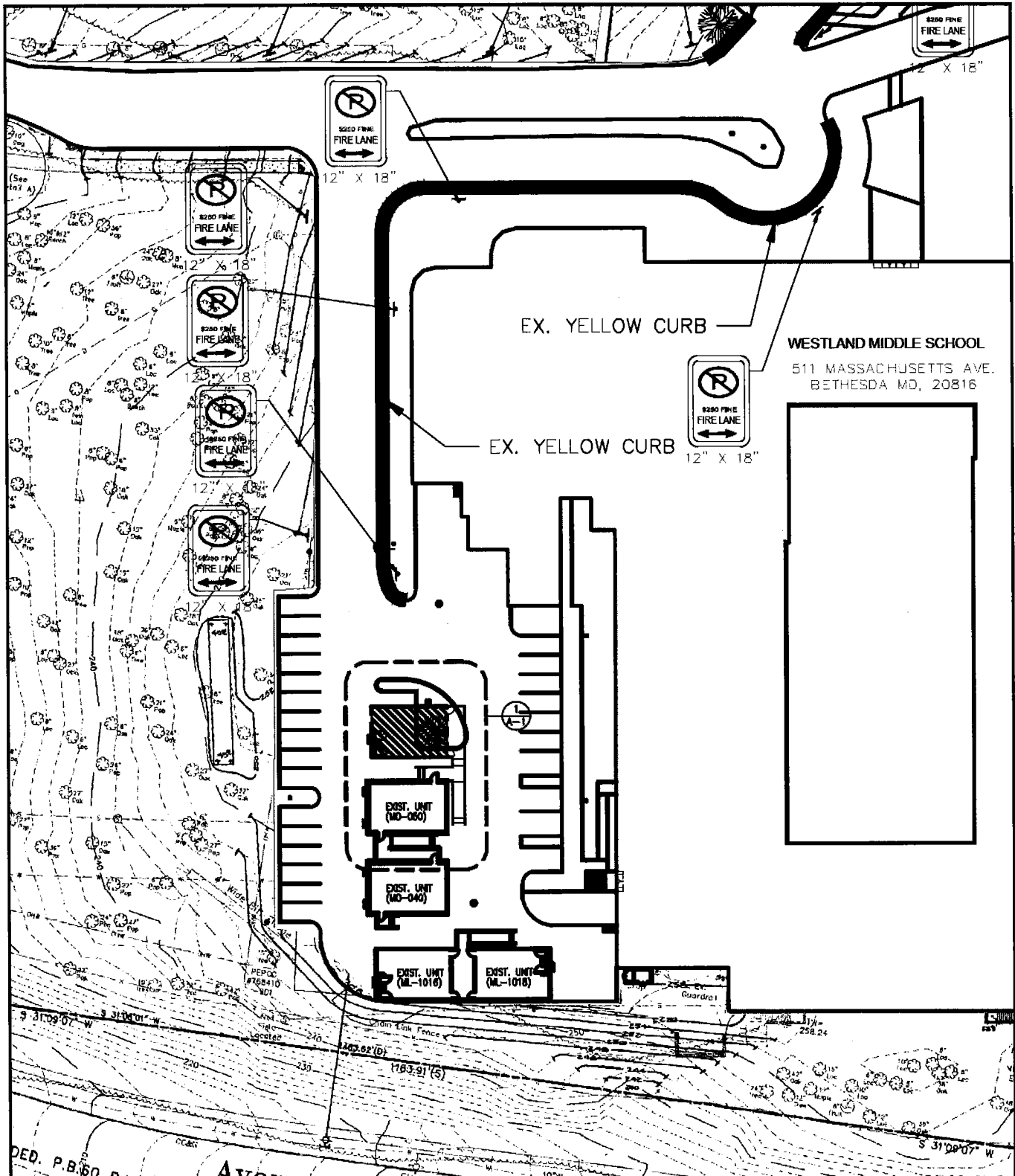

AMT
 A. MORTON THOMAS & ASSOCIATES, INC.
 CONSULTING ENGINEERS
 800 KING FARM BOULEVARD, 4TH FLOOR
 ROCKVILLE, MD 20850
 PH: 301-881-2545 FAX: 301-881-0814
 EMAIL: AMT1@AMTENGINEERING.COM

WESTLAND MIDDLE SCHOOL
 511 MASSACHUSETTS AVE. BETHESDA, MD 20816
 FIRE LANE ORDER 2 OF 3

Scale:	1" = 60'	Date:	5/28/2014
Ref Sheet:	C-FAP		
Project No:	114-195		
Drawn by:	JAC		
Checked by:	WJP		

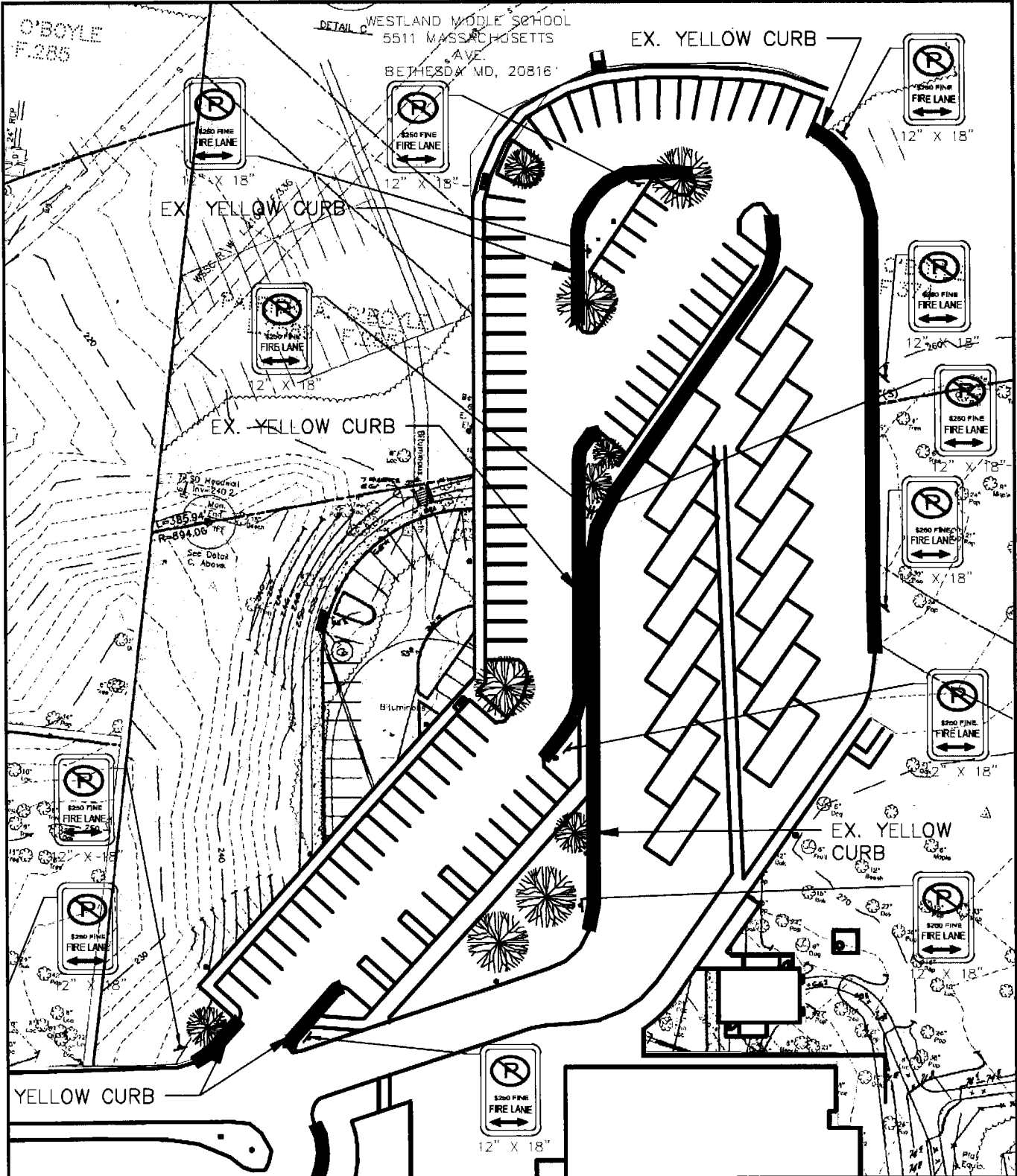

WESTLAND MIDDLE SCHOOL
 5511 MASSACHUSETTS
 AVE.
 BETHESDA, MD, 20816

O'BOYLE
 F.285

AMT
 A. MORTON THOMAS & ASSOCIATES, INC.
 CONSULTING ENGINEERS
 800 KING FARM BOULEVARD, 4TH FLOOR
 ROCKVILLE, MD 20850
 PH: 301-881-2545 FAX: 301-881-0814
 EMAIL: AMT1@AMTENGINEERING.COM

WESTLAND MIDDLE SCHOOL
 5511 MASSACHUSETTS AVE. BETHESDA, MD 20816

FIRE LANE ORDER 3 OF 3

Scale:	1" = 60'	Date:	5/28/2014
Ref Sheet:	C-FAP		
Project No:	114-195		
Drawn by:	JAC		
Checked by:	WJP		