

MONTGOMERY COUNTY EXECUTIVE ORDER

Offices of the County Executive • 101 Monroe Street • Rockville, Maryland 20850

Subject Fire Lane	Executive Order No. 12-12	Subject Suffix
Originating Department Montgomery County Fire and Rescue Service	Department Number MCFRS 2-12	Effective Date 12/30/2011

Fire Lane Establishment Order

Pursuant to Section 22 - 33, Montgomery County Code, 1971, as amended, you are hereby notified that a Fire Lane has been established as described in this order. You are hereby ordered to post fire lane signs and paint curbs/pavement (painting optional) as identified below. When signs and paint work (painting optional) have been completed, this order will authorize the enforcement of this Fire Lane by appropriate police and fire officials. Compliance with this order must be achieved within 30 days of receipt.

LOCATION: University Gardens II
440 University Blvd., East

All areas where indicated by signs and paint.

SIGNS - - (See attached diagram for location of sign placement)



\$250 FINE

FIRE LANE

Signs must be posted so that it is not possible to park a vehicle without being in sight of a sign. Signs may be no further apart than 100 feet

(Red letters on white background)

PAINT - - (See attached diagram if painting).

Paint must be traffic yellow with lines of sufficient width to be readily identifiable/readable by motor vehicle operators.

Fire Chief, Montgomery County Fire and Rescue Service

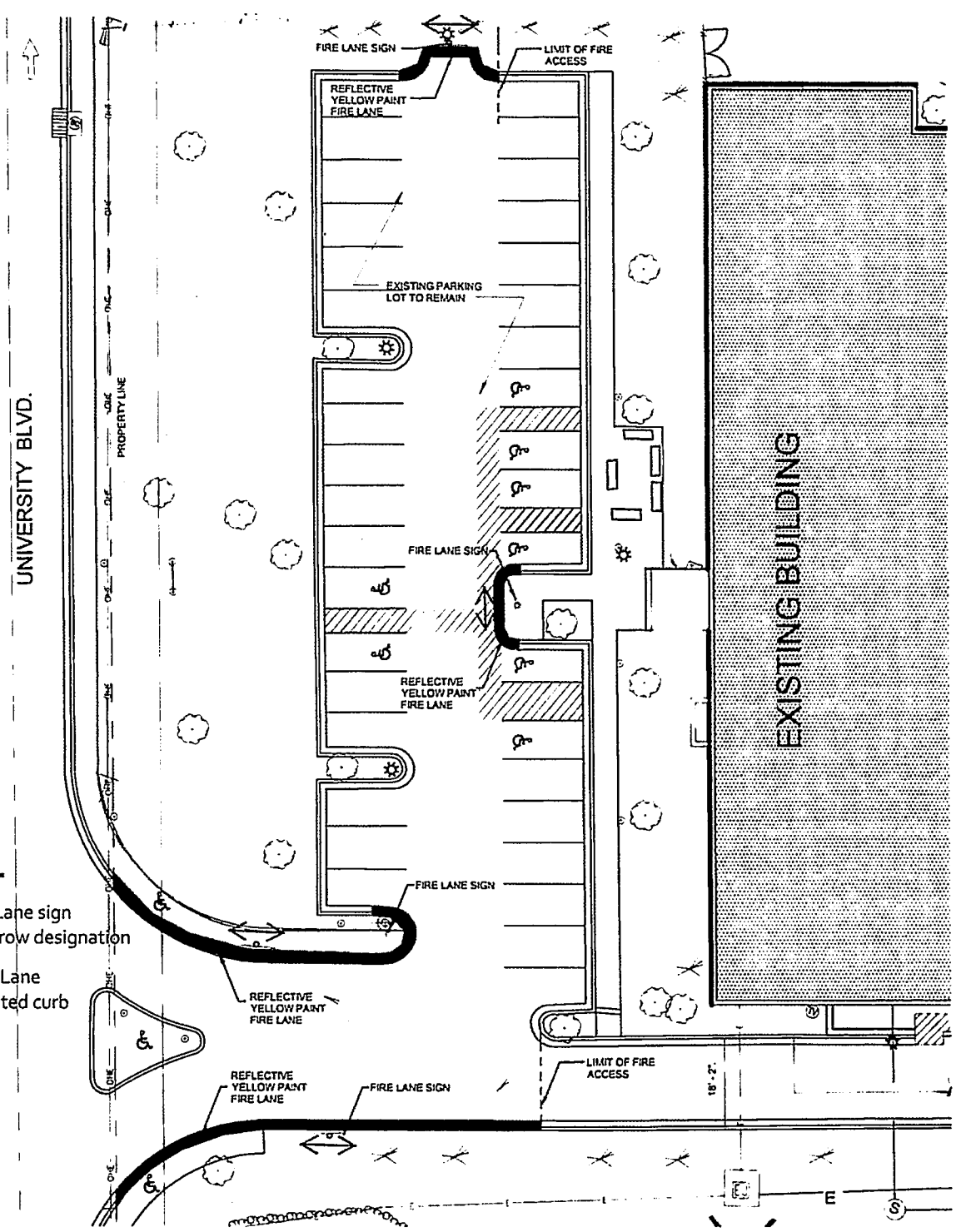

KEY

↔ Fire Lane sign w/ arrow designation

▬ Fire Lane Painted curb

REFLECTIVE YELLOW PAINT FIRE LANE

REFLECTIVE YELLOW PAINT FIRE LANE

FIRE LANE SIGN

LIMIT OF FIRE ACCESS



UNIVERSITY GARDENS II
 440 University Boulevard East
 Silver Spring MD

JOB NO.: 2009-407.00

DATE: 2011-12-30

SCALE: 1"=30'

FIRE LANE ORDER