



MONTGOMERY COUNTY EXECUTIVE ORDER

Offices of the County Executive • 101 Monroe Street • Rockville, Maryland 20850

| | | |
|---|---------------------------------|-----------------------------|
| Subject Fire Lane Establishment Order for White Oak Property | Executive Order No. 13-14 | Subject Suffix |
| Originating Department Montgomery County Fire and Rescue Service | Department Number MCFRS 1-14 | Effective Date 1/15/2014 |

Fire Lane Establishment Order

Pursuant to Section 22 - 33, Montgomery County Code, 1971, as amended, you are hereby notified that a Fire Lane has been established as described in this order. You are hereby ordered to post fire lane signs and paint curbs/pavement (painting optional) as identified below. When signs and paint work (painting optional) have been completed, this order will authorize the enforcement of this Fire Lane by appropriate police and fire officials. Compliance with this order must be achieved within 30 days of receipt.

LOCATION: Regent Manor Ct. and Whitehall Dr.

All areas where indicated by signs and paint.

SIGNS - - (See attached diagram for location of sign placement)



\$250 FINE

FIRE LANE

Signs must be posted so that it is not possible to park a vehicle without being in sight of a sign. Signs may be no further apart than 100 feet

(Red letters on white background)

PAINT - - (See attached diagram if painting).

Paint must be traffic yellow with lines of sufficient width to be readily identifiable/readable by motor vehicle operators.

Fire Chief, Montgomery County Fire and Rescue Service

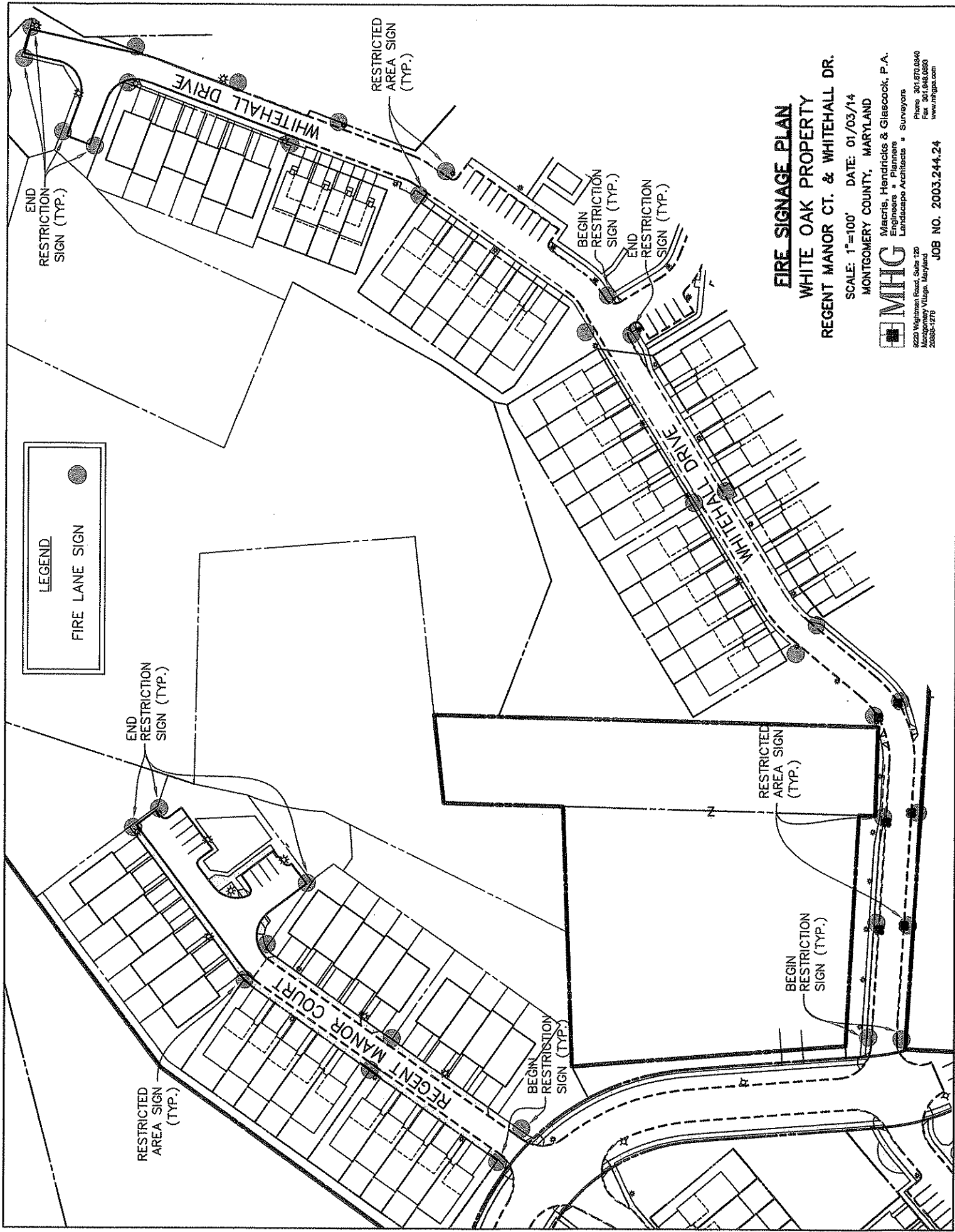

FIRE SIGNAGE PLAN

WHITE OAK PROPERTY
REGENT MANOR CT. & WHITEHALL DR.

SCALE: 1"=100' DATE: 01/03/14

MONTGOMERY COUNTY, MARYLAND

MHG
 Macris, Hendricks & Glascock, P.A.
 Engineers • Planners
 Landscape Architects • Surveyors
 Phone 301.670.0940
 Fax 301.948.0683
 www.mhga.com

JOB NO. 2003.244.24



Either type may be used provided the same type is used consistently.



←100 ft.→

←100 ft.→

Begin/End Restriction signs shall have the arrow pointing towards the restricted area. Restricted Area signs shall have arrows pointing in both directions.

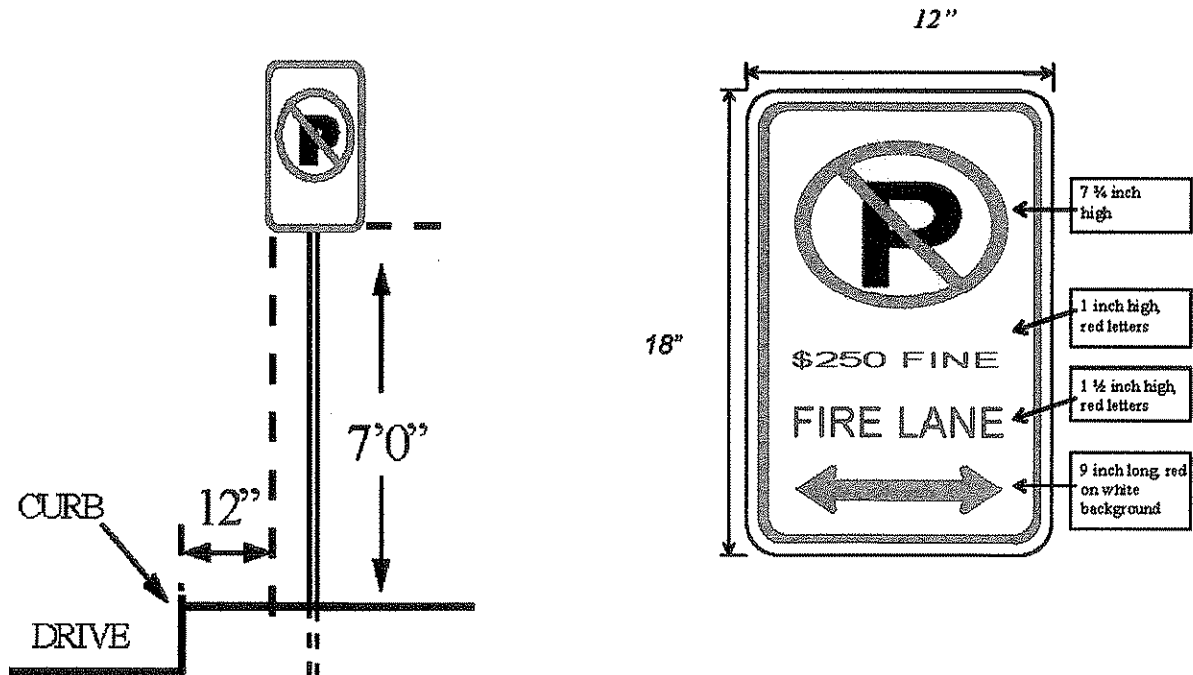

FIRE SIGNAGE DETAILS
 WHITE OAK PROPERTY
 REGENT MANOR CT. & WHITEHALL DR.

SCALE: NONE DATE: 01/03/14
 MONTGOMERY COUNTY, MARYLAND



Macris, Hendricks & Glascock, P.A.
 Engineers • Planners
 Landscape Architects • Surveyors

6220 Wightman Road, Suite 120
 Montgomery Village, Maryland
 20888-1279

Phone 301.676.0940
 Fax 301.848.0683
 www.mhgps.com

JOB NO. 2003.244.24