



MONTGOMERY COUNTY EXECUTIVE ORDER

Offices of the County Executive • 101 Monroe Street • Rockville, Maryland 20850

Subject Fire Lane	Executive Order No. 14-12	Subject Suffix
Originating Department Montgomery County Fire and Rescue Service	Department Number MCFRS 4-12	Effective Date 1/25/2012

Fire Lane Establishment Order

Pursuant to Section 22 - 33, Montgomery County Code, 1971, as amended, you are hereby notified that a Fire Lane has been established as described in this order. You are hereby ordered to post fire lane signs and paint curbs/pavement (painting optional) as identified below. When signs and paint work (painting optional) have been completed, this order will authorize the enforcement of this Fire Lane by appropriate police and fire officials. Compliance with this order must be achieved within 30 days of receipt.

LOCATION: Olney Assisted Living
16940 Georgia Ave.

All areas where indicated by signs and paint.

- SIGNS - - (See attached diagram for location of sign placement)



\$250 FINE
FIRE LANE

Signs must be posted so that it is not possible to park a vehicle without being in sight of a sign. Signs may be no further apart than 100 feet

(Red letters on white background)

- PAINT - - (See attached diagram if painting).

Paint must be traffic yellow with lines of sufficient width to be readily identifiable/readable by motor vehicle operators.

Fire Chief, Montgomery County Fire and Rescue Service

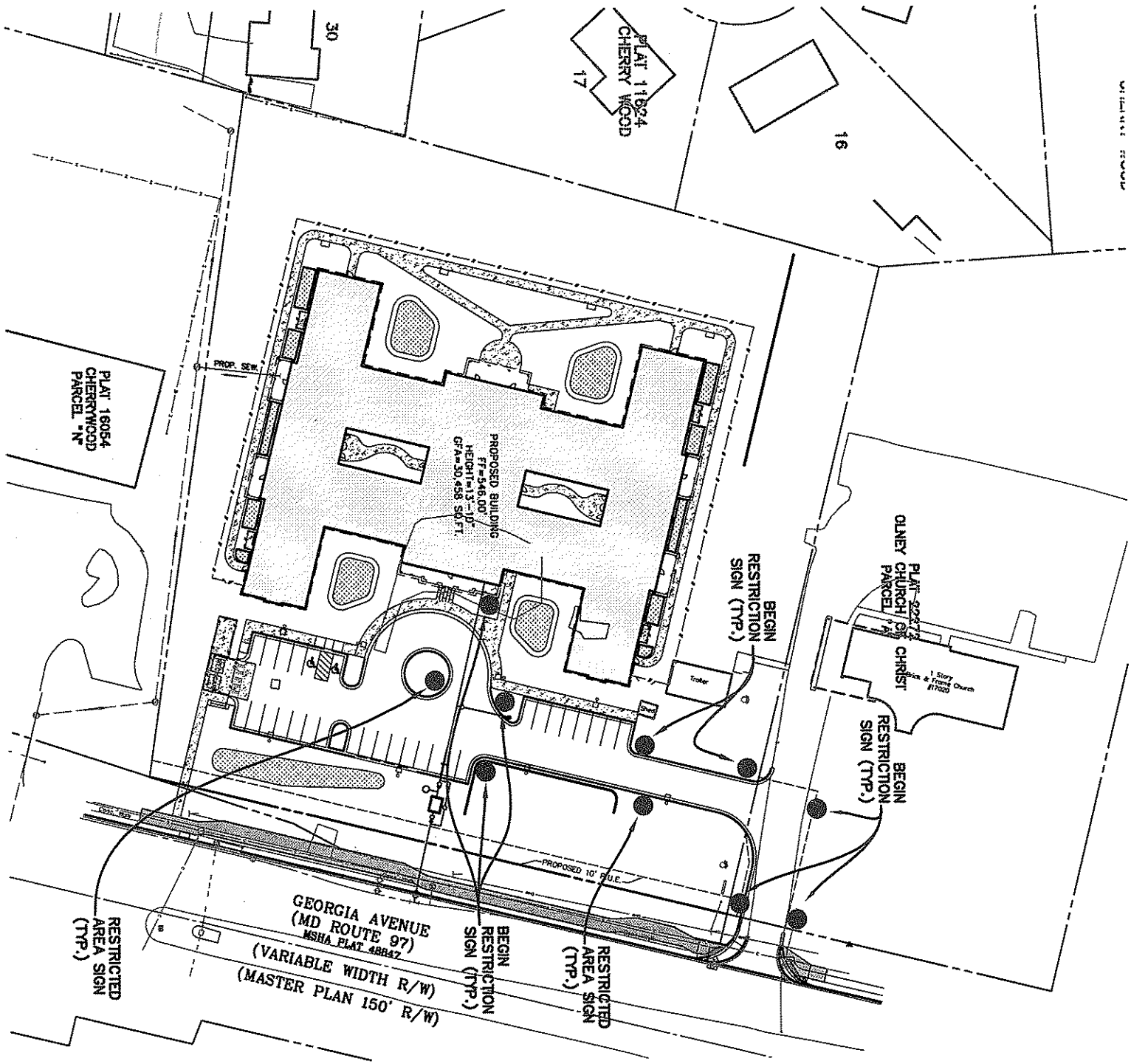

FIRE SIGNAGE PLAN
OLNEY ASSISTED LIVING
OLNEY, MARYLAND

SCALE: 1"=80' DATE: 01/27/2012
 MONTGOMERY COUNTY, MARYLAND

*FINAL SIGN LOCATIONS AND CURB MARKINGS (AS WELL AS THE APPLICABLE USE OF SIGNAGE VS. CURB MARKING) TO BE AT THE DISCRETION OF THE INSPECTOR.

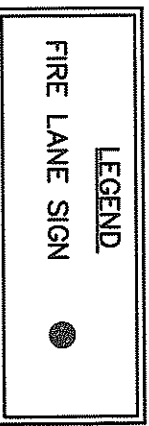

Macris, Hendricks & Glascock, P.A.
 Engineers ■ Planners
 Landscape Architects ■ Surveyors

9220 Wapston Road, Suite 120
 Montgomery Village, Maryland
 20886-1279

Phone: 301.670.0840
 Fax: 301.948.0593
 www.mhga.com

JOB NO. 2011.114.11



Either type may be used provided the same type is used consistently.



←100 ft.→

←100 ft.→

Begin/End Restriction signs shall have the arrow pointing towards the restricted area. Restricted Area signs shall have arrows pointing in both directions.

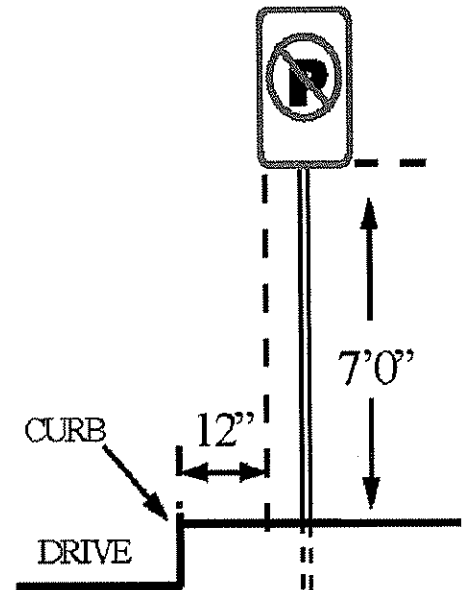
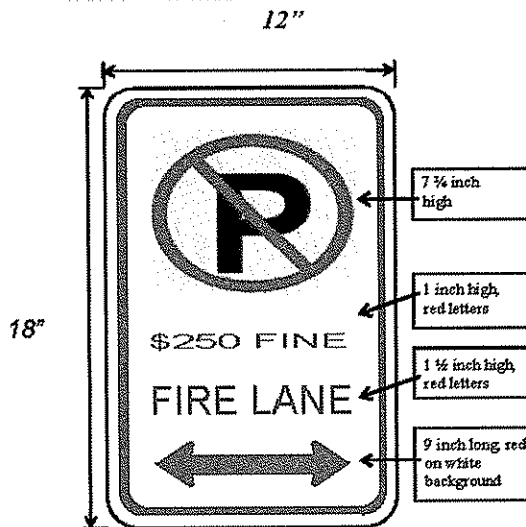

FIRE SIGNAGE PLAN
OLNEY ASSISTED LIVING
OLNEY, MARYLAND

SCALE: 1"=80' DATE: 01/27/2012
 MONTGOMERY COUNTY, MARYLAND

MHG Macris, Hendricks & Glascock, P.A.
 Engineers • Planners
 Landscape Architects • Surveyors

9220 Wighman Road, Suite 120
 Montgomery Village, Maryland
 20886-1279

Phone 301.670.0840
 Fax 301.948.0693
 www.mhga.com

*FINAL SIGN LOCATIONS AND CURB MARKINGS (AS WELL AS THE APPLICABLE USE OF SIGNAGE VS. CURB MARKING) TO BE AT THE DISCRETION OF THE INSPECTOR.