

A topographic map showing a mountainous area with various trails, roads, and geographical features. The map includes labels for 'Rocky Mountain National Park', 'Rocky Mountain Stream Valley Park', and 'MacArthur'. Distances like '0.3mi', '0.4mi', and '0.7mi' are marked. The title 'Intro to CalTopo App' is overlaid in large black text.

Intro to CalTopo App

What is CalTopo

In 2010, after another middle of the night search and rescue mission with limited mapping resources, Matt Jacobs set out to pull some digital maps together into a tool that searchers could use to make some planning decisions. After adding the ability to draw objects over the digital map layers, then import gpx tracks, CalTopo (then SARTopo) quickly grew into the number one tool for managing SAR missions across the US. In 2017, Jacobs transitioned to full time work on the program, and began hiring shortly thereafter. The mobile app followed a few years later, making the job of the incident management team infinitely more efficient.

CalTopo is now used not only in Search and Rescue, but also by recreational users as the most advanced planning tool for backcountry travel. On the first response side, the use has expanded to include law enforcement, child abduction response, urban and wilderness fire, event planning, and much more.

Intro to CalTopo App

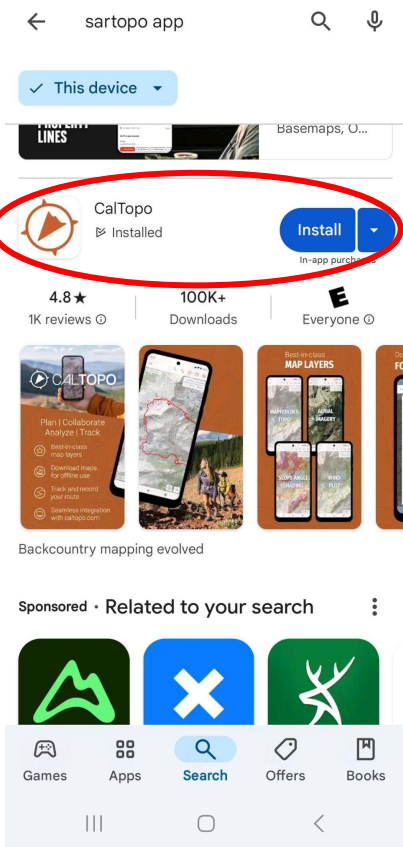

❖ Locate the CalTopo App in the Google Play Store (Android) or Apple Store

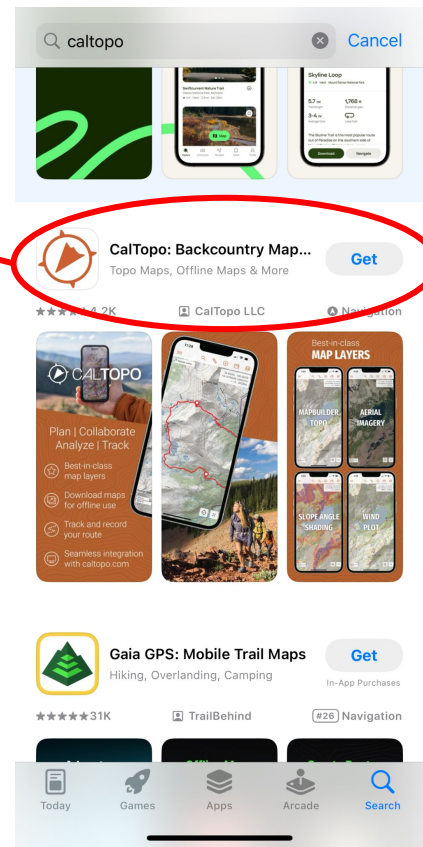

Intro to CalTopo App

- ❖ From there, select **Sign Up** (if you do not have an account)
- ❖ Then select your sign up option of choice.

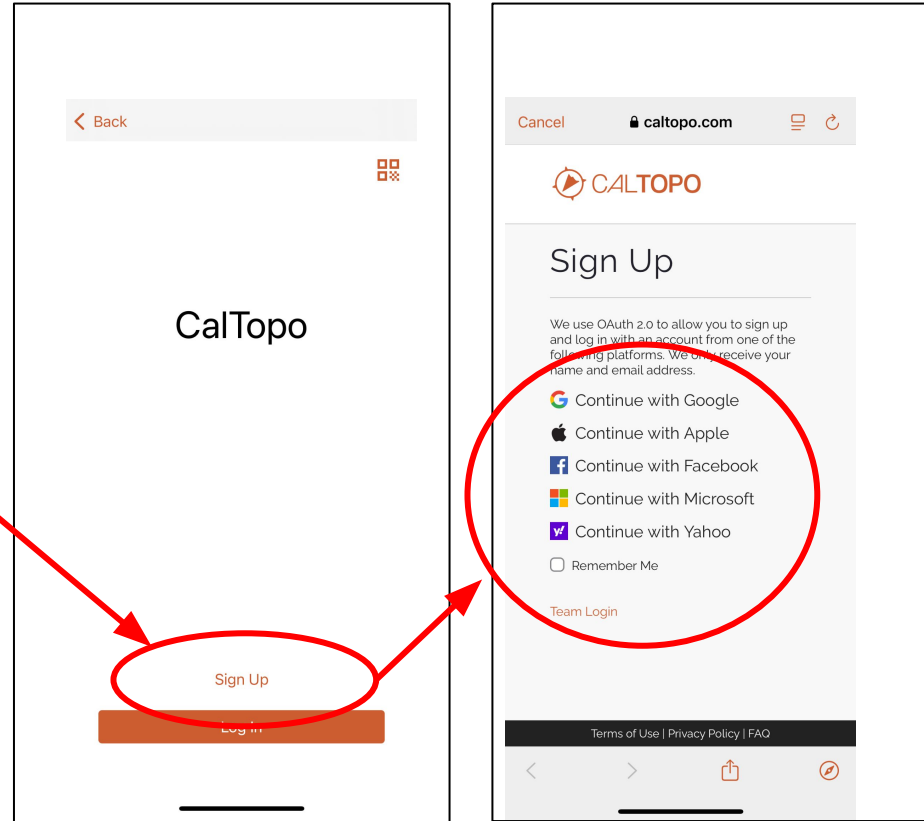

Intro to CalTopo App

- ❖ **Select Shared Map (if signing in via the app)**
 - Click the three bars in the top left corner
 - Click “MCFRS SAR” Folder
 - Select appropriate Sub Folder
 - Select the appropriate shared map for incident

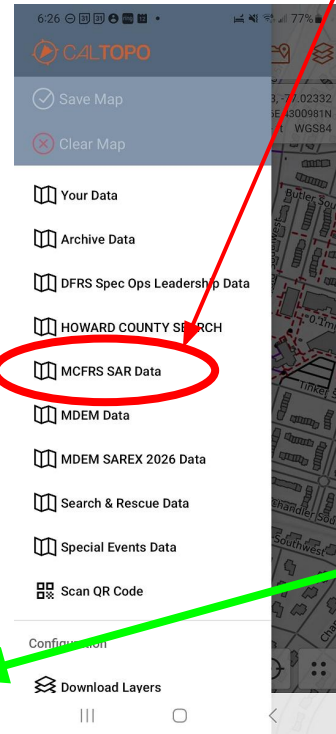
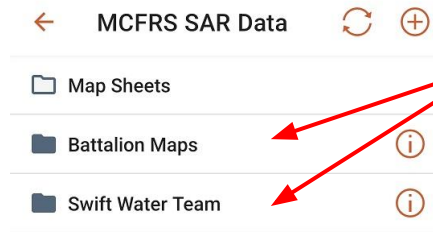

- ❖ **Only available with Team account**

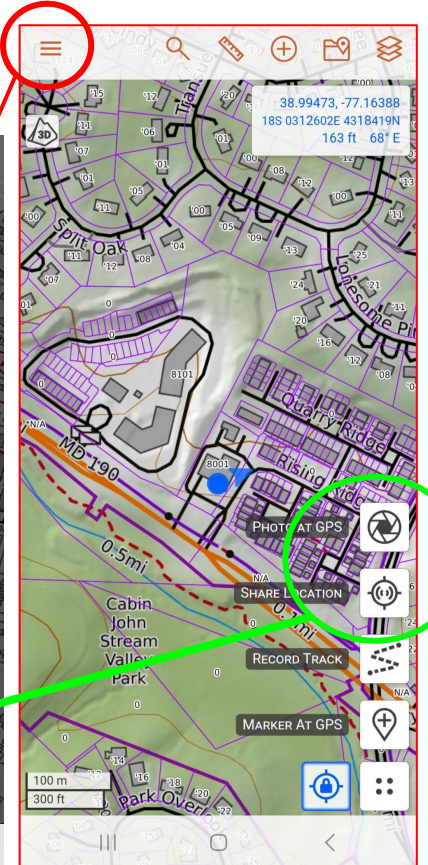

Intro to CalTopo App

◆ Enable Tracking

- Click the four dots in the bottom right corner
- Select “record track”
- Label track name as Unit # 7XX
- Click record track

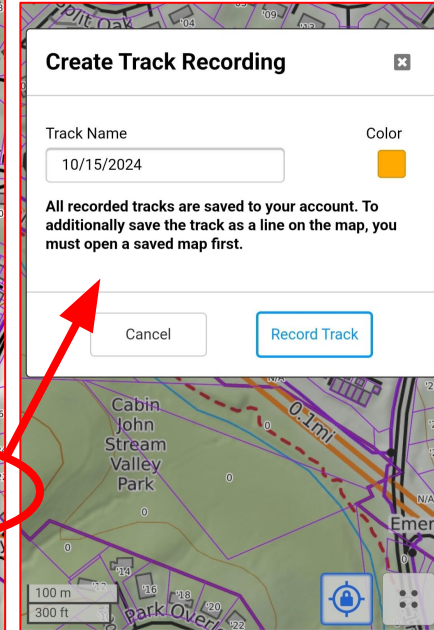
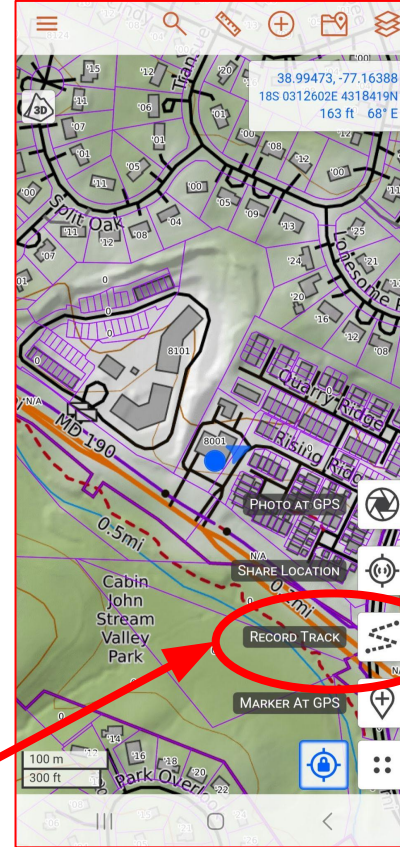
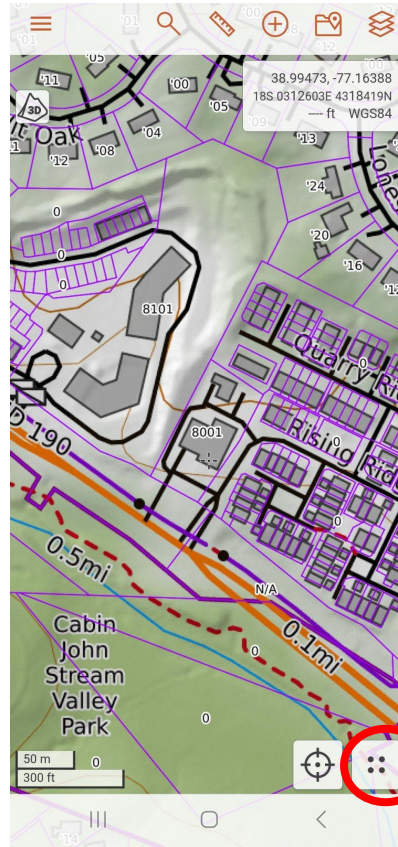

Intro to CalTopo App

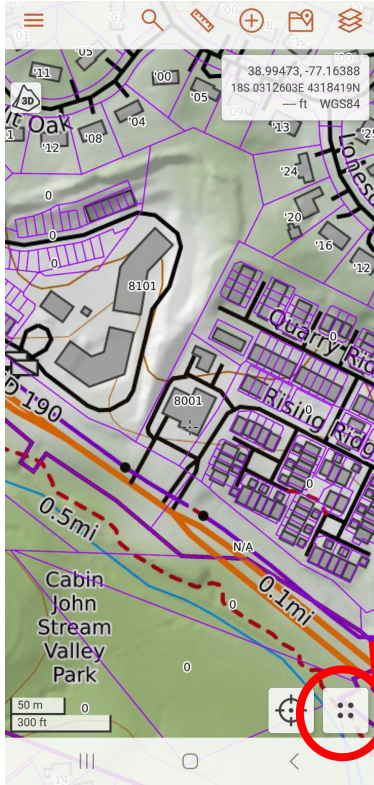

Drop Markers

- Click the four dots in the bottom right corner
- Select “Marker at GPS”
- Label Marker if desired
(don't remove time stamp!)
- Change color and style as necessary
(Your discretion)
- Select “Ok”

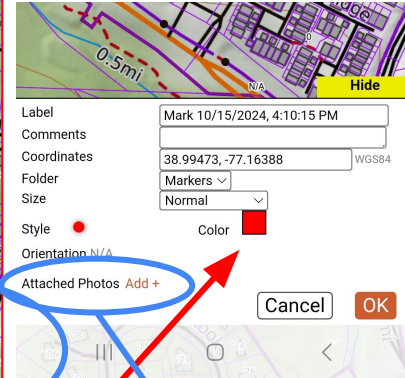
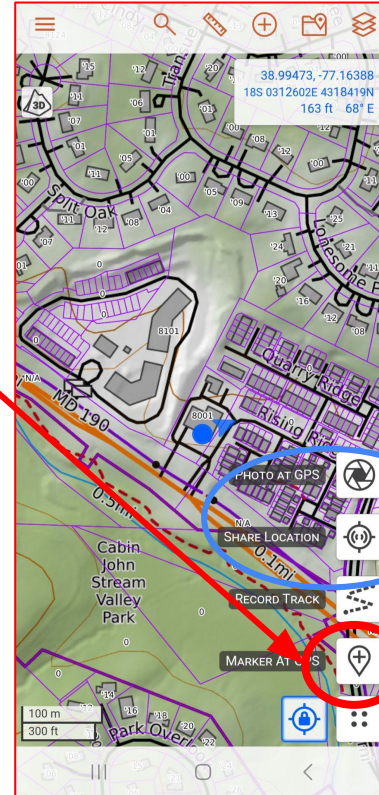

Only available with Team account

Intro to CalTopo App

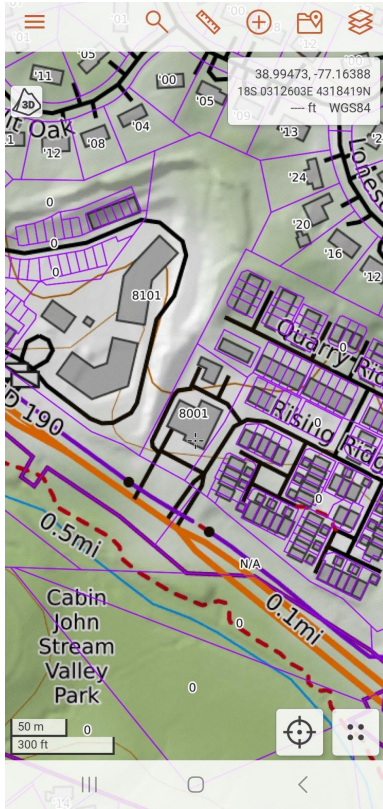

Additional Information and Tools to Navigate the App

- ❖ Scan QR Code (to open/join an existing map)
- ❖ Find (Location or Coordinates)
- ❖ Measure (Point, Lines or Polygons)
- ❖ Add (Markers, Lines, Range Rings, etc.)
- ❖ Map Items (Import/Export, Select/Deselect Markers and Other Map Information)
- ❖ Map Layers (Adjust the Map View)
- ❖ Center on Location

Intro to CalTopo App

- ❖ Scan QR Code (to open/join an existing map)

Click on Folder

Then, Select
Scan QR Code

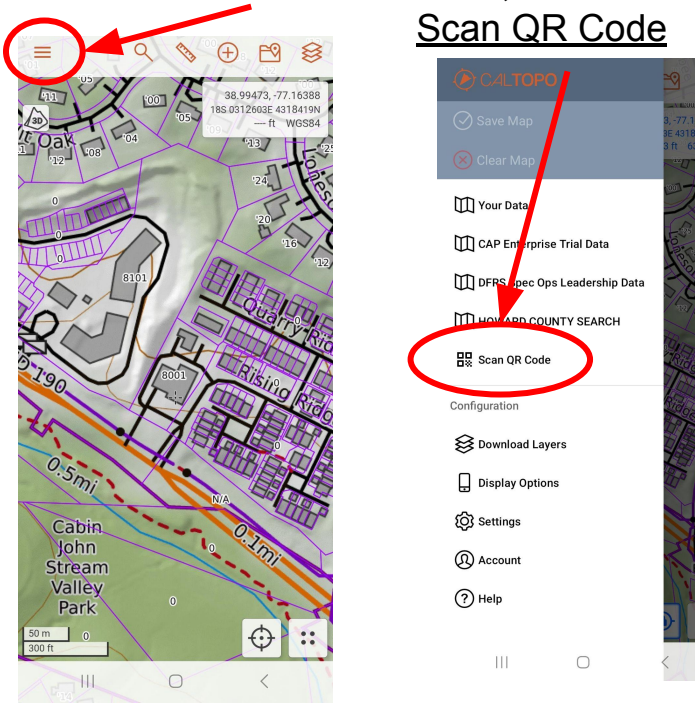

- ❖ Option 2 - Select “Show Details” then “Share”
You can then select either a Shareable Link or QR code and the Permission Type

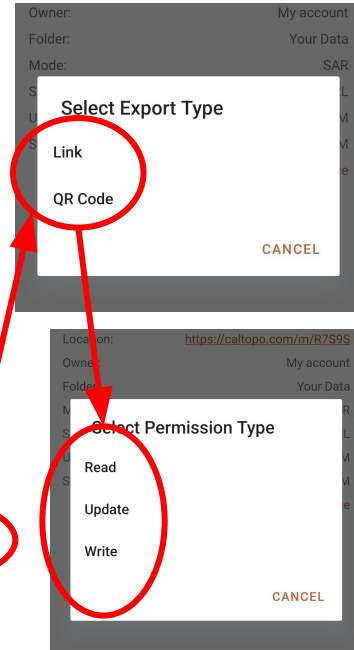
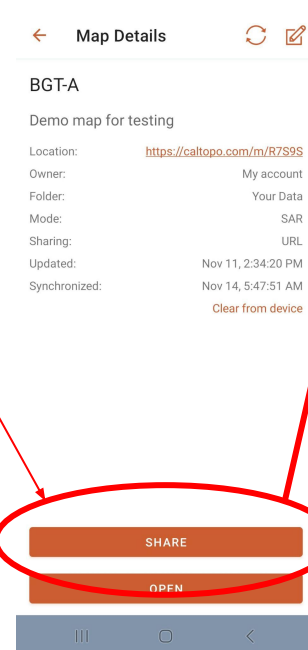
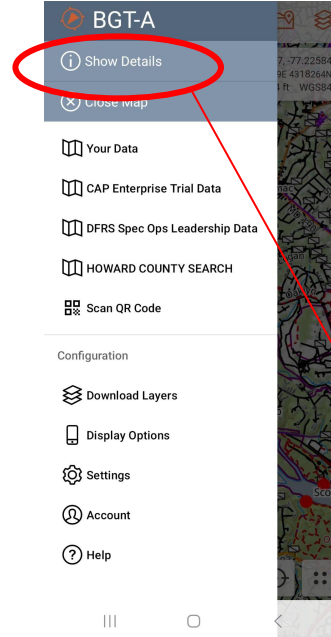

Intro to CalTopo App

- ❖ Find (Location or Coordinates)
- ❖ You can use this feature to enter an address or GPS coordinates

Click on the Magnifying Glass Icon

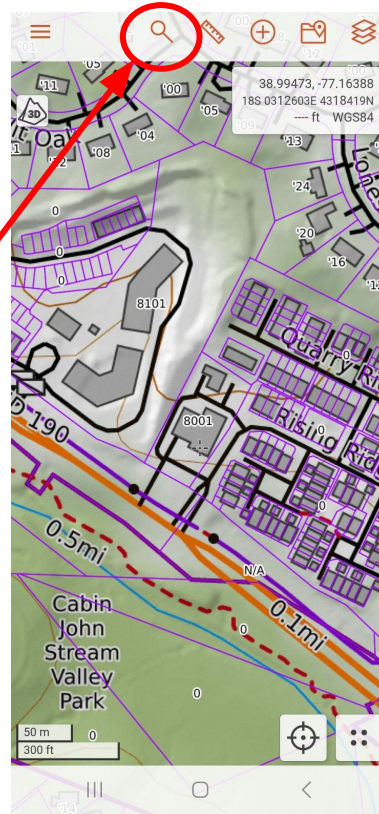

Then enter desired info

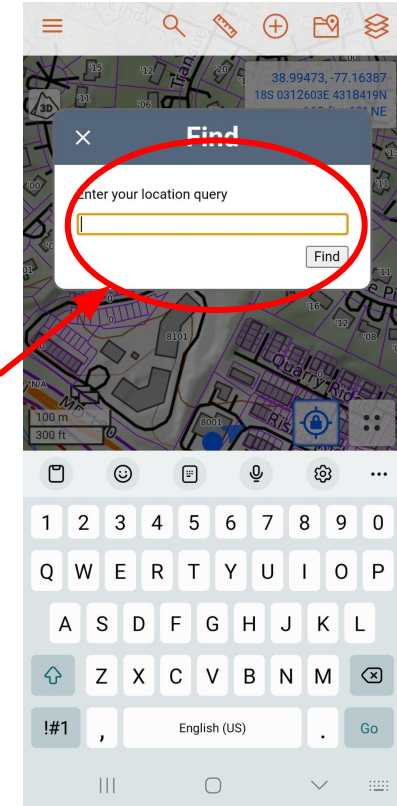

Intro to CalTopo App

❖ Measure (Point, Lines or Polygons)

Click on the Ruler Icon

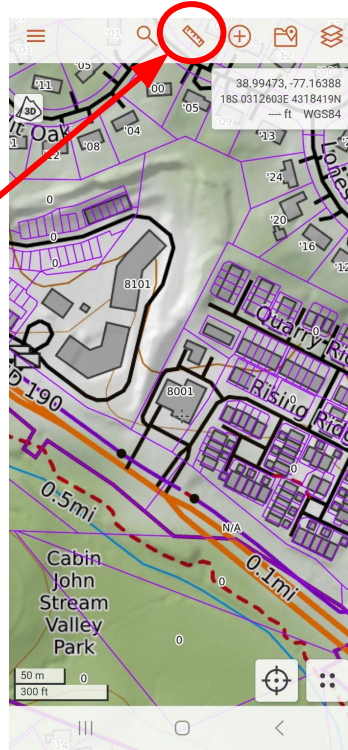

Select from the menu

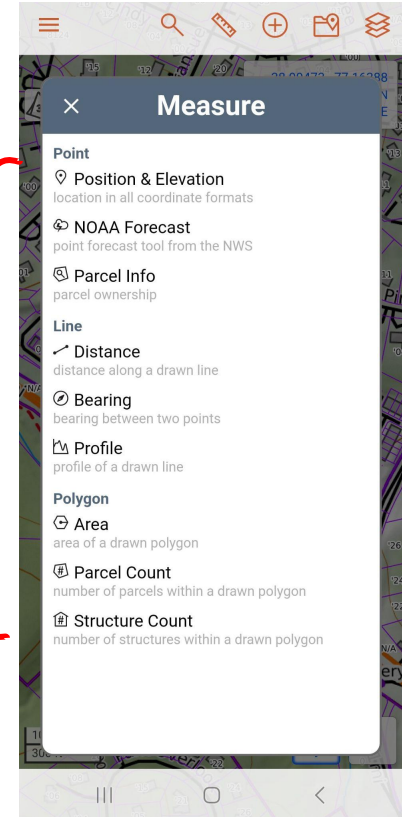

Intro to CalTopo App

❖ Add (Markers, Lines, Range Rings, etc.)

Click on the Plus Icon

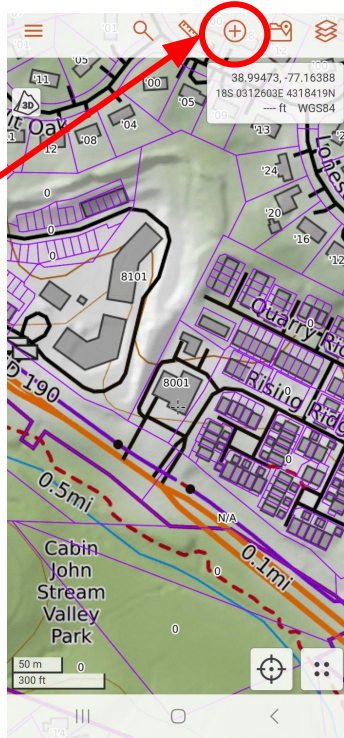

Select from the Menu

Only available with Team Account

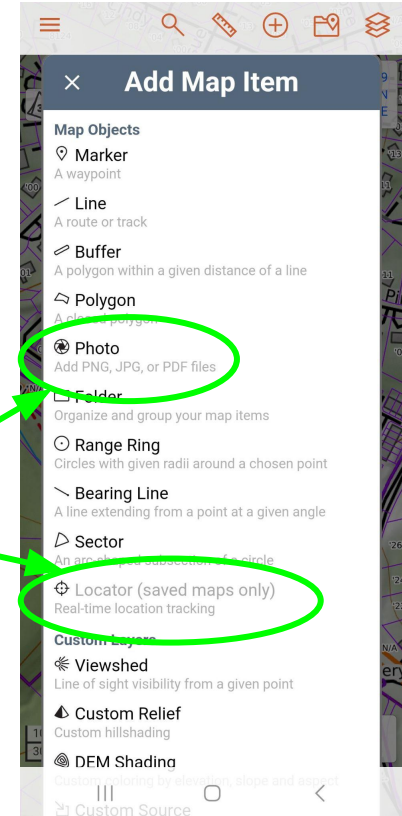

Intro to CalTopo App

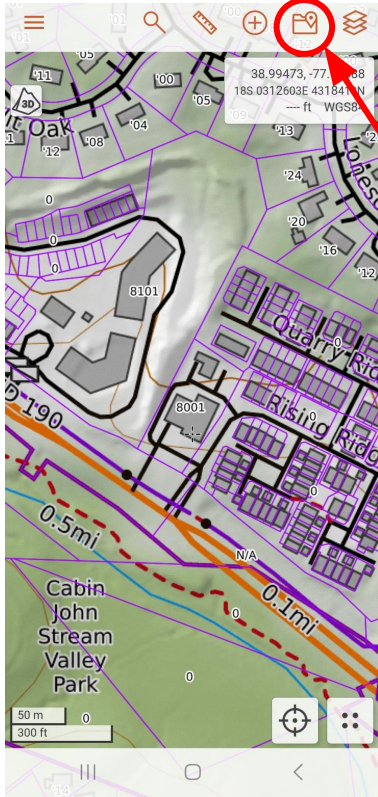

- ❖ Map Items- Anything added to a map can be found here. (Markers, Lines, Tracks, etc)
- ❖ You can select/deselect items as needed to add information or reduce screen clutter

Select Folder Icon

Select/Deselect Items-
You can choose the entire folder
or Individual Items

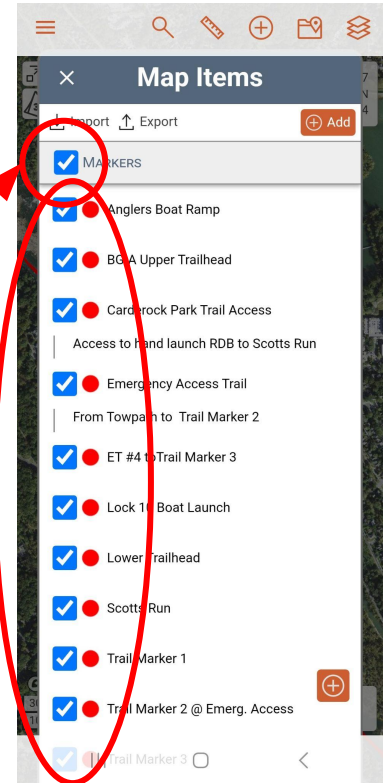

Intro to CalTopo App

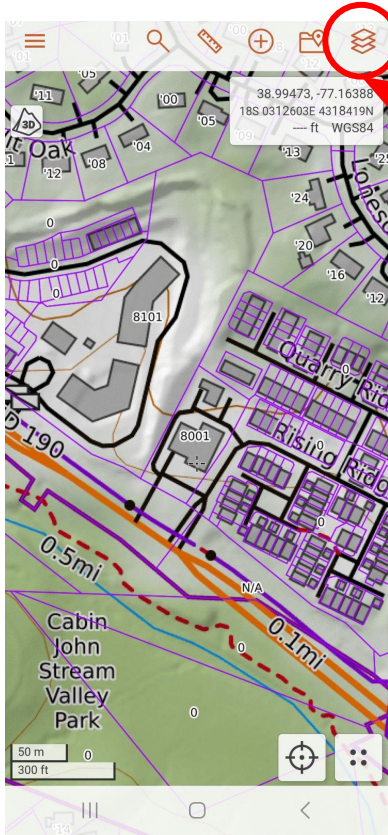

❖ Map Layers

Select stacked sheets icon

- ❖ Base Layers, Map Sheets, Overlays and Other Map View Options can be selected from this location

- ❖ Real Time Data such as aircraft active in the viewing area and River level/flow Data can also be accessed from this location

Only accessible with a Team Account

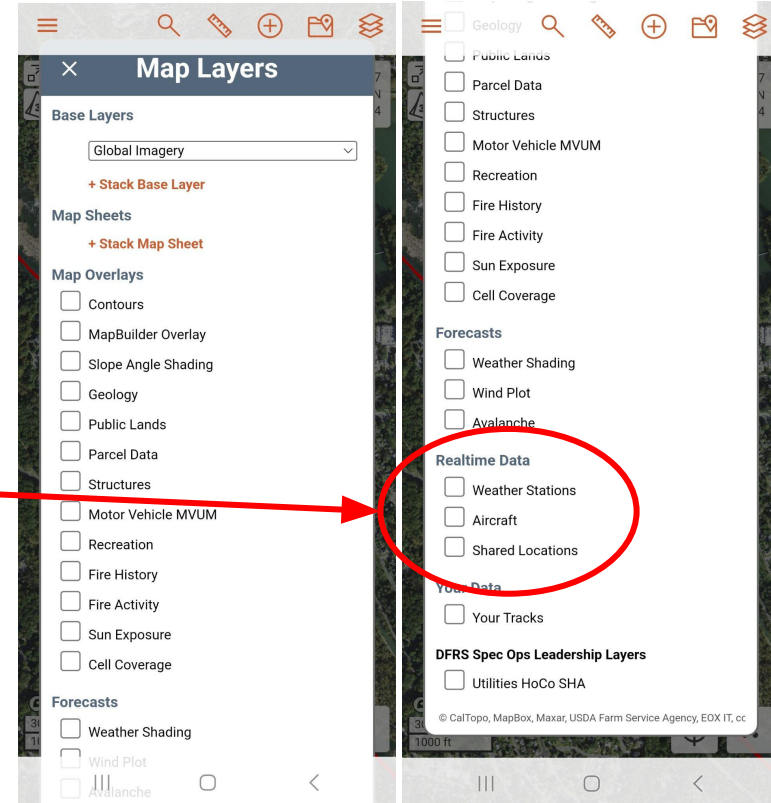

Intro to CalTopo App

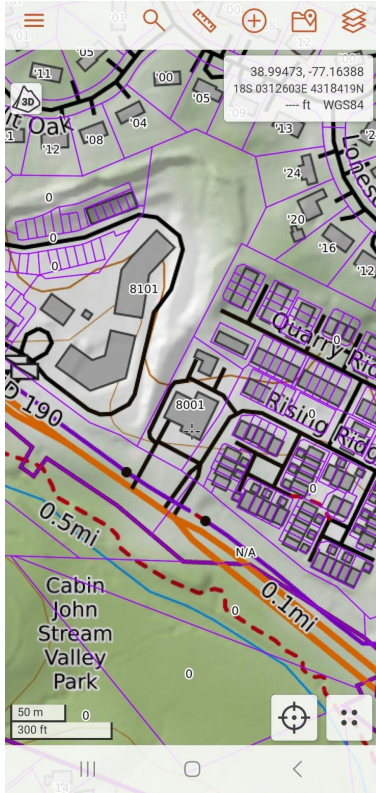

❖ Saving a New Map

- Open the App
- Insert and Save a Marker (See Slide 5)
- Open the File Icon (Top Left) (Slide 7)
- 2 New Options which were Grayed Out are now available. Save Map and Clear Map
- Saving the map will Open the Create Map Screen.
 - Enter a Name for the Map
 - **Change Map Mode to SAR**
 - Save Map to Mont. Co Fire Folder
 - Click OK

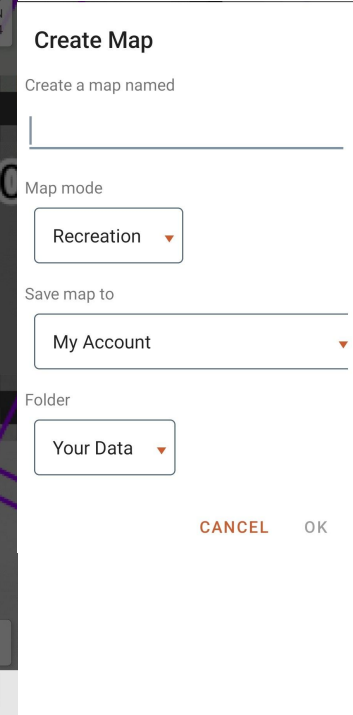
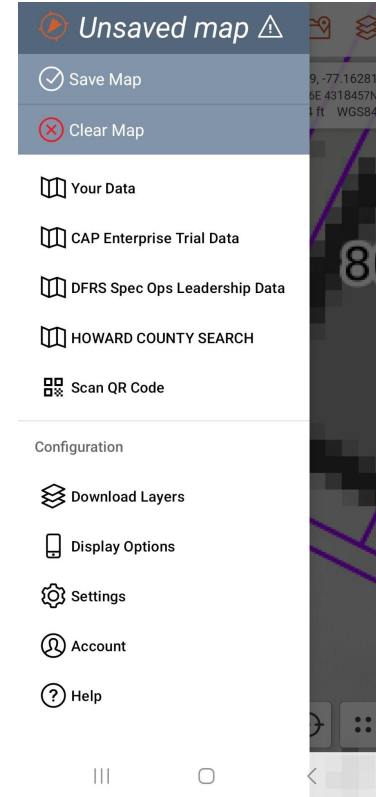

Intro to CalTopo App

Adding a Picture to a Marker

2 Choices- Either from the Photo at GPS or Marker at GPS Icons

Upload Photos

Launch Camera

Select from Gallery

Select File(s)

**** This Feature Only Available w/ Team Account****



Label: Mark 10/15/2024, 4:10:15 PM

Comments:

Coordinates: 38.99473, -77.16388 WGS84

Folder: Markers

Size: Normal

Style:  Color: 

Orientation: N/A

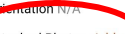
Attached Photos:  Add +

Cancel OK

Intro to CalTopo App

How to Use the Navigation Function

- ❖ Click on Location
- ❖ Select Navigate To or Driving Directions

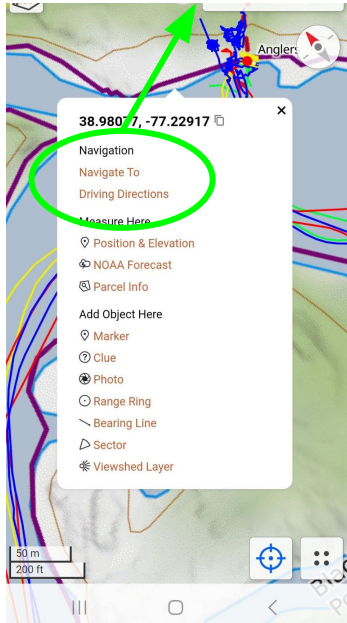

- ❖ Follow Highlighted Line
- ❖ Distance and Bearing will be at Bottom of Screen



- ❖ Navigation Box can be expanded by Clicking on it

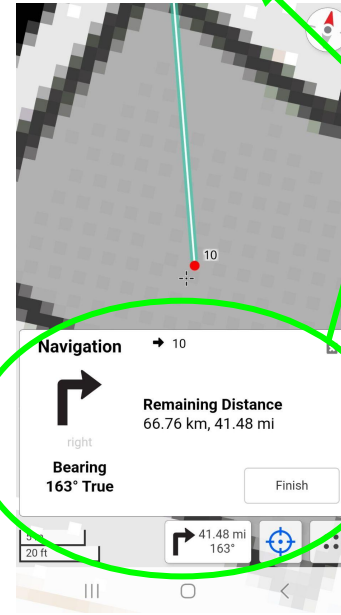

- ❖ To Stop Navigation Click Finish then Stop Navigating

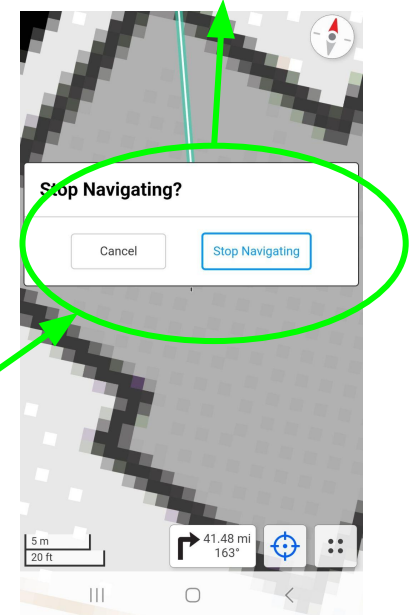

Intro to CalTopo App

SMS Locator Function

What We See vs What They See

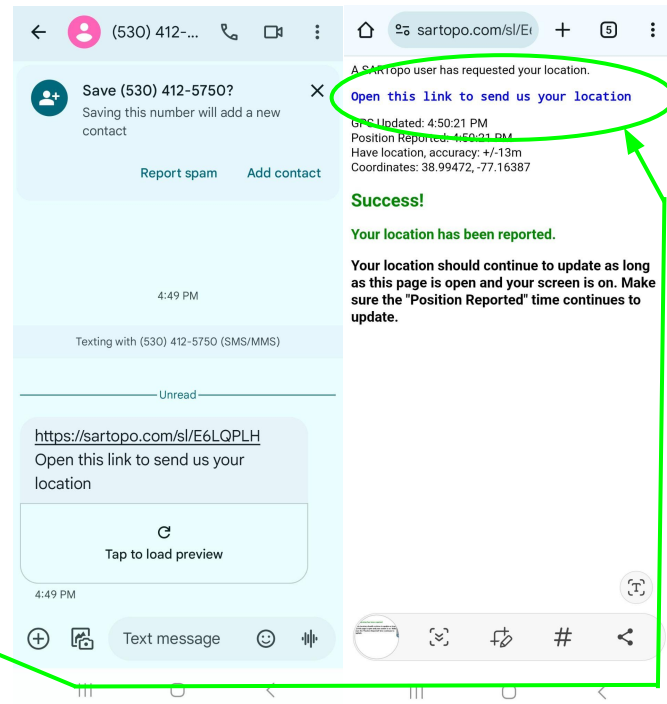
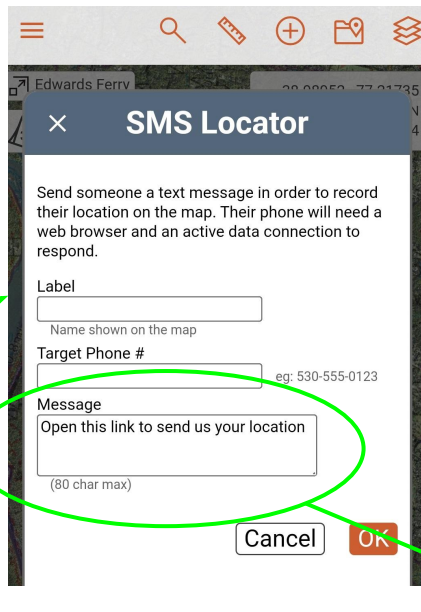
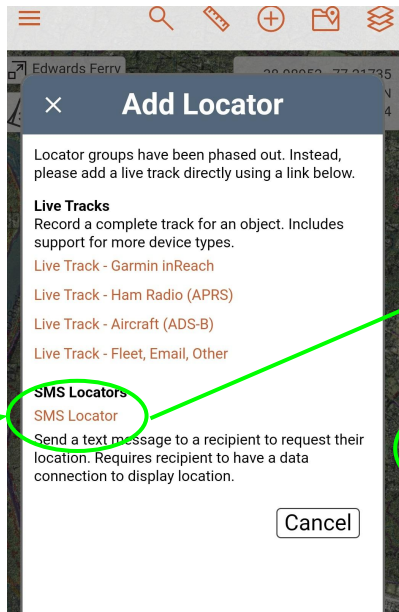
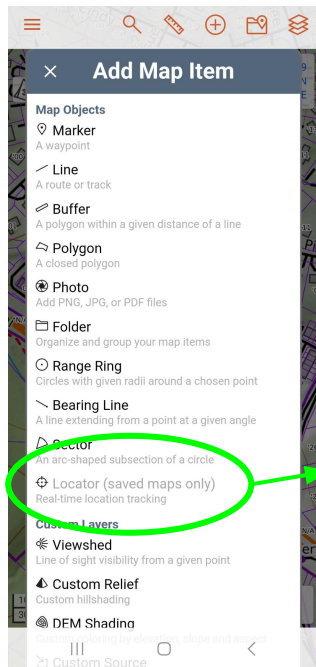

Intro to CalTopo App

What3Words for Android Devices

Open W3W and
enter correct words

Select CalTopo as
your Navigation App

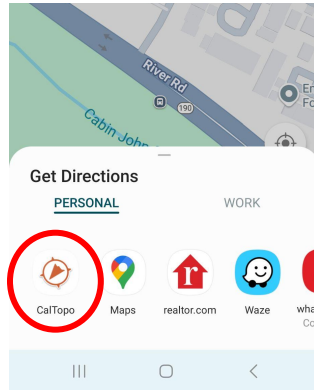
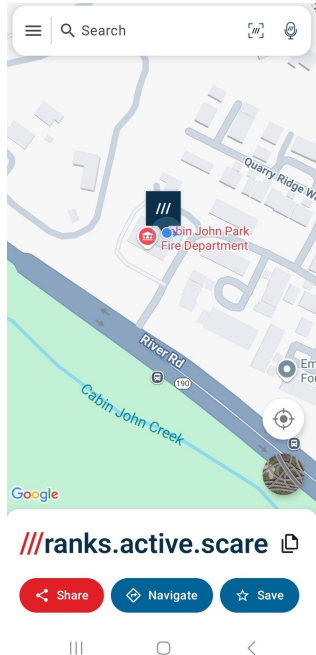

CalTopo App will Open ***Ensure
you are on the correct map***

Click on the Add Icon

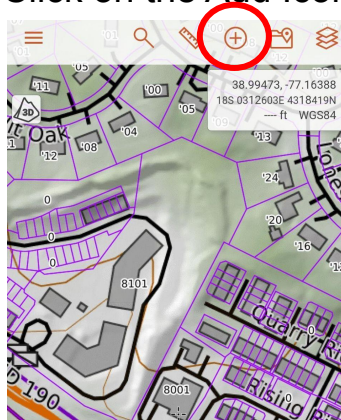

Select Marker

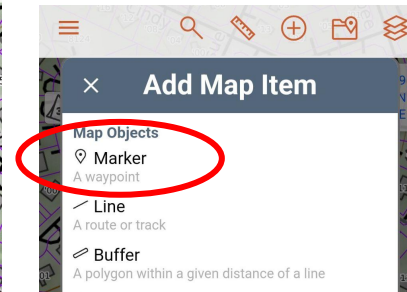

Enter appropriate
Label (Victim, Patient,
Calling Party, Etc.)

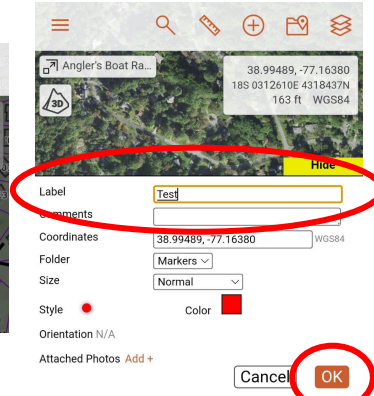

Select OK

OK