

# Maryland Route 200

## Opens November 22 by 0600hrs



2011

# The Yellow Highlighted Section is Currently Open



Montgomery County Fire Rescue  
2011

# The Green Section Will Open November 22<sup>nd</sup> and Link to I-95



Montgomery County Fire Rescue  
2011

# Interchanges

- The temporary ramp at Norbeck Rd is closed
- Full interchanges at:
  - Layhill Rd
  - New Hampshire Ave
  - Route 29
  - I-95
- Partial interchange at Briggs Chaney Rd:
  - From Briggs Chaney to E200 towards I-95
  - From W200 onto Briggs Chaney (from I-95)

## Route 29 Interchange with MD 200

## Orange sections are elevated



Briggs Chaney Rd

Old Columbia Pk

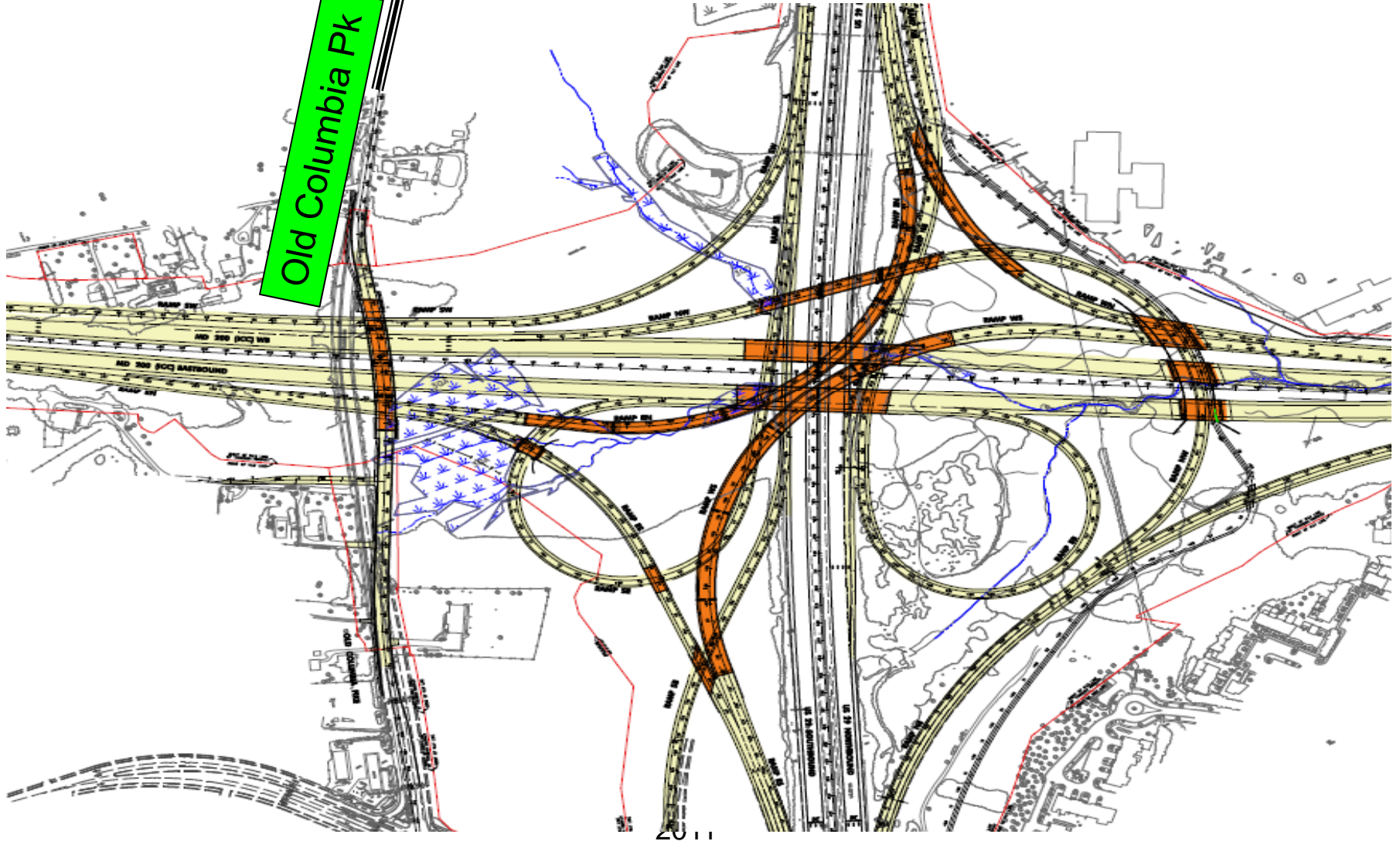

201



15

Briggs Chaney Rd

Station 15's access to  
E200 or W200:

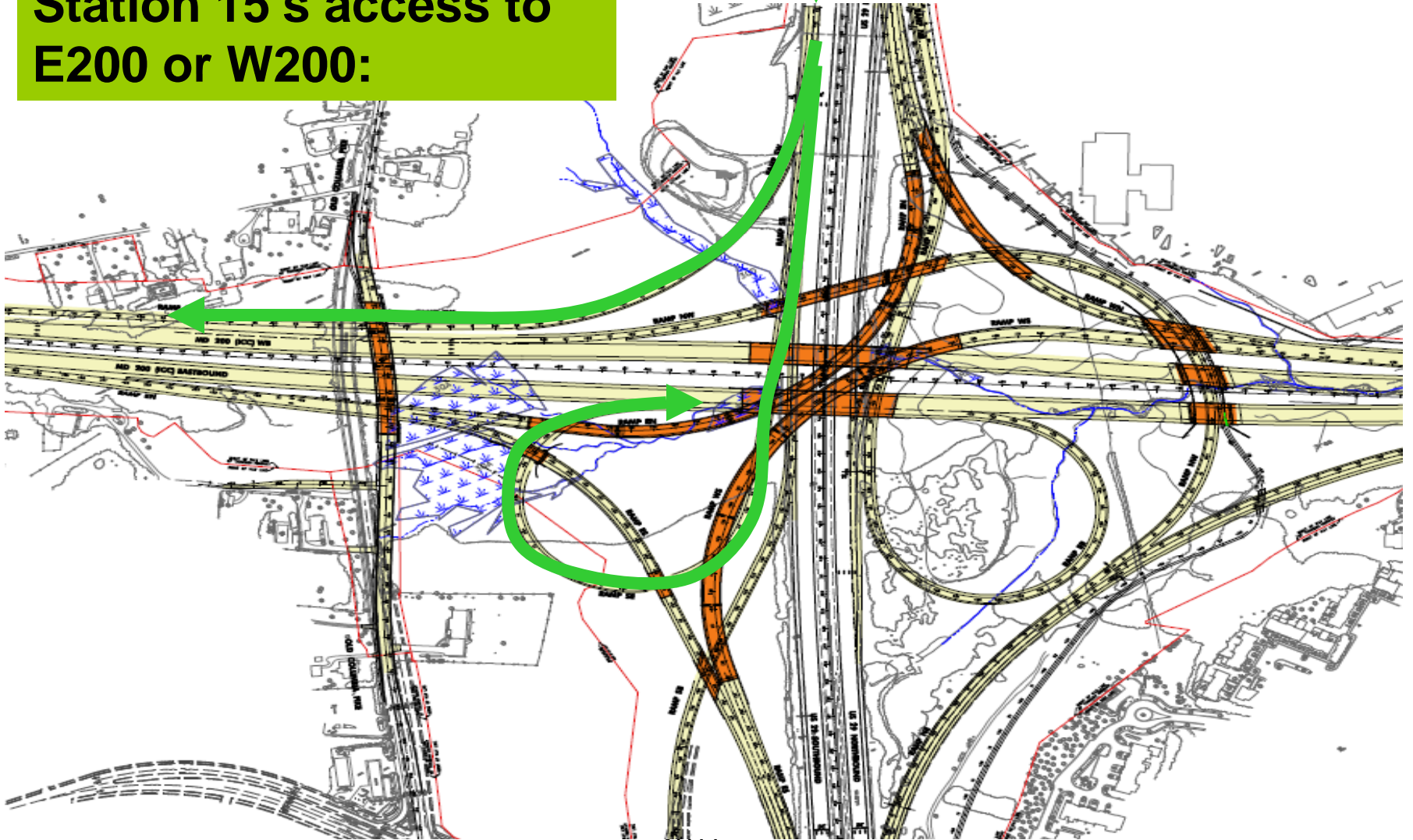

# Route 29 / MD200 Interchange (from Station 15's perspective)





# Partial Ramp System at Briggs Chaney Rd

- W200 can exit at Briggs Chaney Rd
- Briggs Chaney Rd can access E200

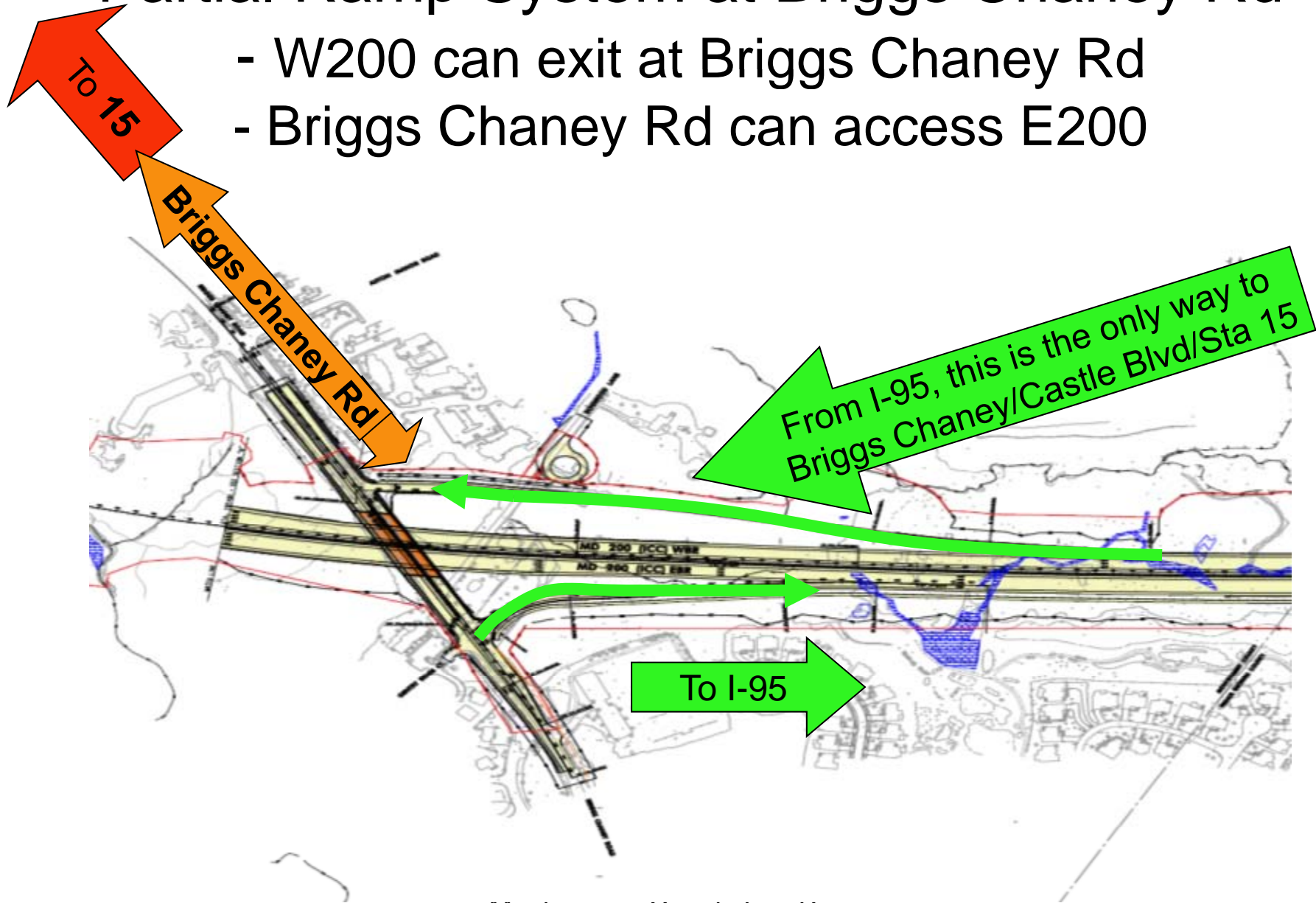



# Turning Around at I-95



Montgomery County Fire Rescue  
2011

# Turning Around at I-95

- All lanes will move right – POV's must take ramp to I-95 north or south
- **Stay to the left**, go around barricade
- Go over I-95, take Contee Rd exit, then take exit for Westbound 200

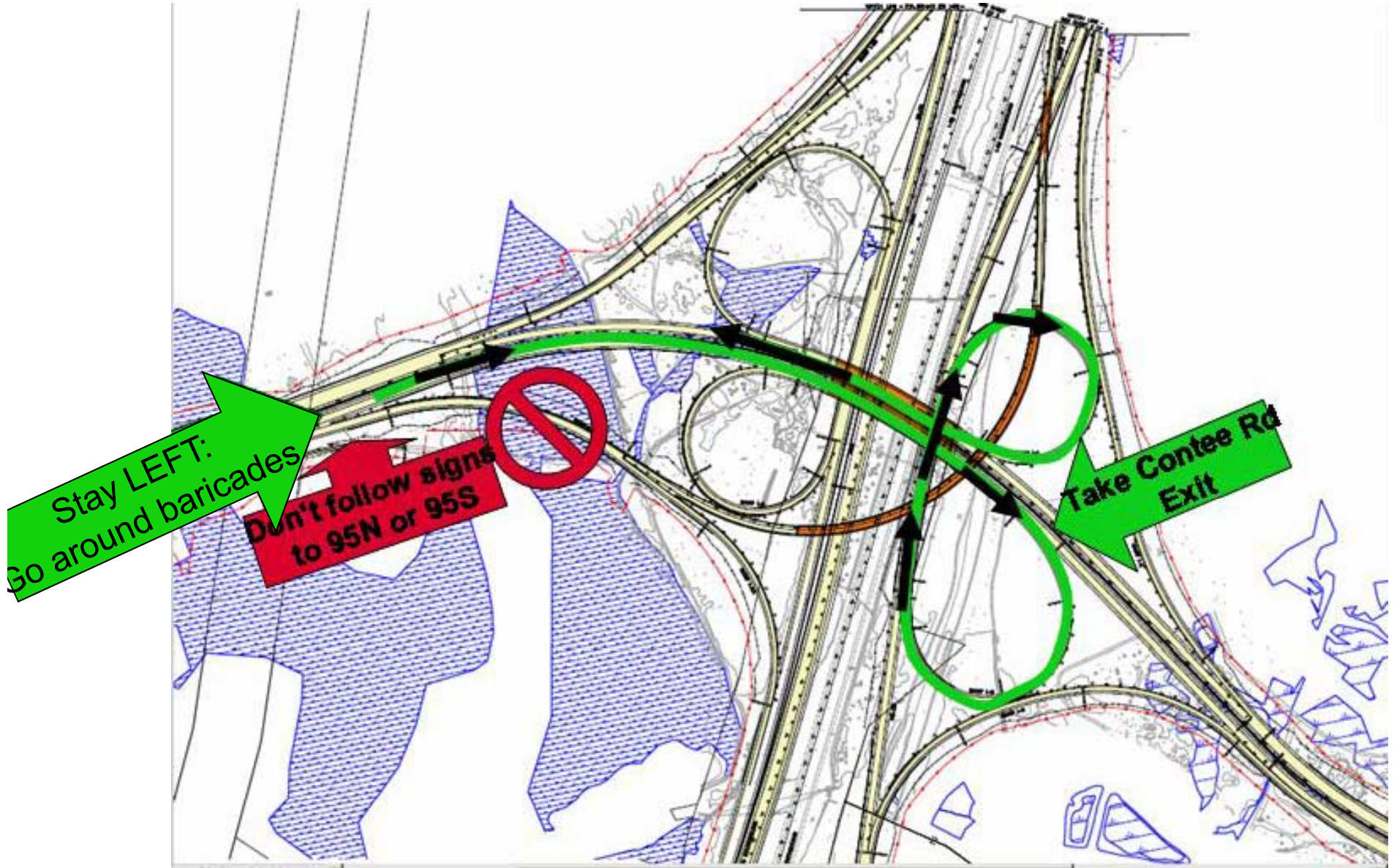



# Water Supply



Montgomery County Fire Rescue  
2011

# Water Supply

- There are hydrants in the right-of-way (ROW) at:
  - Norbeck Rd
  - Longmead Crossing Dr
  - Layhill Rd
  - Bonifant Rd
  - Notley Rd
  - New Hampshire Ave
  - Old Columbia Pike
  - Briggs Chaney Rd
  - Old Gunpowder Rd

# Hydrants in the ROW

- The hydrants in the ROW don't currently show up on the MDC mapping
- They should be on the next map build-out in April 2012
- There are hydrants at EVERY road that crosses over or under the ICC, EXCEPT Needwood Rd and Shady Grove Rd



# Noise Barriers



Montgomery County Fire Rescue  
2011

# Noise Barriers

- The walk-through doors are all keyed the same
- Every engine should have a key on their Knox key ring
- Most walk-through doors also have dry 4" Storz connections

# Noise Barriers

- Just because there is a door and a Storz connection does NOT mean there is a hydrant on the other side





# Hydrants Outside of the ROW

- It may be necessary to use a hydrant outside of the ROW
- The MDC is the best way to find a hydrant
- Review MDC Tech Training to refresh on “Follow Me” function to locate closest hydrants to a current location.

# Bridges

Montgomery County Fire  
2011



# Bridges

- Several bridges are over 1000' long
- They are over rugged, wet, stream valleys
- There is no vehicle access below, probably not even ATV's
- Any incident with a person or vehicle over a bridge will be highly technical and labor intensive



# Bike Path

- The bike path uses a variety of designs:
- Some in the ROW
- Some just outside the ROW
- Some parts of the path use existing bike lanes and sidewalks away from the ROW
- No bike paths in the park areas under the bridges

# Red Highlight Shows Bike Path in the ROW

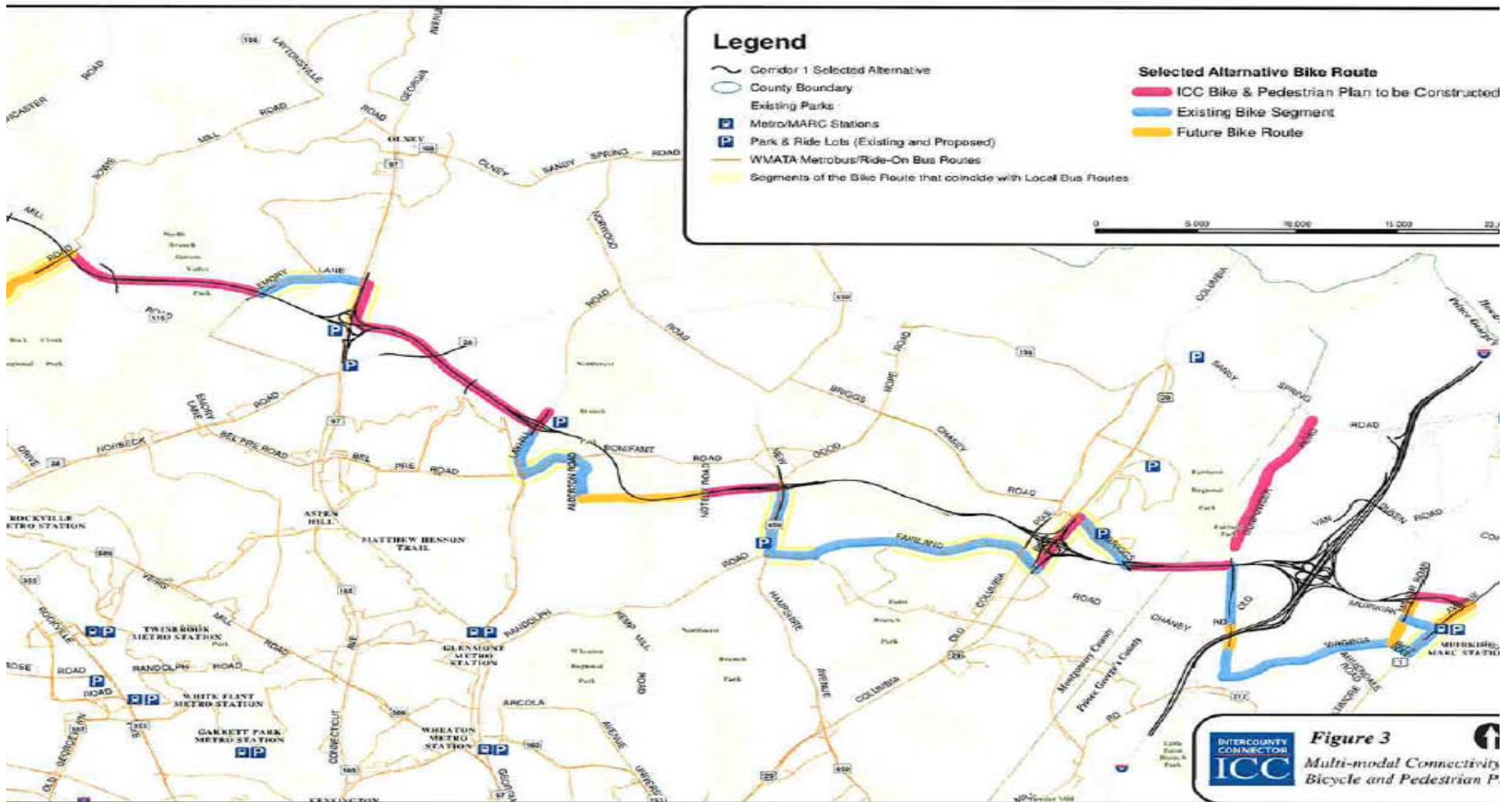

# EZpass

- Every Fire Rescue vehicle should have an EZpass assigned
- Unlimited free travel on the ICC with public safety EZpasses
- EZpasses should be part of your inventory checks

# Tolls

- For your POV's:
  - The ICC will be toll-free until December 4<sup>th</sup>
  - Rates are based on time of day, and the distance driven.
  - Maximum 2-axle toll from I-95 to I-370 is about \$4
  - You must have an EZpass to use the road, or a “convenience fee” is added when they send you a bill



# More information:

- [ICCproject.com](http://ICCproject.com)
- [Zoomable map of Contract B](#)
- [Zoomable map of Contract C](#)
- [Maryland E-ZPass information](#)
- [Maryland Transportation Authority](#)

# Route 29 / MD200

## Looking northeast







# MD200 / I-95 (looking north)

Note “collector-  
distributor” lanes  
on I-95

# MD200 / I-95 (looking south)

Note “collector-  
distributor” lanes on  
I-95

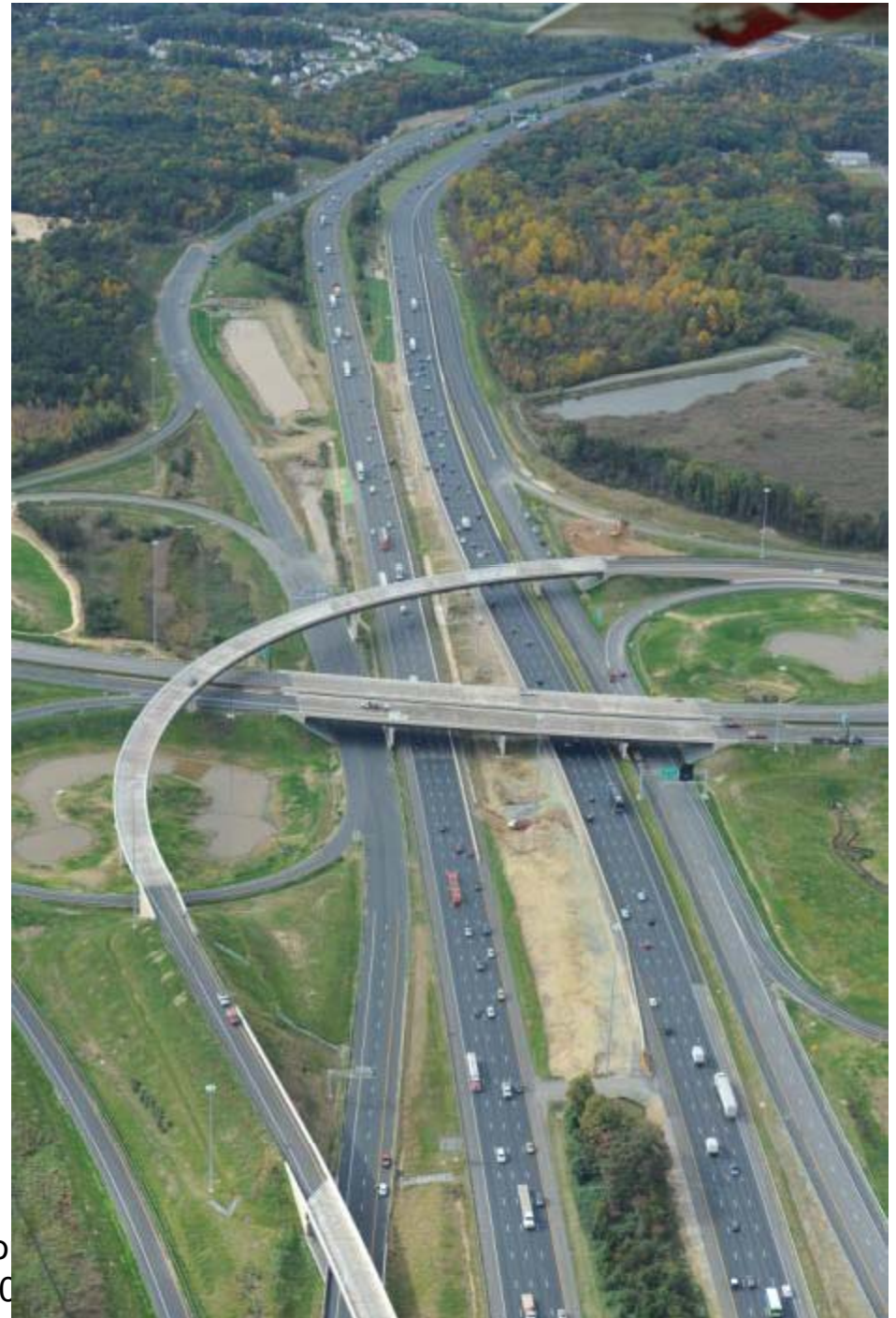



# Route 29 / MD200 (Looking northeast)

