



**SILVER SPRING CITIZENS ADVISORY BOARD**  
**SEPTEMBER 23, 2019**



**Chris Stokes**  
PLTC Communications

**Ken Prince, PE**  
PLTC Project Construction Manager

**Larry Moritz, RA**  
PLTC Sr. Architect Design/Build Coordinator



## AGENDA

- Purple Line Overview
- Construction Update for:
  - Lyttonsville
  - Silver Spring
    - Spring Street Detour
    - Wayne Ave. Bridge over Sligo Creek Phasing
  - Long Branch
- Landscape Plans/Details
- ADA Compliance



# PURPLE LINE OVERVIEW

- 16.2-mile light rail providing east-west transit connection between Bethesda and New Carrollton
- 21 Stations
- Connections to:
  - 4 Metrorail Stations
  - All 3 MARC Lines
  - Amtrak's NE Corridor
  - Region's largest transit centers
  - MD's flagship university

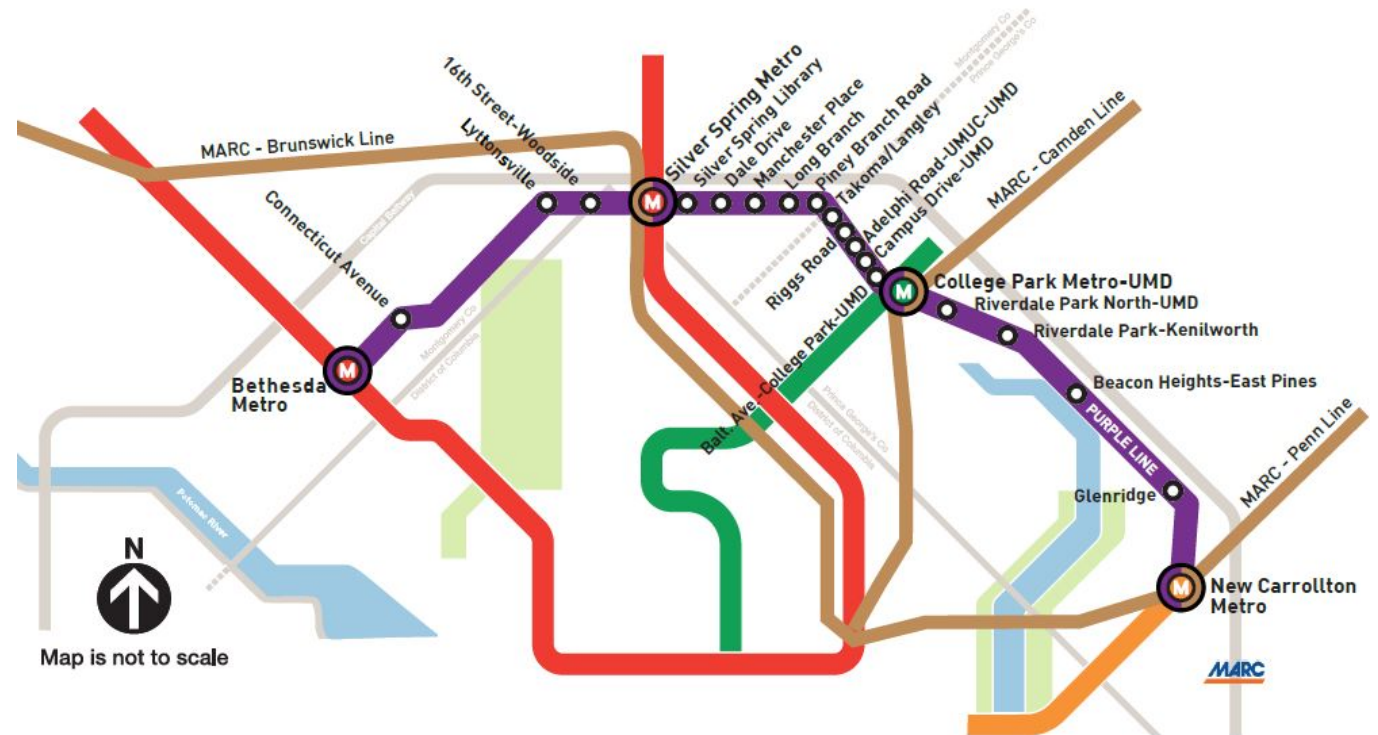





# PURPLE LINE ALIGNMENT

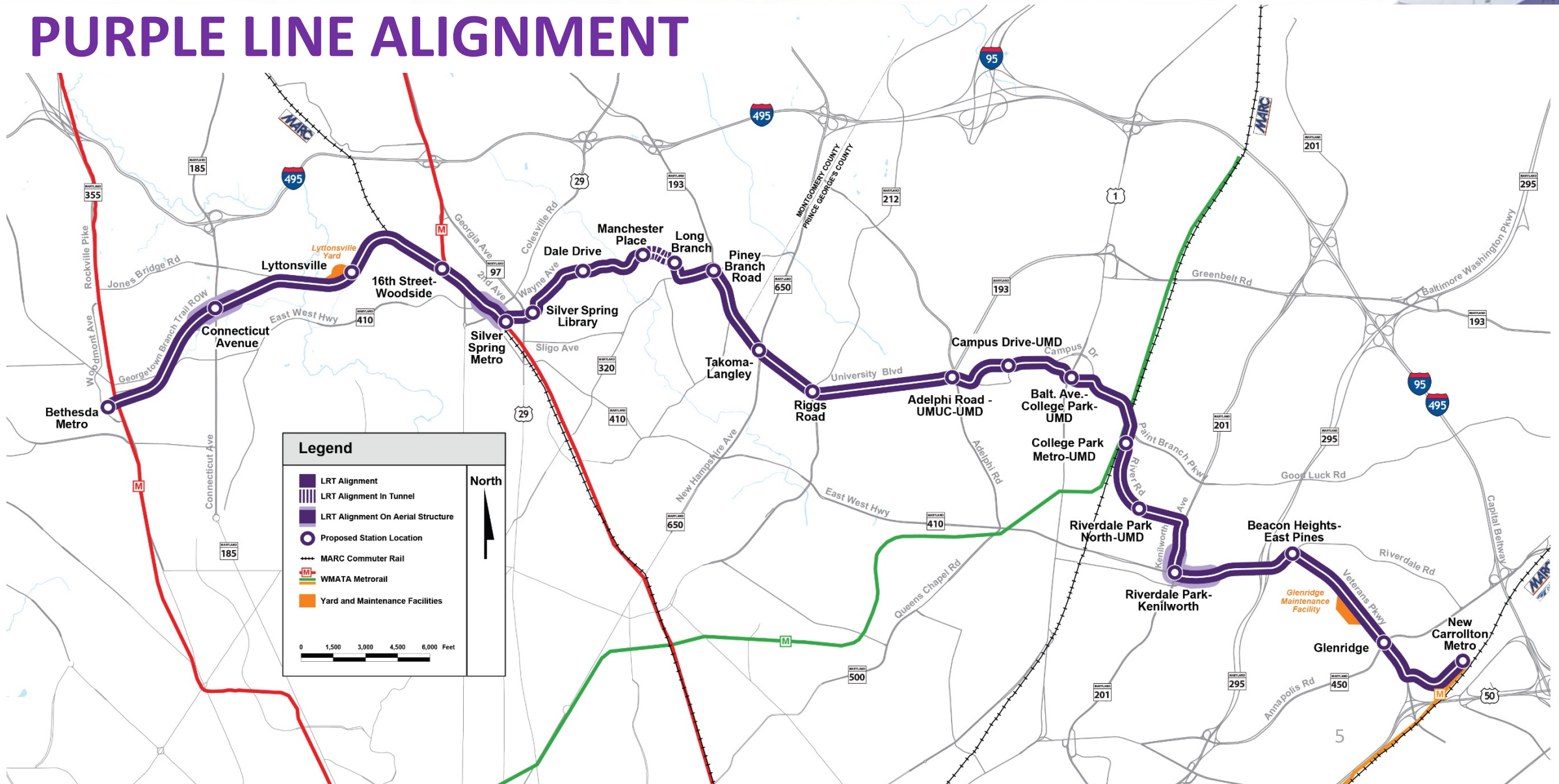



## LIGHT RAIL VEHICLE (LRV)

- Quiet and modern, vehicles are 5 modules each spanning a total of 140 feet long (longest in the USA)
- Designated spaces for persons in wheelchairs or other mobility devices
- With low level boarding and wide doorways it is designed in accordance with latest ADA Accessibility Specifications for Transportation Vehicles
- On-board storage for bicycles will be available
- Comfortable, well-lit interiors







## LRV STATUS

- The LRV's are being assembled in Elmira, NY
- The first complete LRV is in testing in Elmira
- More than 20 modules are assembled (there are 5 modules per train)





## PURPLE LINE PROJECT UPDATE

- The Purple Line is being delivered as a Public-Private Partnership (P3) to finance, design, construct, operate, and maintain
- Construction is underway throughout the 16.2-mile corridor
- 12 of 16.2 miles have active construction work
  - Construction: 17% complete
- Approximately 750 Craft men and women are now working on construction of the Purple Line





## LYTTONSVILLE PROGRESS

With the removal of the undersized Talbot Avenue bridge work can start on the new wider bridge.

- Tree Clearing
- Utility relocations
- Pile driving along CSX tracks
- Retaining walls adjacent to Rosemary Hills School







## SILVER SPRING PROGRESS

Foundation piers are underway along 16<sup>th</sup> St. for the bridge that will carry the Purple Line over the WMATA's Red Line and Marc tracks to the Silver Spring Metro Station at the Silver Spring Transit Center.







# SILVER SPRING TRANSIT CENTER PROGRESS

Silver Spring Transit Center Phase I work zone was established June 2019 for the construction of the Purple Line Silver Spring Metro Station. Work in the area has included:

- Utility relocations
- Installation of stormwater management facilities
- Foundation caisson installation







## SILVER SPRING INTERNATIONAL MIDDLE SCHOOL PROGRESS

Parking lots and pedestrian walkways are open for the 2019 school year but not in their final condition. Work in the area has included:

- Retaining wall installations
- Stormwater drainage







## LONG BRANCH - MANCHESTER PLACE STATION PROGRESS

Foundation work for the future Manchester Place Station is pictured. Ongoing work there includes:

- Waterproofing
- Concrete placement







## LONG BRANCH – PLYMOUTH PROGRESS

The 1,000-foot Plymouth St. Tunnel excavation was completed in March of 2019. Since then waterproofing and final concrete for tunnel lining has been ongoing.







## 6-MONTH LOOK AHEAD – LYTTSONVILLE

### **Lyttonsville**

- Begin Lyttonsville Station construction
- Retaining wall construction continues
- Storm drainage installation

### **Talbot Avenue Bridge**

- Talbot Bridge foundation work for abutments continues
- Utility relocation continues
- Retaining wall construction underway
- Tree clearing, CSX North Corridor
- CSX spur track construction



## SPRING STREET DETOUR

- Estimated work to commence Spring 2020
  - Closure duration limited to 7 months
- Spring St. will be closed between 16th St. and 2nd Ave.
  - Drivers traveling north on 16th St.
    - Continue north on 16th St.
    - Turn right on Georgia Ave to Spring St.
  - Drivers traveling south on Spring St.
    - Turn left on 2nd Ave.
    - Turn right on Colesville Rd.
    - Turn right on East-West Hwy.
    - Turn right onto 16th St.

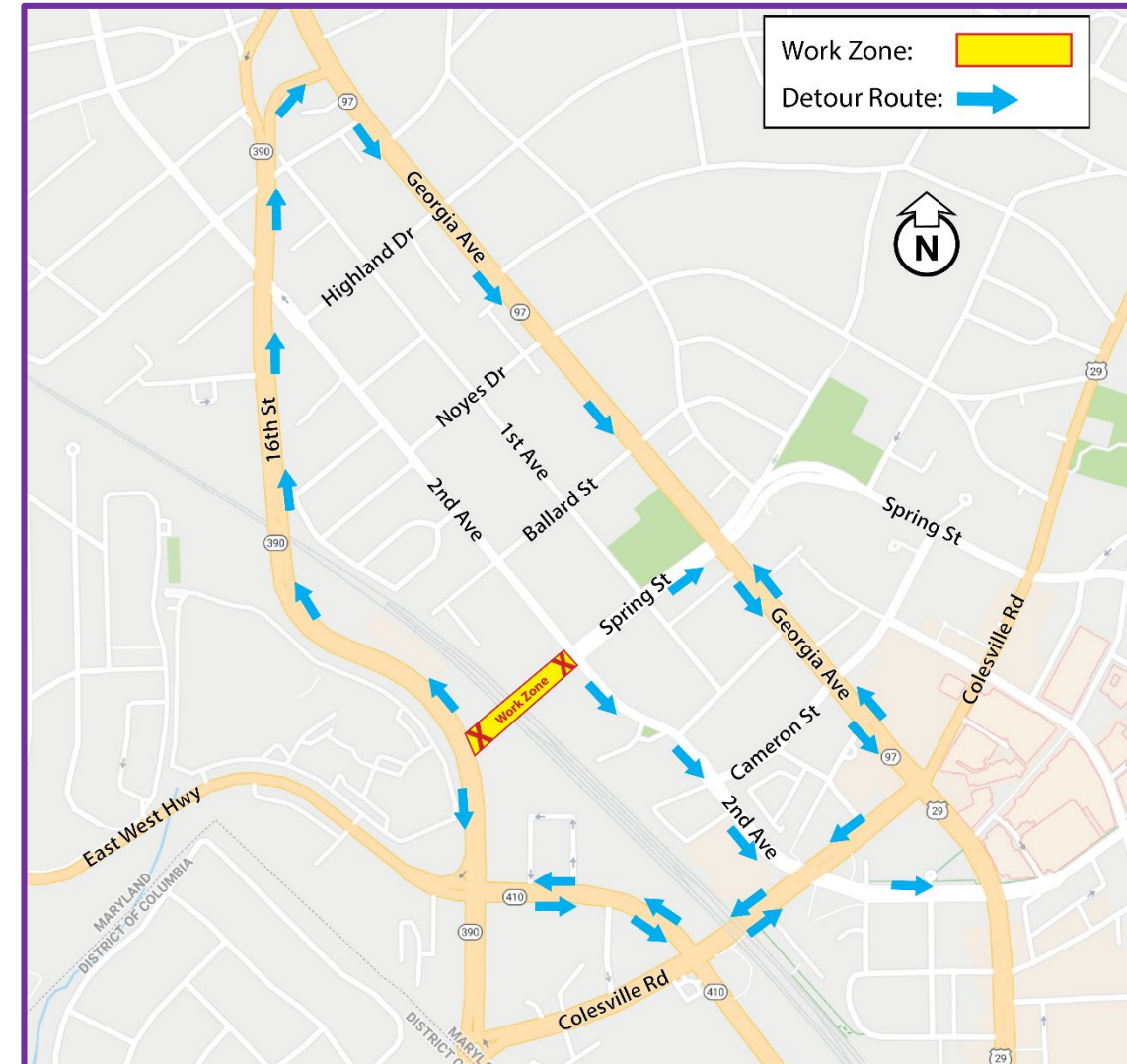



## 6-MONTH LOOK AHEAD – SILVER SPRING

### **Silver Spring Transit Center Light Rail Vehicle (LRV) bridge**

- LRV bridge substructure work continues
- SSTC LRV bridge girder erection
- CCT bridge truss erection across Colesville Rd.
- Storm drainage installation continues





# SILVER SPRING TRANSIT CENTER

**Phases I and II** are active work zones

**Phase III** Dec 2019

**Phase IV** is scheduled for  
Dec 2019 to March 2020

**Phase V** – Oct 2019 to March  
2020

**Phase VI** – Winter 2020

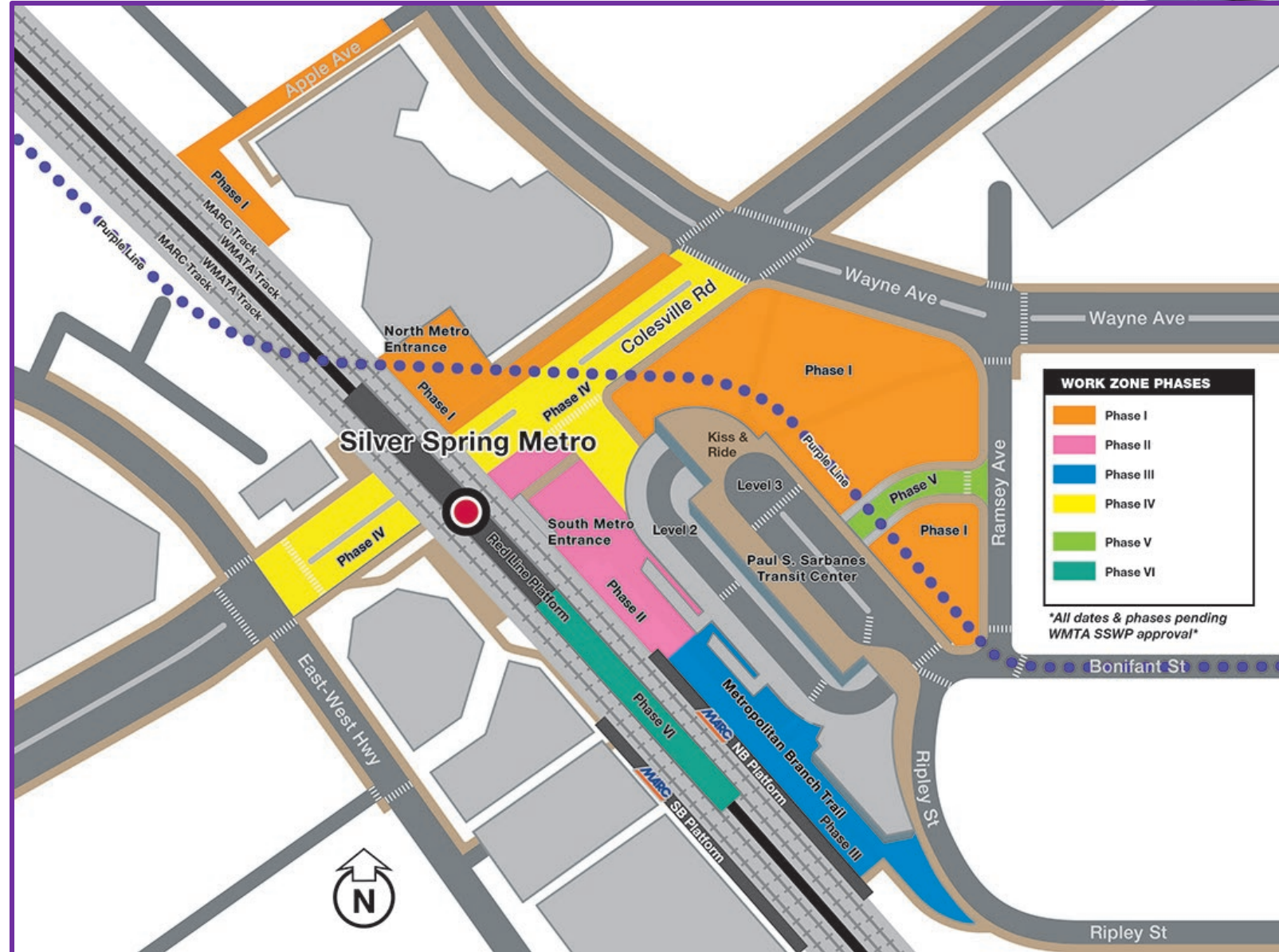



## BONIFANT STREET (WEST) LONG-TERM CLOSURE

- Closure scheduled for Spring 2020
- Once reopened, Bonifant St. will permanently be a one-way street (westbound)
- 30-day notice will be provided via PLTC's notification system
- Local access will be maintained for pedestrian and vehicular traffic to parking garages and surrounding buildings

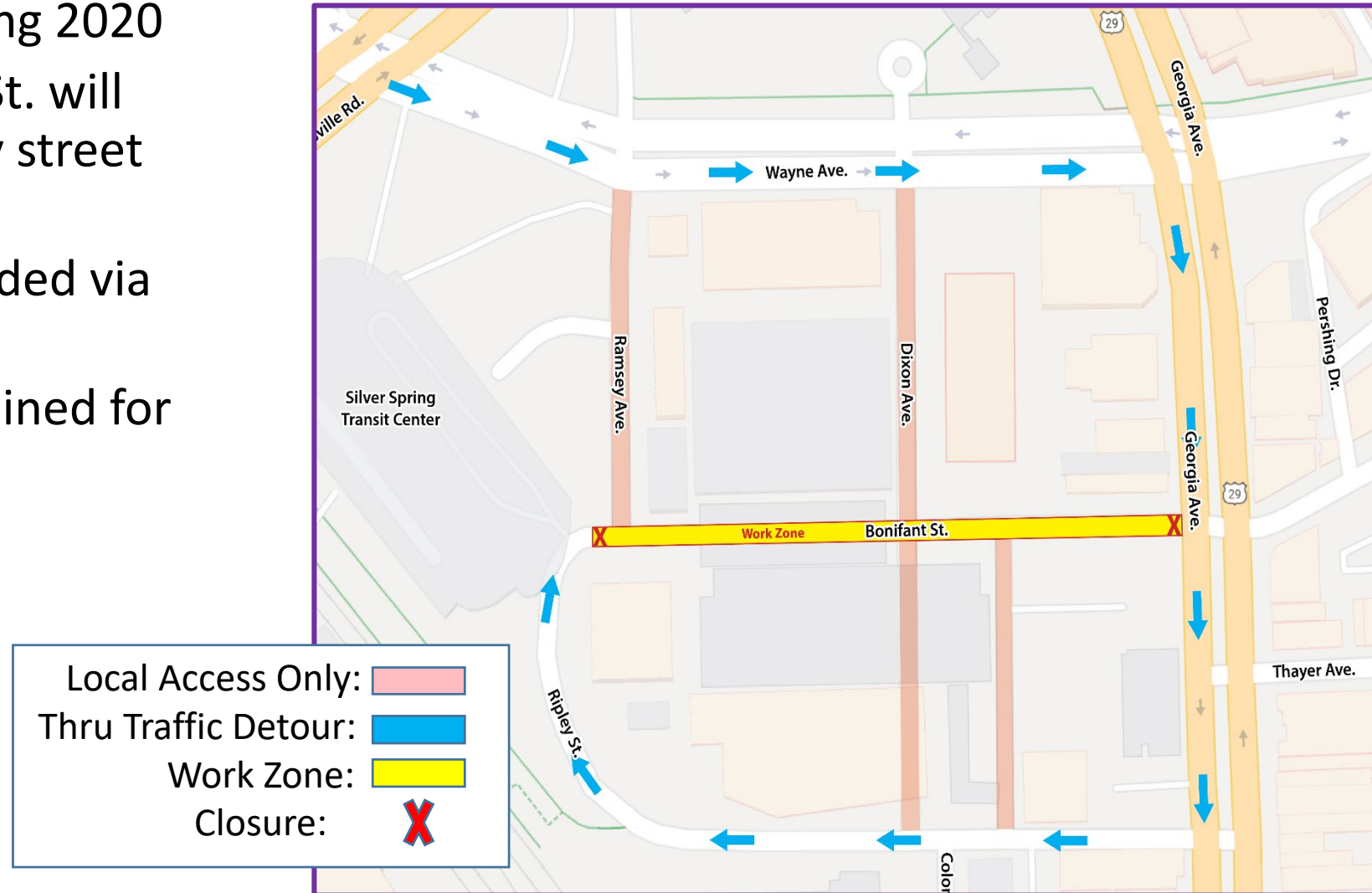





## BONIFANT STREET (EAST) LONG-TERM PARTIAL CLOSURE

- Winter 2020
- Bonifant East will operate as a one-way street eastbound
- Westbound direction will be closed as a Work Zone
- There will be pedestrian walkways with safety fencing to separate Work Zone from pedestrians
- Local access to businesses will be maintained

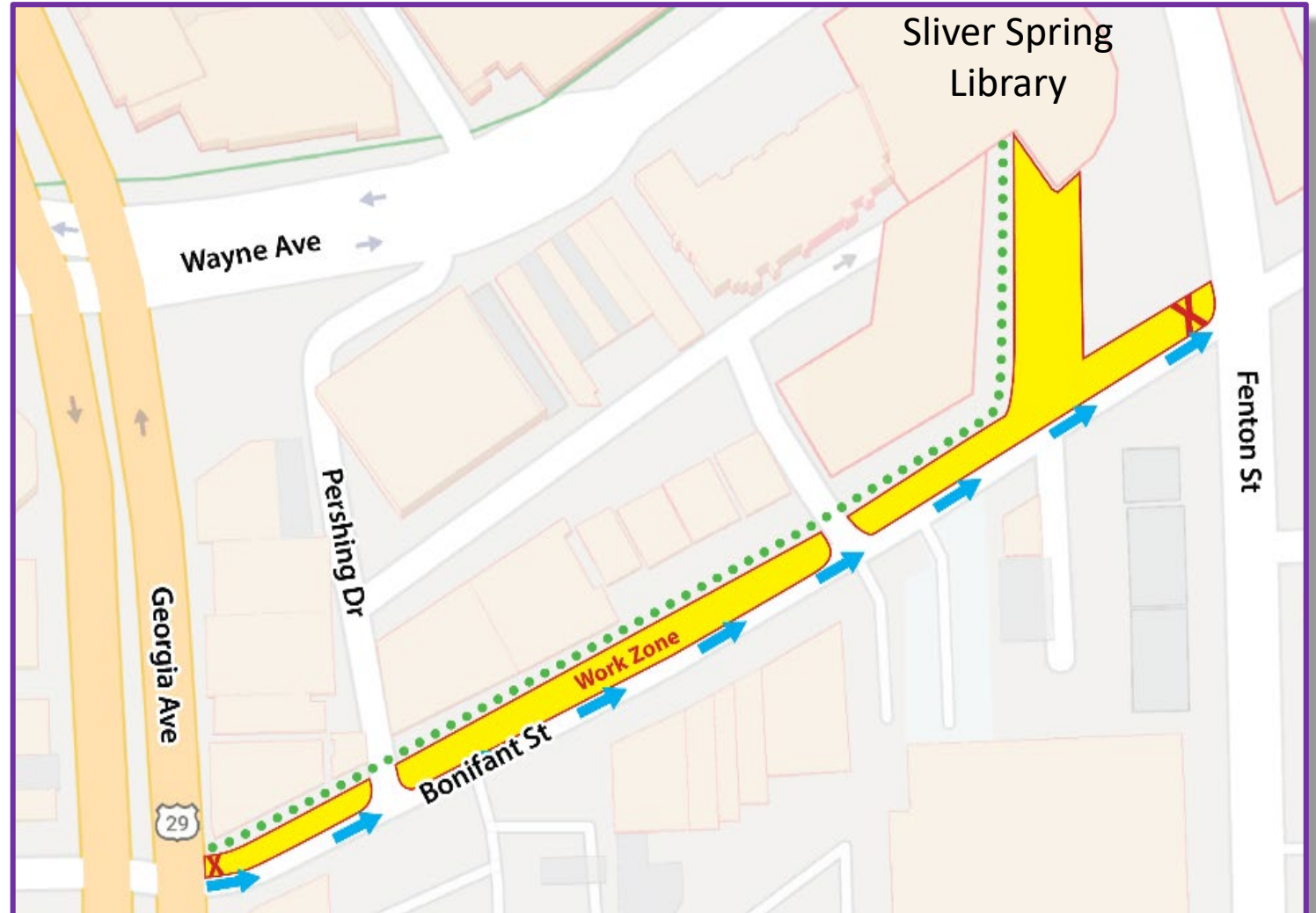
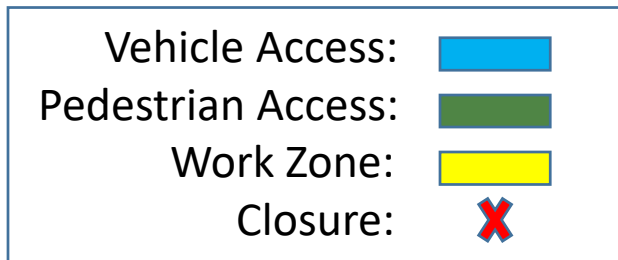



## 6-MONTH LOOK AHEAD – SILVER SPRING

### **Silver Spring – Wayne Ave.**

- Overhead utility relocation along Wayne Ave., Fenton to Manchester
- Underground utilities relocation
- Storm drainage installation
- Sligo Creek Bridge – Phase 1 construction

### **Silver Spring International Middle School**

- Parking lot construction continues
- Retaining wall construction continues



## PHASING OF WAYNE AVENUE OVER SLIGO CREEK



### Phase 1 – Winter 2020

- Traffic is reduced to one lane in each direction
- Traffic is shifted to the south side of Wayne Ave.
- Access to Sligo Creek Pkwy. is limited
- First half of the Wayne Ave. bridge constructed





## PHASING OF WAYNE AVENUE OVER SLIGO CREEK

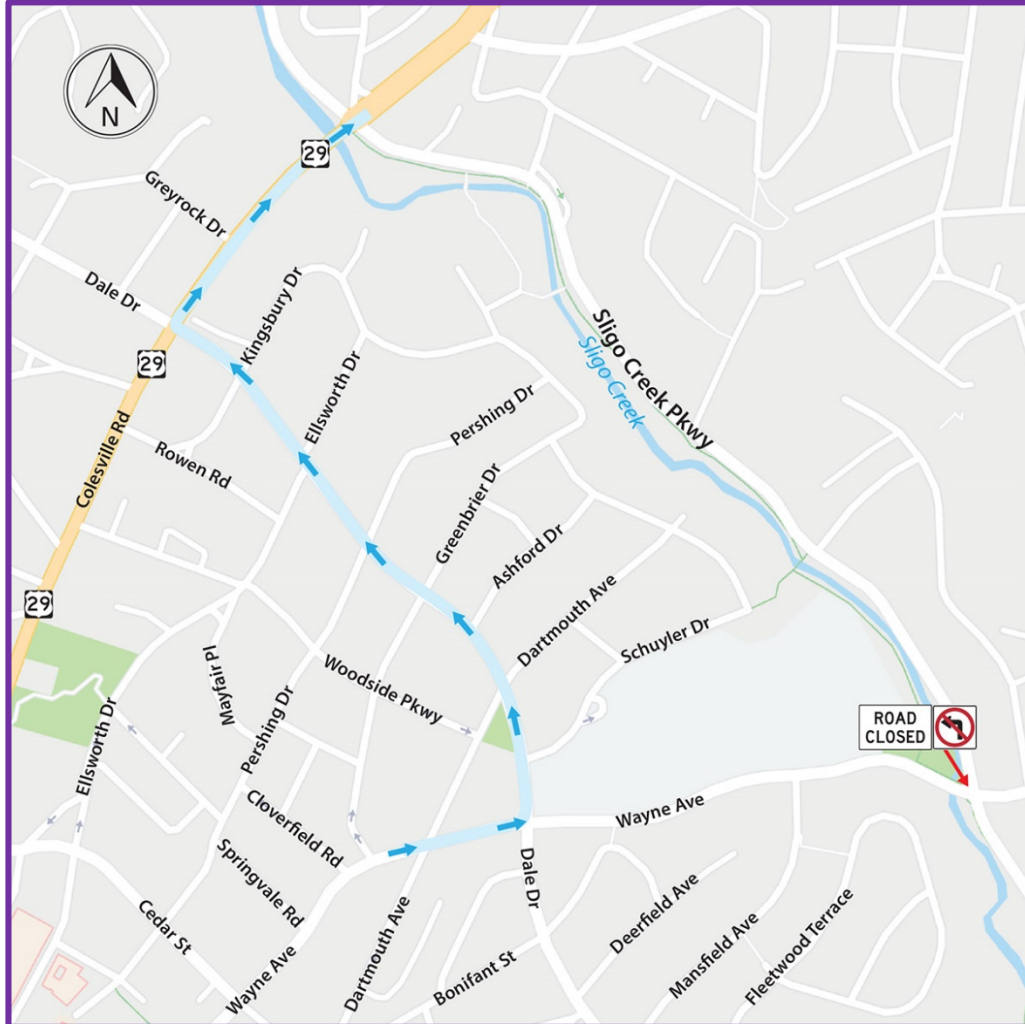

### Phase 1 – Winter 2020

- Sligo Pkwy. access limited with no left turn off Wayne Ave.
- Detour for left turn off Wayne Ave.
  - Turn left on Dale Dr.
  - Turn right on Colesville Rd.



## PHASING OF WAYNE AVENUE OVER SLIGO CREEK

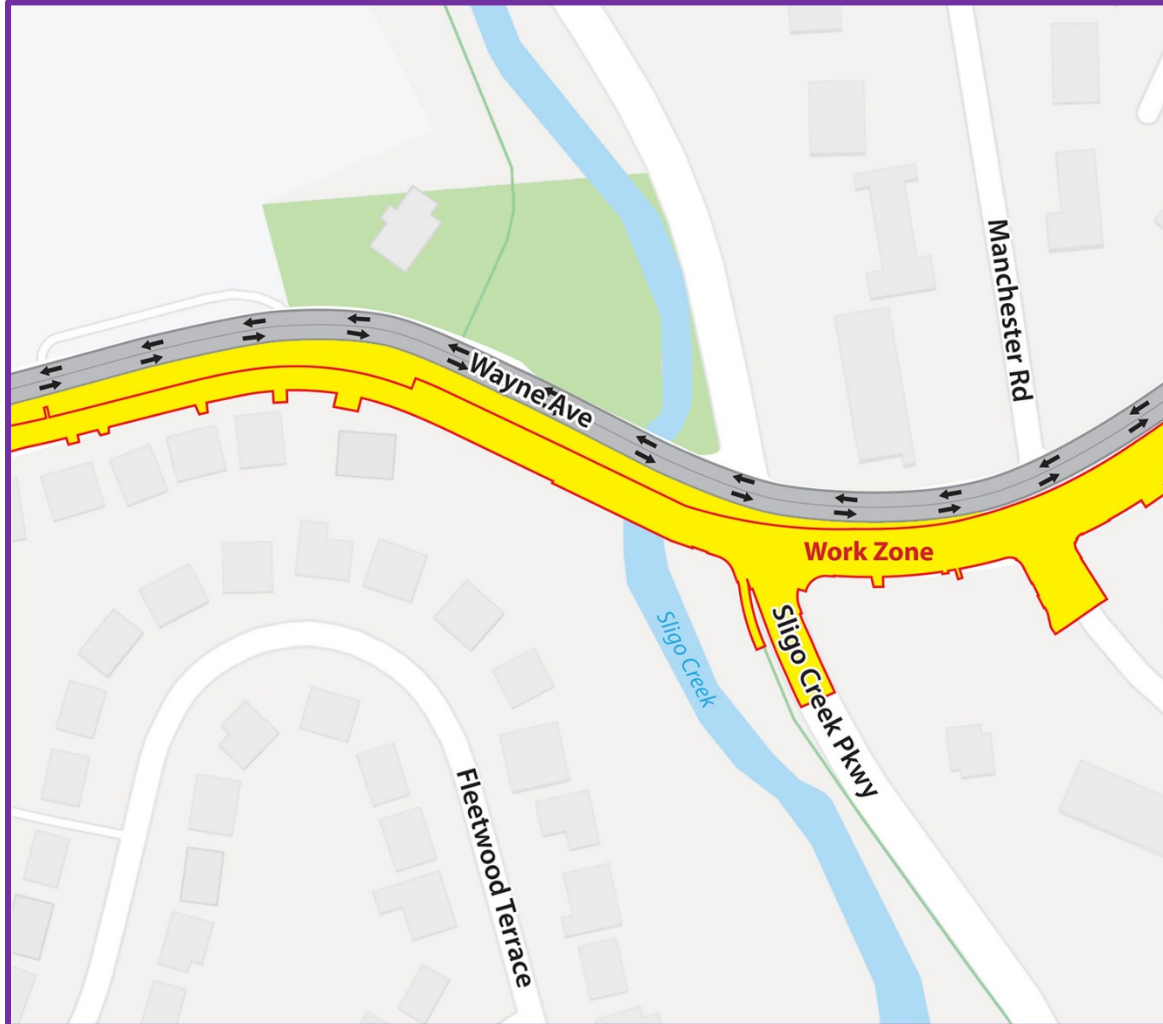

### Phase 2A – Fall 2020

- Traffic remains one lane in each direction
- Traffic is shifted to the north side of Wayne Ave.
- Access to Sligo Creek Pkwy is limited
- Second Half of the Wayne Ave. bridge constructed





## PHASING OF WAYNE AVE. OVER SLIGO CREEK

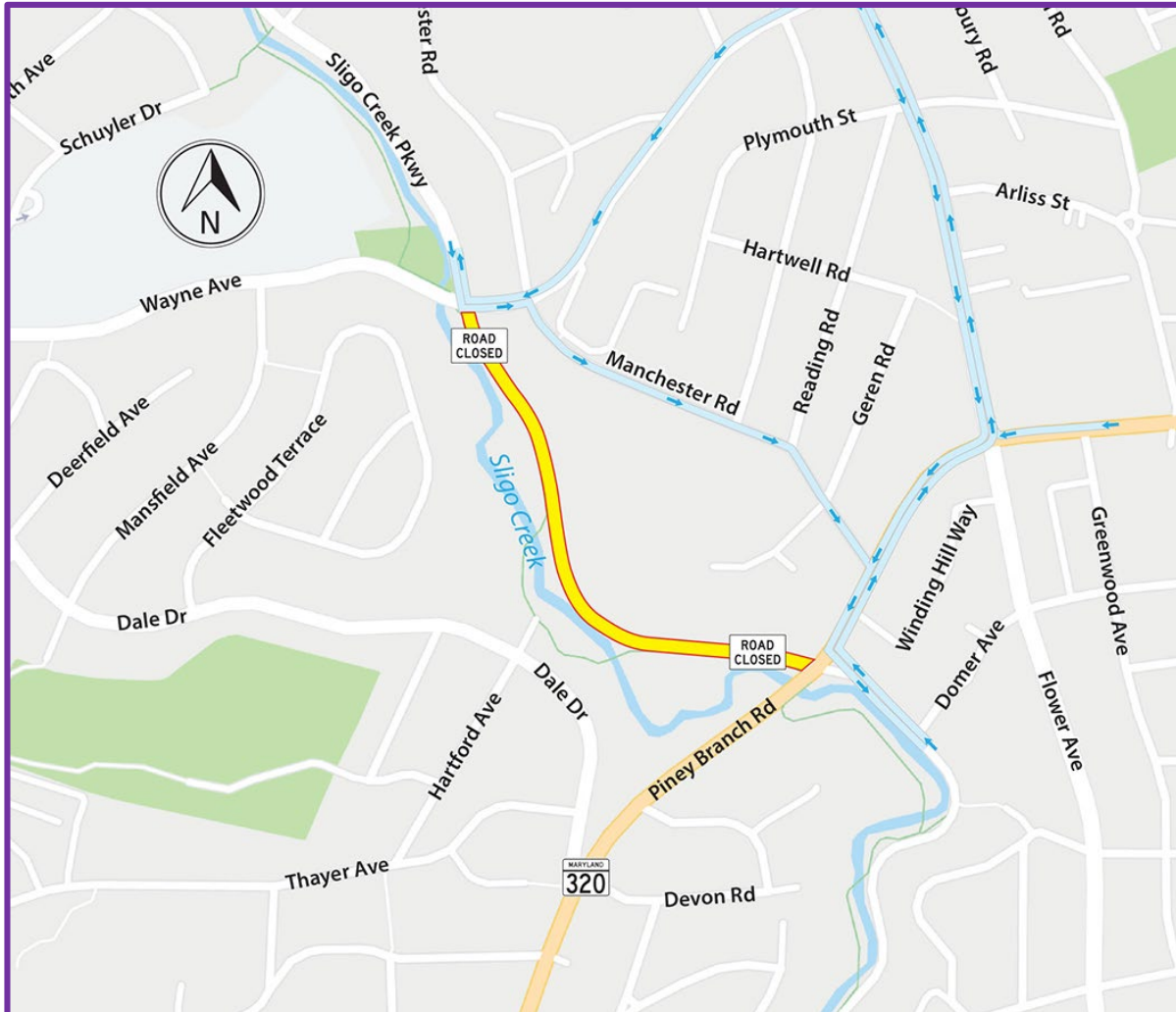

### Phase 2A – Fall 2020

- Sligo Pkwy. closed between Wayne Ave. and Piney Branch Rd.

### Detour

- From the south
  - Turn right onto Piney Branch Rd.
  - Turn left on Flower Ave.
  - Turn left on Wayne Ave.
- From the north
  - Turn left on Wayne Ave.
  - Turn right on Manchester Rd.
  - Turn right on Piney Branch Rd.



## PHASING OF WAYNE AVE. OVER SLIGO CREEK

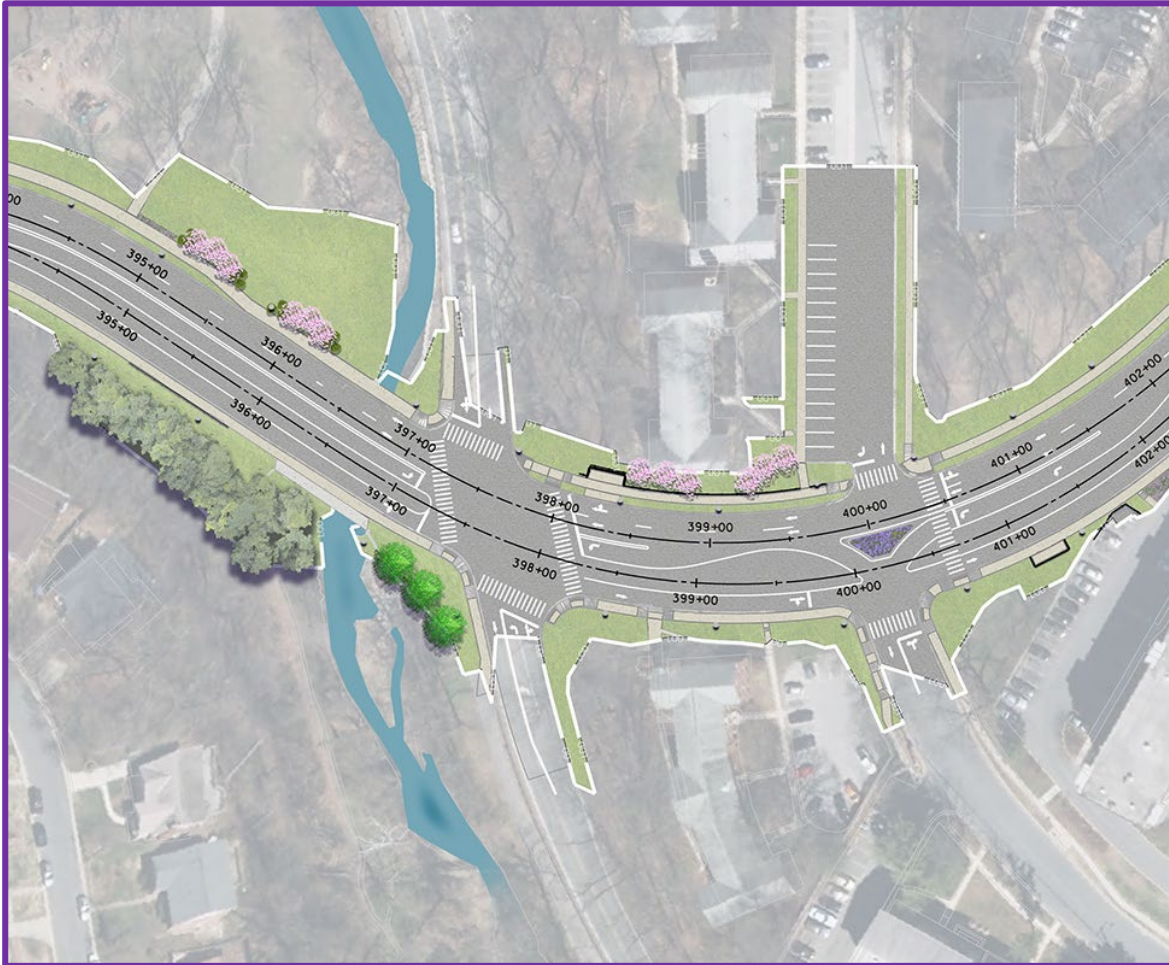

### Final Configuration

- 2 lanes in each direction
- Plus dedicated turning lane
  - Turning lanes onto Sligo Creek Pkwy.
  - Turning lanes onto Manchester Rd.

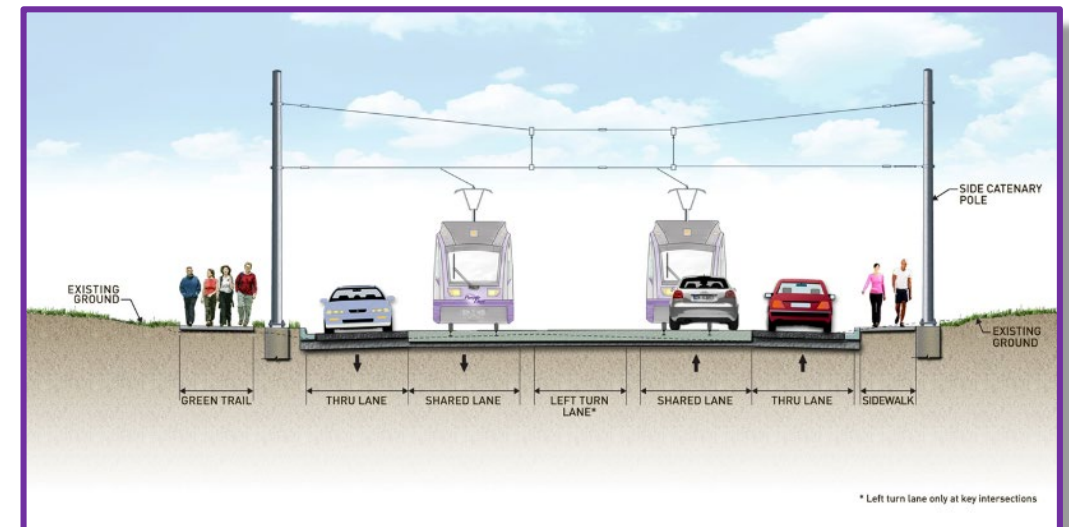





## LONG BRANCH/PLYMOUTH TUNNEL

### **Western Portal/Manchester Place Station (East Wayne Avenue)**

- Completion of concrete work Phase 1 for Manchester Place Station
- Reinstatement of Kenwood House parking lot

### **Plymouth Tunnel (East Wayne Avenue to Arliss Street)**

- Completion of waterproofing and final lining of the tunnel
- Tunnel portal construction





## LANDSCAPE/STREETSCAPE PLANS DESIGN PROCESS

- Site visit and site analysis occurred to understand existing conditions and site character prior to construction
- Based on the technical provisions, PLTC developed a plant palette for various conditions
- Design criteria/requirements set in the technical provisions and contract drawings include the following:
  - Setback requirements including, but not limited to existing and proposed utilities, track, lighting, and sightlines.



## LANDSCAPE/STREETSCAPE PLANS DESIGN PROCESS (CONTINUED)

### Planting Restriction Along the Alignment:

- **Sight lines must be maintained:** 20 feet from the edge of travel lanes, primarily at intersections
- **Utility relocations:** Utility offsets are dictated by the individual utility owners but generally require an offset within the range of 10 – 20 feet
- **Catenary wires and poles:** 20 feet from the catenary wire and/or pole
- **Light rail trackway:** 20 feet offset from the outside edge of the track
- **Limits of Disturbance:** no plantings are permitted outside of the project's limit of disturbance
- **Medians** must be greater than 6 feet in width to host any plantings





## LANDSCAPE/STREETSCAPE PLANS DESIGN PROCESS (CONTINUED)

- Planting design and layout of plant material is constantly adjusted as the roadway, civil, drainage, electrical and utility plans are advanced
- Comment Resolution Meetings were held after each submittal with MDOT, MTA, Montgomery County, Prince George's County, and the University of Maryland
  - Submittals Reviews at Preliminary, Intermediate, and Final Design Phases
  - Comments Addressed and Accepted by the reviewing agencies after each submittal
- Internal Review included:
  - PLTC
  - Interdisciplinary Reviews: Roadway, Architecture, Civil, CADD, Utilities, SWM/Drainage, Structures, Track, OCS, Safety, and any other discipline that landscape impacts



## LANDSCAPE/STREETSCAPE PLANS REVIEW PROCESS

- Review teams and external agencies included:
  - MDOT MTA
  - WMATA
  - National Park Service
  - Montgomery County DOT
  - Montgomery County Parks
  - Montgomery County Schools
  - Prince George's County
  - Prince George's County DOT
  - Prince George's Parks
  - University of Maryland





## TREE LOSS

- In working with the construction team, and through coordination with the appropriate County resource agency representatives, a Maryland-licensed tree expert confirmed which trees had to be removed
- **Only trees that present potential risk are removed:**
  - Trees that lie in the path of construction
  - Trees interfering with overhead or underground utilities
  - Trees interfering with overhead catenary system
- The licensed tree expert also identifies trees that can remain but require protection in order to survive



## FOREST MITIGATION – MARYLAND CONSERVATION ACT

- The urbanized nature of the corridor limits fully mitigating tree loss in adjacent areas
- In addition to providing landscape plantings, approximately 13 acres of revegetation will be provided along the 16-mile project corridor
- Approximately 80 acres of off-site reforestation have been purchased in Montgomery and Prince George's counties





# LANDSCAPING – SILVER SPRING



Preliminary concepts subject to change





# LANDSCAPING – WAYNE AVE.

## Legend

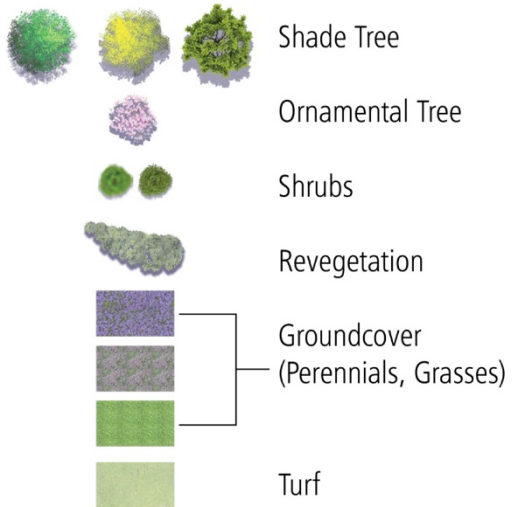

Preliminary concepts subject to change





# LANDSCAPING – WAYNE AVE. TO DALE DR. TO SLIGO CREEK

## Legend

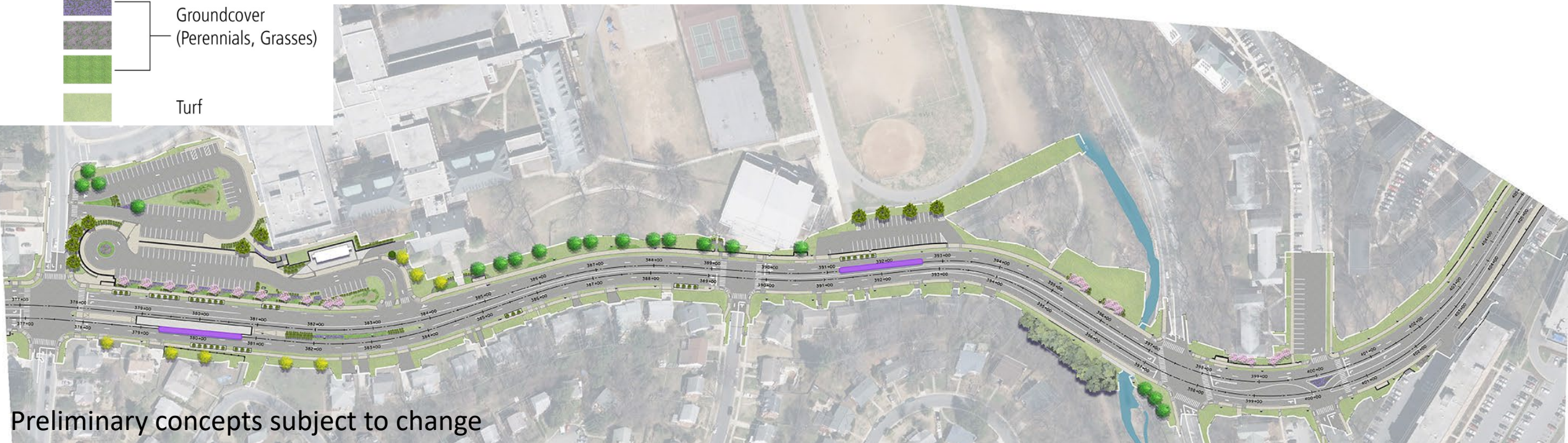
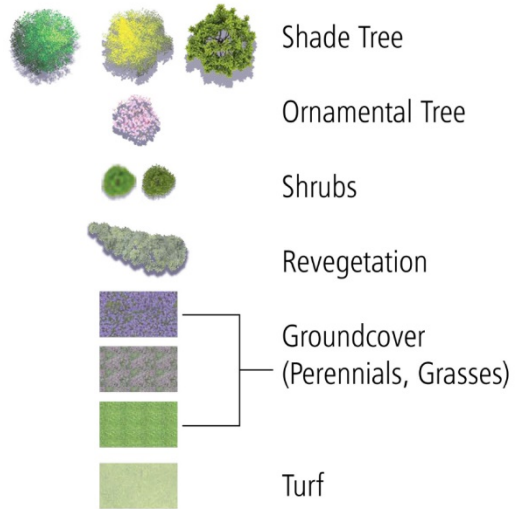

Preliminary concepts subject to change



## AMERICANS WITH DISABILITY ACT (ADA) COMPLIANCE

- Purple Line has developed concept plans for maintaining pedestrian access throughout construction and ensuring ADA accessibility is maintained
- All new facilities are being designed and built to be ADA-complaint including:
  - Curb ramps
  - Tactile warning strips on platforms edges, in front of track crossings, and crosswalks
  - PA System on platforms and LRVs to announce next trains and upcoming stations
  - Elevators and ramps at stations
- All signalized intersections will include crossings with Accessible Pedestrian Signals (APS) and Countdown Pedestrian Signals (CPS)





## UPCOMING COMMUNITY ADVISORY TEAM (CAT) MEETINGS

### Montgomery County CAT Meeting Schedule:

- Silver Spring - 10/10
- Long Branch - 10/22
- Bethesda - 10/29
- Greater Lyttonsville/Woodside -11/12



For more information on CAT Meetings please visit our website:  
[purplelinemd.com](http://purplelinemd.com).



## STAY UP TO DATE ON PURPLE LINE PROGRESS

**Sign up for construction notices at [purplelinemd.com](https://purplelinemd.com)**

- For construction-related questions and concerns, contact PLTC
  - Email: [outreach@pltcllc.com](mailto:outreach@pltcllc.com)
  - 24/7 hotline at 240-424-5325
- For general project questions and comments, contact MTA public outreach
  - Email: [outreach@purplelinemd.com](mailto:outreach@purplelinemd.com)
  - Call: 443-451-3706 or 443-451-3705 (Para Español)

