

OVERALL DETOUR PLAN

GENERAL NOTES

1. THESE DRAWINGS ARE TO BE USED IN ACCORDANCE WITH THE STATE HIGHWAY ADMINISTRATION (SHA) STANDARDS FOR HIGHWAYS, INCIDENTAL STRUCTURES, AND TRAFFIC CONTROL APPLICATIONS CATEGORY 1 AND THE MARYLAND MANUAL ON UNIFORM TRAFFIC CONTROL DEVICES (MDMUTCD).
2. NO WORK IS TO BEGIN UNTIL ALL ADVANCE WARNING SIGNS, DRUMS, ETC ARE IN PLACE AND OPERATIONAL.
3. CONSTRUCTION REQUIRING DAILY LANE CLOSURES SHALL BE COMPLETED IN ACCORDANCE WITH CATEGORY 1, PRELIMINARY SECTION 104 - MAINTENANCE OF TRAFFIC, UNLESS OTHERWISE PERMITTED BY SHA.
4. CONTRACTOR SHALL COORDINATE CONSTRUCTION WITH APPROVED TRAFFIC SIGNAL MODIFICATION PLANS.
5. PEDESTRIAN ACCESS SHALL BE MAINTAINED DURING ALL PHASES OF CONSTRUCTION EXCEPT AS SHOWN.
6. CONTRACTOR SHALL COORDINATE WITH MONTGOMERY COUNTY TRANSPORTATION MANAGEMENT CENTER (TMC) AT 240-777-2100 TWO WEEKS PRIOR TO THE ROAD CLOSURE TO ADJUST SIGNAL TIMINGS.
7. ADVANCE WARNING SIGNS SHALL BE PLACED TWO WEEKS PRIOR TO CLOSURE AND BEFORE DETOUR ROUTE IS ACTIVE.

SPECIAL NOTES

- SHEET 1: PROVIDES DETAILS FOR ROADWAY AND TURN LANE CLOSURE TO BE INSTALLED IN CONJUNCTION WITH TEMPORARY TRAFFIC SIGNAL MODIFICATION.
- SHEET 2: PROVIDES DETAILS FOR DETOUR SIGNING DURING CLOSURE OF EXECUTIVE BOULEVARD FROM OLD GEORGETOWN ROAD (MD 187) TO OLD MARANELLI ROAD.

LEGEND

	SIGN
	CHANNELIZING DEVICE (PER MOT PLAN)
	WORK AREA
	TYPE III BARRICADE (PER MOT PLAN)
	EXISTING TRAFFIC SIGNAL
	NB DETOUR ROUTE
	SB DETOUR ROUTE
	ALTERNATE ROUTE

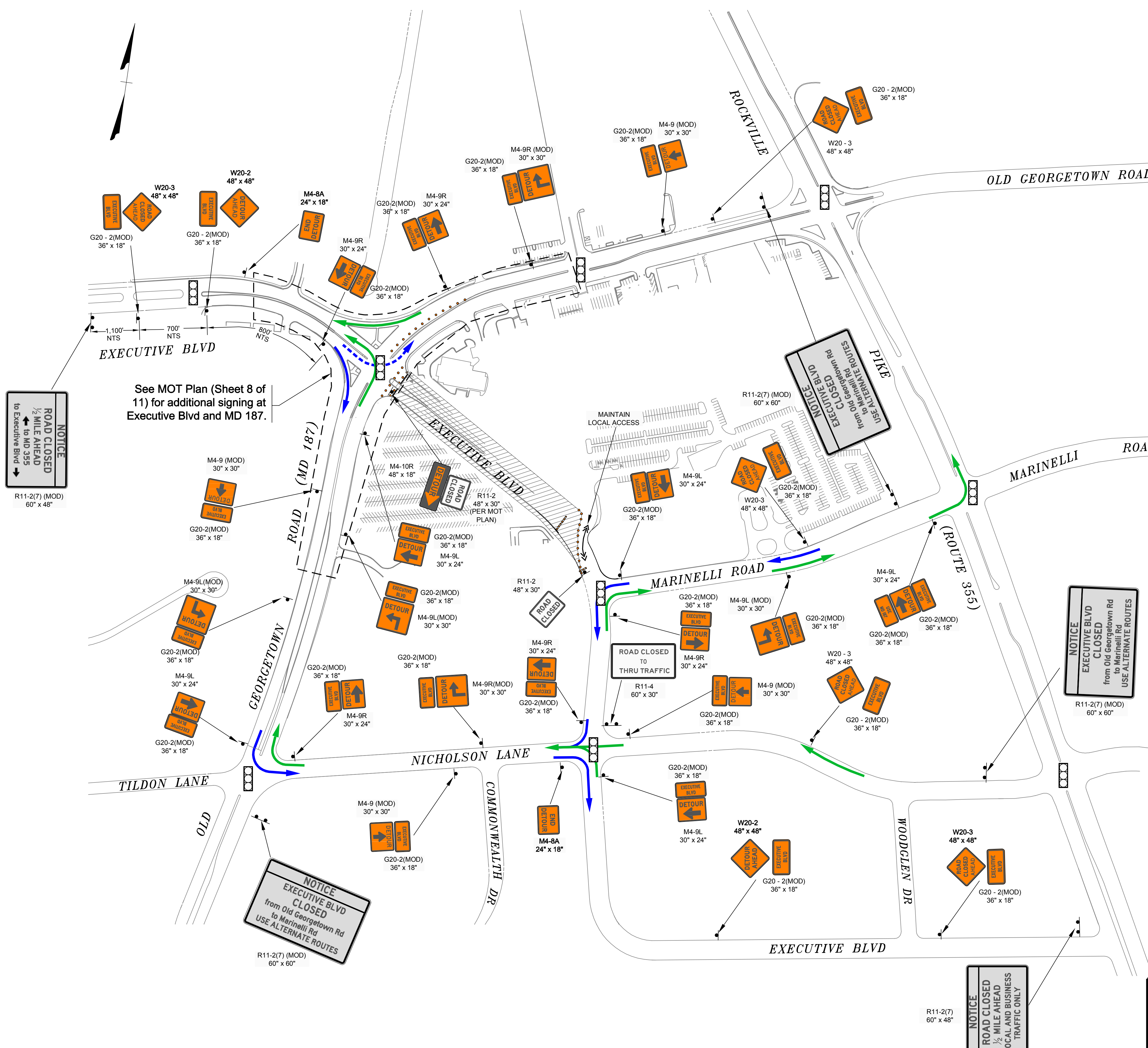

See MOT Plan (Sheet 8 of 11) for additional signing at Executive Blvd and MD 187.

Professional Engineer Seal
 STATE OF MARYLAND
 PROFESSIONAL ENGINEER
 No. 37882
 12/07/15

I HEREBY CERTIFY THAT THOSE DOCUMENTS WERE PREPARED OR APPROVED BY ME, AND THAT I AM A DULY LICENSED PROFESSIONAL ENGINEER UNDER THE LAWS OF THE STATE OF MARYLAND, LICENSE NO. 37882. EXPIRATION DATE: 10/16/2015

SHA STATE OF MARYLAND
 DEPARTMENT OF TRANSPORTATION
 STATE HIGHWAY ADMINISTRATION
 OFFICE OF TRAFFIC & SAFETY
 TRAFFIC ENGINEERING DESIGN DIVISION

EXECUTIVE BOULEVARD CLOSURE
 OLD GEORGETOWN ROAD (MD 187) to
 MARANELLI ROAD
 MONTGOMERY COUNTY, MARYLAND

DETOUR PLAN		
SCALE 1" = 150'	DATE 12/7/15	CONTRACT NO. _____
DESIGNED BY NDG/DB	COUNTY MONTGOMERY	
DRAWN BY DB	LOGMILE _____	
CHECKED BY CT	TIMS NO. _____	
F.A.P. NO. _____	TOD NO. _____	
SHEET NO. 9 OF 11		

Wells + Associates, Inc
 TRANSPORTATION, TRAFFIC AND PARKING CONSULTANTS
 210 West Street, Suite B-5, Leesburg, Virginia 20175
 Phone: 703/443-1442 Facsimile: 703/443-1223
 1420 Spring Hill Road, Suite 600, McLean, Virginia 22102
 Phone: 703/917-8820 Facsimile: 703/917-0739

PLOTTED: \$DATE\$
 FILE: \$FILE\$